

TF-1304 Series



LED Architectural Bell Step Light

Type:

Catalog Number:

Project/Location:

Approved By:

SPECIFICATIONS

Housing: Heavy-gauge of corrosion resistant formed aluminum housing.

Gasket: Closed cell silicone foam gasket. Seals out moisture, dust, and insects for weather-tight operation.

Mounting: Surface wall with supplied quick mount plate.

Lens: 1/8" thick UV stabilized lens.

Driver: Solid state electronic constant current. Input voltage 120 or 12/24 Volt only. Operating temperature -20°C to 40°C, Power Factor ≥ .90.

LED: Specify amber (A), blue (B), green (G), red (R), or 3000 (30K), 3500 (35K), 4000 (40K), and 5000 (50K) – 40K standard.

Lumens: 70.

Finish/Colors: Zinc based primer with polyester powder coat finish in Matte Black (MB), Matte White (MW), Matte Bronze (BZ), Silver Gray (SG), or a custom color (CC).

Testing: LM79, LM80, ETL.

Conforms to UL Standard 1598. Suitable for wet locations.

Options:

FLA Harsh environment finish

TF Turtle Friendly 590 nm Amber LED

LV 12 volt operation (transformer by others)

See options page for additional information or consult factory.



| Series | Source | Wattage/Max |
|---------|--------|-------------|
| TF-1304 | LED | 3W |

ORDERING EXAMPLE

TF-1304 – 3WLED – A – 120 – MB

FRONT

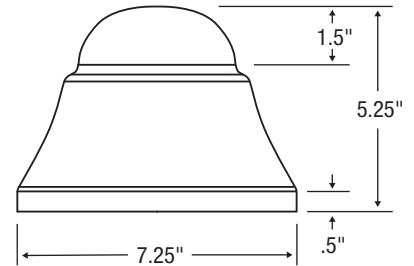

SIDE

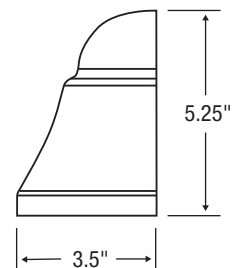

ELCAST LIGHTING

815 S. Kay Ave., Addison, IL 60101 USA • 630.543.5390
www.ElcastLtg.com • ElcastLtg@ElcastLtg.com

Made in USA – 5 year limited warranty

©2017. Specifications are subject to change without notice. Consult factory for verification.

REV 11-19