



Poplar Hall Shops

5731 Poplar Hall Drive, Norfolk, VA 23502

- Near corner of Military Highway
- 5,167 square feet
- Adjacent Retail: Arby's, Boston Market, CVS,
Ross Dress for Less, Sears

Robert R. Brown, Jr.
Director of Leasing



41 Old Oyster Point Road
Suite A
Newport News, Virginia
23602

(757) 969-6037 Direct
(757) 508-2603 Mobile
RBjr@rbainc.biz

<u>2014 Demos</u>	<u>Population</u>	<u>Households</u>	<u>Avg HH Income</u>
Drive Time:			
15 Min	536,313	208,169	\$62,757
10 Min	202,928	76,506	\$58,507
5 Min	20,766	7,674	\$59,509
Radius:			
5 Mile	295,842	115,203	\$61,589
3 Mile	99,127	37,313	\$58,515
1 Mile	8,103	3,305	\$55,059

The information supplied herein is from sources deemed reliable. It is provided without any representation, warranty or guarantee, expressed or implied, as to its accuracy. Prospective Tenants should conduct an independent investigation and verification of all matters deemed to be material.

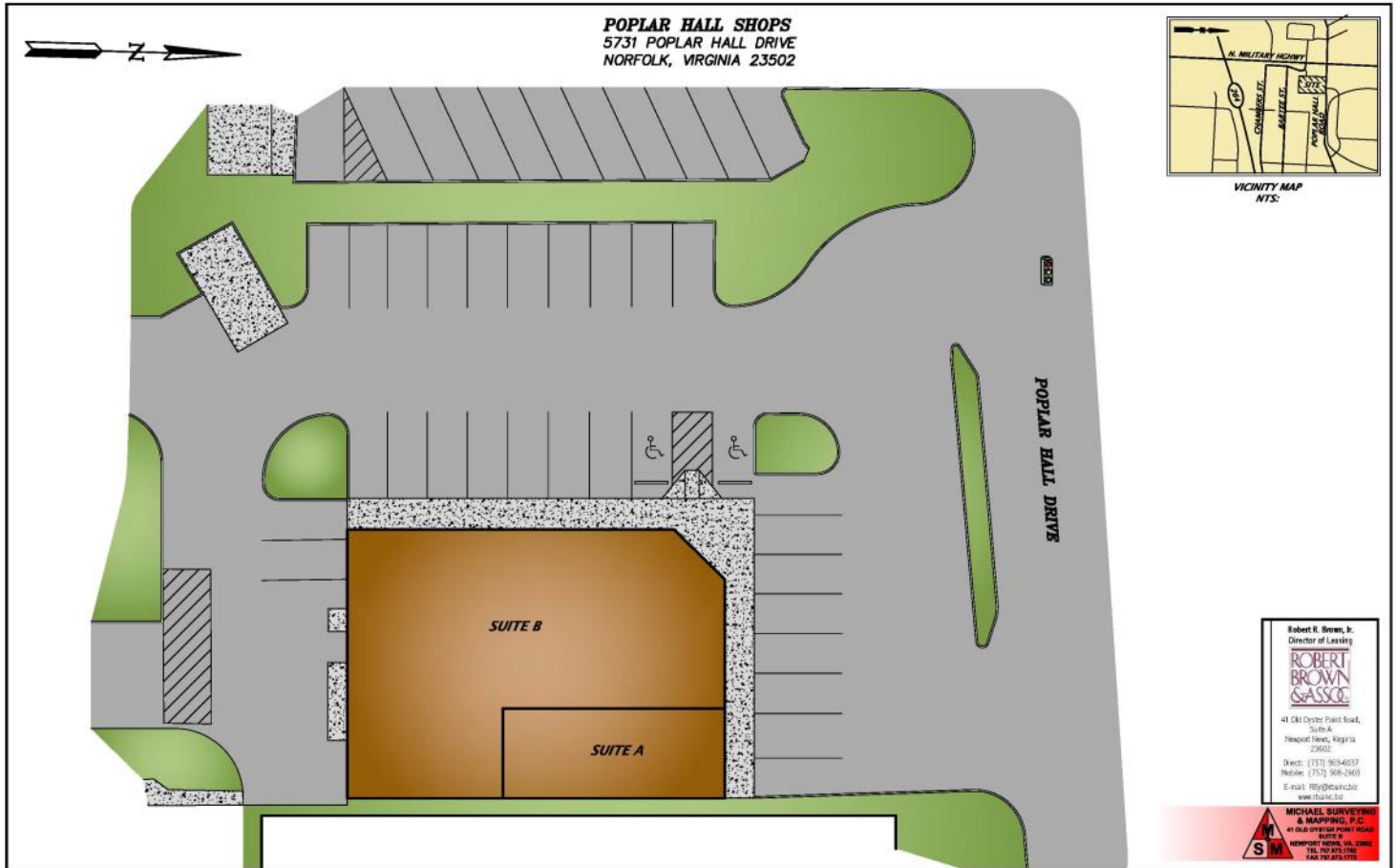

Poplar Hall Shops' Tenants

Philip Michael Fashion for Men	4,167 sf
Direct General Insurance	1,000 sf
Total GLA	5,167 sf

The information supplied herein is from sources deemed reliable. It is provided without any representation, warranty or guarantee, expressed or implied, as to its accuracy. Prospective Tenants should conduct an independent investigation and verification of all matters deemed to be material.



Poplar Hall Shops, Norfolk, VA



The information supplied herein is from sources deemed reliable. It is provided without any representation, warranty or guarantee, expressed or implied, as to its accuracy. Prospective Tenants should conduct an independent investigation and verification of all matters deemed to be material.