

QC-SV SERIES HIGH PRESSURE BALL VALVES (STEEL)

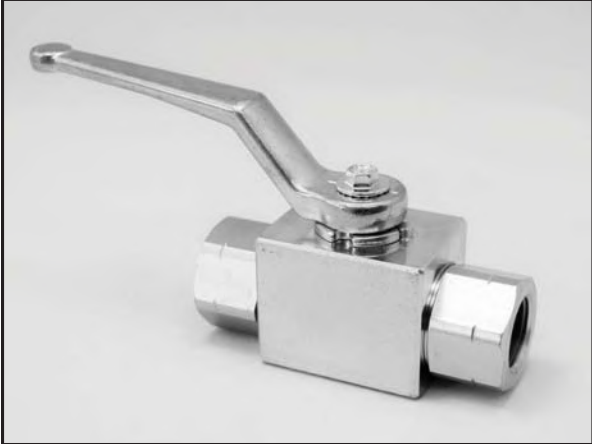

* Actuator packages available. Contact us for details.

Applications

The QC-SV Series ball valves can be used in a wide variety of applications such as:

- Construction equipment
- Agricultural
- Renewable Energies
- Offshore
- Gas industry

Features

QC-SV Series Ball Valves feature:

- Blow-out proof stems
- Full port (block body sizes 1/4" - 1")
(forged body sizes 1-1/4" - 2")
- NPT or SAE Threads
- POM (polyacetal) Seats
- Buna-N O-Rings
- Zinc Clear Plated (RoHs Compliant)

Specifications

BODY SIZE (IN)	1/4"	3/8"	1/2"	3/4" - 2"
Rated Pressure (PSI)	7350	7350	7350	6000
Temperature Range	-20°F - 215°F			
Safety Factor	2:1			

QC-SV SERIES HIGH PRESSURE BALL VALVES (STEEL)

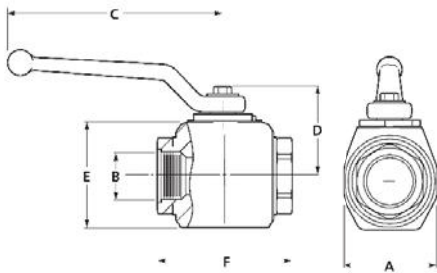
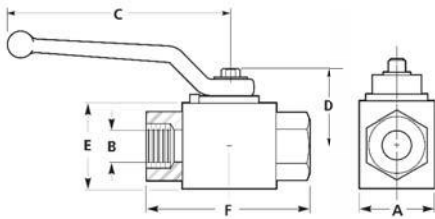

ITEM#	SIZE	PART NO.	A	B	C	D	E	F	Thread
1308	1/4"	QCSV-04-NPT	1.02	.24	4.21	1.20	1.26	2.72	1/4" NPT
1318	1/4"	QCSV-4-SAE	1.02	.24	4.21	1.20	1.26	2.72	7/16"-20 SAE
1309	3/8"	QCSV-06-NPT	1.26	.39	4.21	1.29	1.50	2.87	3/8" NPT
1319	3/8"	QCSV-6-SAE	1.26	.39	4.21	1.29	1.50	2.87	9/16"-18 SAE
1310	1/2"	QCSV-08-NPT	1.38	.51	4.21	1.31	1.57	3.62	1/2" NPT
1320	1/2"	QCSV-8-SAE	1.38	.51	4.21	1.31	1.57	3.62	3/4"-16 SAE
1311	3/4"	QCSV-12-NPT	1.93	.79	6.50	1.91	2.24	3.82	3/4" NPT
1321	3/4"	QCSV-12-SAE	1.93	.79	6.50	1.91	2.24	3.82	1-1/16"-12 SAE
1312	1"	QCSV-16-NPT	2.36	.94	6.50	1.95	2.36	4.45	1" NPT
1322	1"	QCSV-16-SAE	2.36	.94	6.50	1.95	2.36	4.45	1-5/16"-12 SAE
1313	1-1/4"	QCSV-20-NPT	2.36	.94	6.50	1.95	2.36	5.16	1-1/4" NPT
1323	1-1/4"	QCSV-20-SAE	2.36	.94	6.50	1.95	2.36	5.16	1-5/8"-12 SAE
1314	1-1/2"	QCSV-24-NPT	2.36	.94	6.50	1.95	2.36	5.47	1-1/2" NPT
1324	1-1/2"	QCSV-24-SAE	2.36	.94	6.50	1.95	2.36	5.47	1-7/8"-12 SAE

DIMENSIONS IN INCHES
* Reduced to 1" Port

ITEM#	SIZE	PART NO.	A	B	C	D	E	F	Thread
1315	1-1/4"	QCSV-20-NPT-FP	2.99	1.26	8.30	2.10	3.30	4.50	1-1/4" NPT
1325	1-1/4"	QCSV-20-SAE-FP	2.99	1.26	8.30	2.10	3.30	4.50	1-5/8"-12 SAE
1316	1-1/2"	QCSV-24-NPT-FP	3.27	1.50	8.30	2.73	3.62	5.30	1-1/2" NPT
1326	1-1/2"	QCSV-24-SAE-FP	3.27	1.50	8.30	2.73	3.62	5.30	1-7/8"-12 SAE
1317	2"	QCSV-32-NPT-FP	3.94	1.89	8.50	3.15	4.37	5.50	2" NPT
1327	2"	QCSV-32-SAE-FP	3.94	1.89	8.50	3.15	4.37	5.50	2-1/2"-12 SAE

DIMENSIONS IN INCHES

Locking Kits

ITEM#	PART NO.
1340	QCLK-1 (Fits 1/4"-1/2" QCSV Valves)
1341	QCLK-2 (Fits 3/4"-1-1/2" QCSV Valves*)
1342	QCLK-3 (Fits 1-1/4"-2" QCSV Full Port Valves)

* 1-1/4" - 1-1/2" Reduced Port