

Existing window to remain

Existing stone sill to remain

Pntd. TL-17 Ogee and blocking around 3 sides of lift shaft at height of side wall. Verify with manuf.

Genesis Shaftway on/off same side standard platform size hydraulic drive system lift by Garaventa Lifts. Provide in custom color, as selected by Architect.

Maintain existing heat

3'-7" side wall height. Verify with manuf. Install pntd. GWB finish to existing wood screen and cap with pntd. TL-17 pntd. ogee mdg. Verify final lift side wall height and set ogee accordingly. Existing stone base. Shim GWB to align with stone base. Paint all to blend.

Remove existing floor as required for new shaft

Shim 5/8" pntd. GWB finish to existing stone wall at new shaft. Cap with pntd. TL-17 pntd. ogee mdg. Verify final lift side wall height and set cap accordingly.

New shaft wall: 3 5/8" metal studs with 5/8" pntd. GWB each side.

Mast with optional full cap

3'-3" platform width

4'-8 3/8" shaftway width. Verify with manufacturer

Pit depth

Install new 12" thick pad at base of lift with #5's @ 12" o.c. bottom, each way. Provide 3" deep pit, as required by manuf.

1 VERTICAL LIFT SHAFT DETAIL
A-2 scale: 1" = 1'-0"

Extend 6" past all sides, where existing foundation allows.

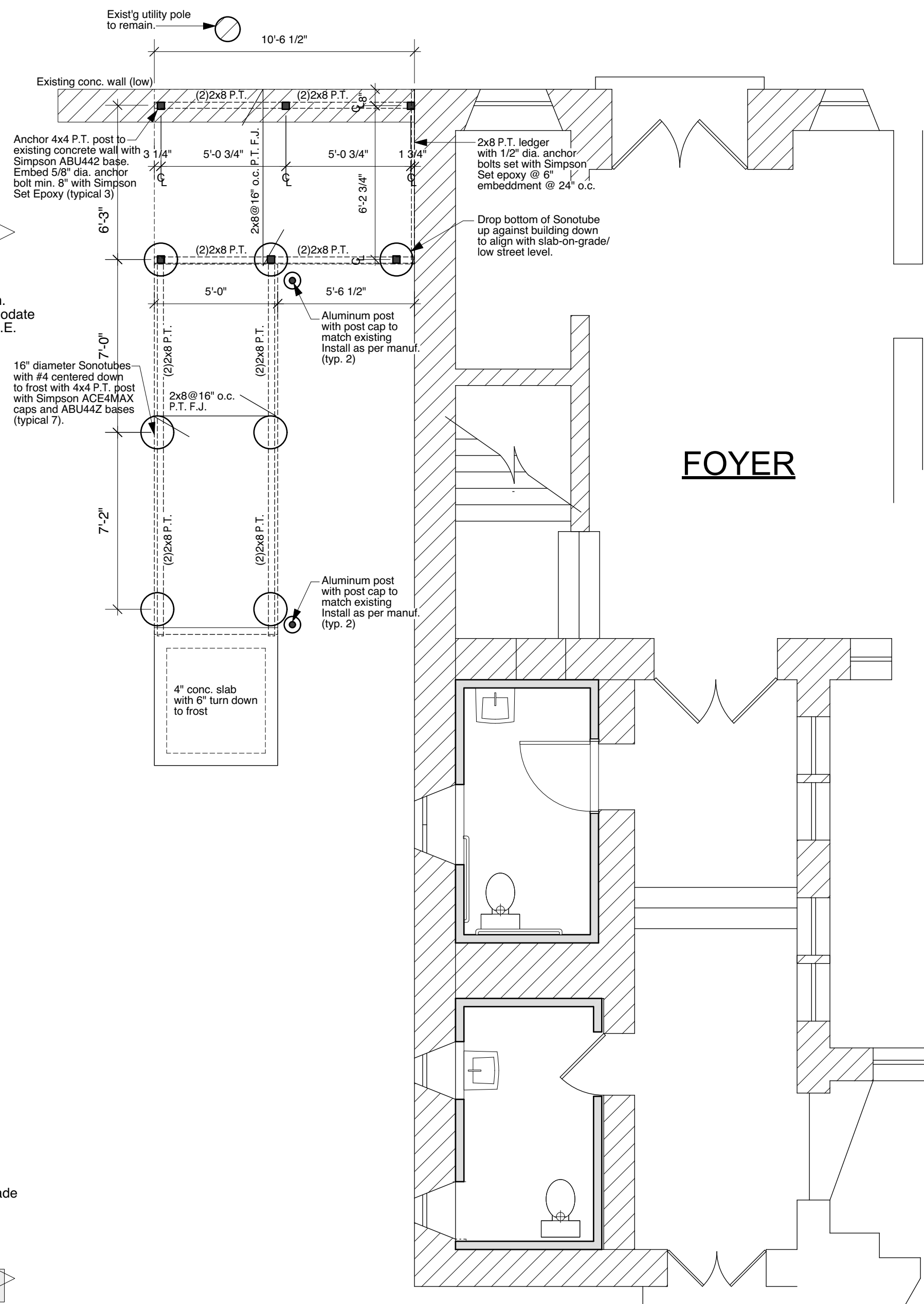

PRICING OPTION #1
4 NEW RAMP FOUNDATION PLAN
A-2 scale: 1/4" = 1'-0"

FOYER

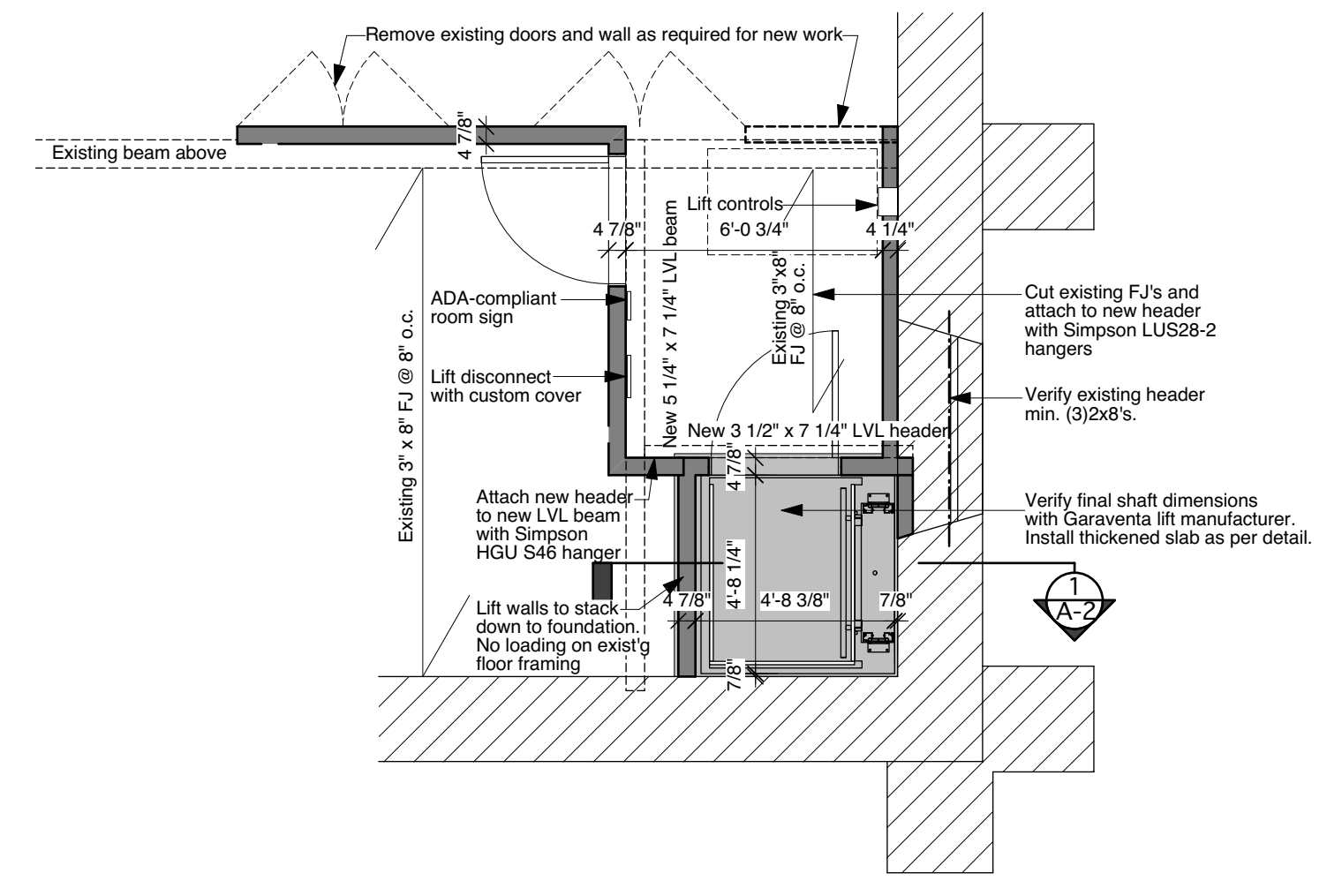

2 VERTICAL LIFT FOUNDATION PLAN
A-2 scale: 1/4" = 1'-0"

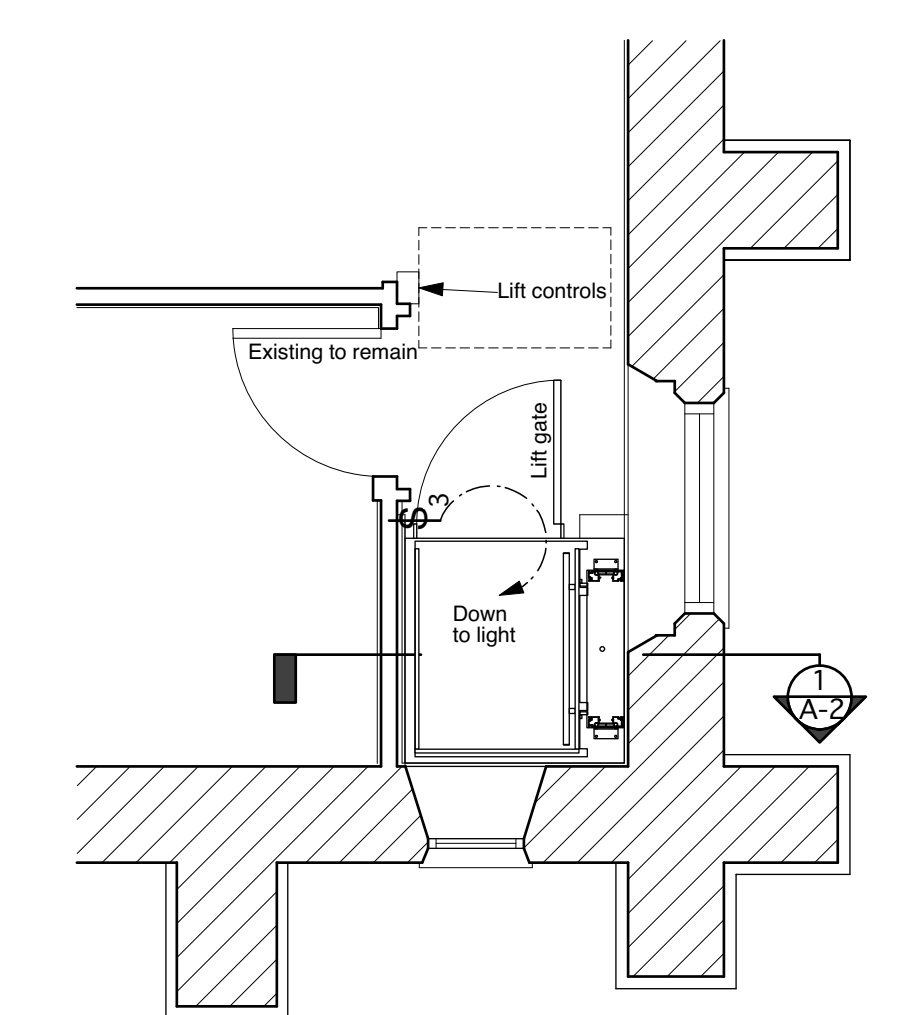

3 VERTICAL LIFT FIRST FLOOR PLAN
A-2 scale: 1/4" = 1'-0"

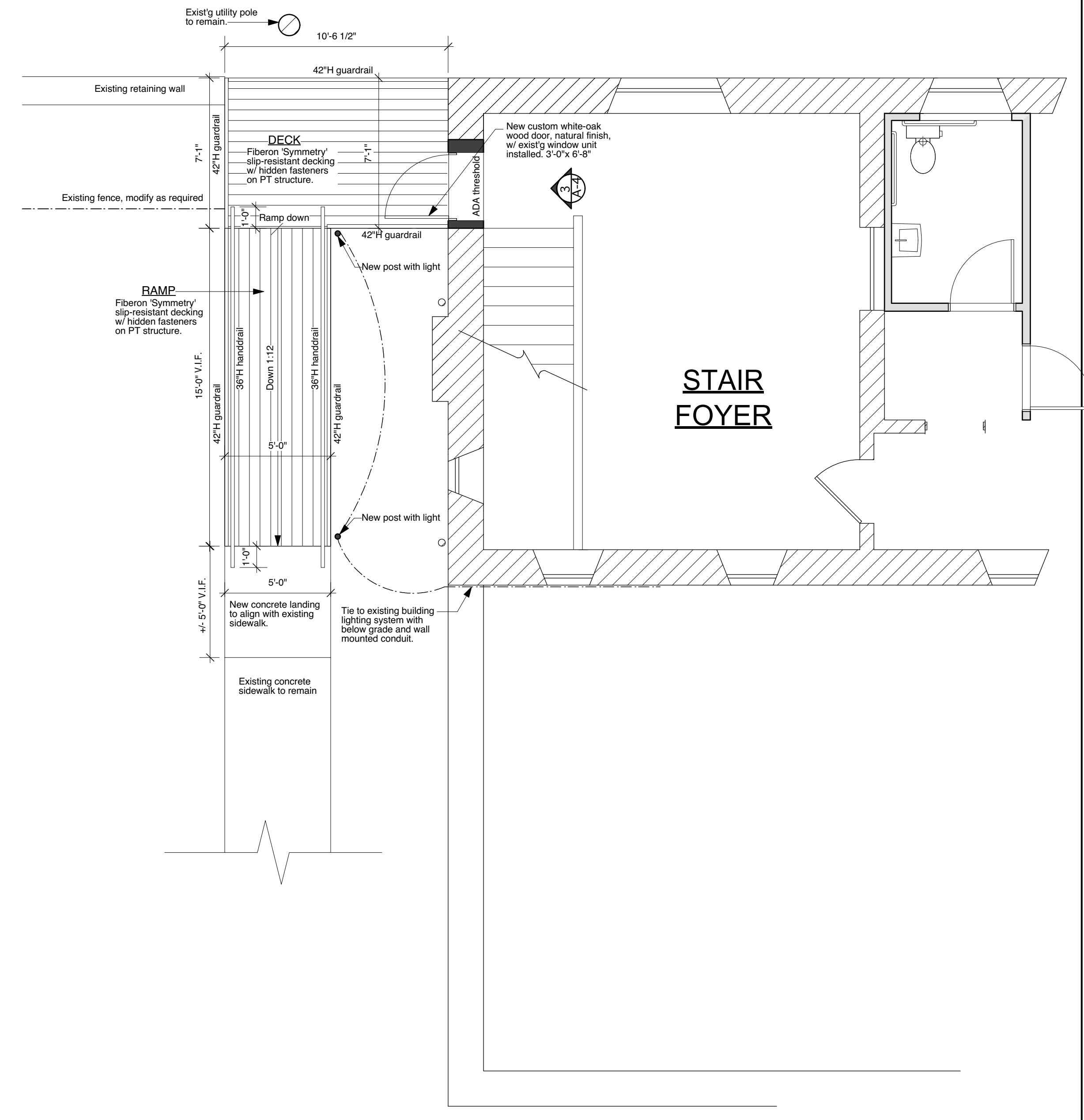

PRICING OPTION #1
5 NEW RAMP FLOOR PLAN
A-2 scale: 1/4" = 1'-0"

STAIR FOYER

CARNEVALE EUSTIS ARCHITECTS, INC. RESERVES ITS COMMON LAW COPYRIGHT AND OTHER PROPERTY RIGHTS IN THESE DOCUMENTS. THESE DOCUMENTS ARE NOT TO BE REPRODUCED, CHANGED OR COPIED IN ANY MANNER NOR ARE THEY TO BE ASSIGNED TO A THIRD PARTY WITHOUT FIRST OBTAINING THE WRITTEN PERMISSION AND CONSENT OF CARNEVALE EUSTIS ARCHITECTS, INC. FOR REVIEW PRIOR TO FABRICATION.

ACCESSIBILITY IMPROVEMENTS FOR:
St. Peter's Episcopal Church
 121 Church Street, Phoenixville, Chester County, Pennsylvania
 www.cearhitects.com

Carnevale Eustis Architects, Inc.
 181 Bridge Street, Phoenixville, PA 19460
 phone (610) 933-0197 fax (610) 935-3600

Drawing No. 2 of 5
A-2
 Date: Dec. 6, 2018
 Scale: as noted