

S.R. 0125 (TREMONT ROAD) OVER SWATARA CREEK TREMONT TOWNSHIP

SR 0125 SURVEY & CONSTR

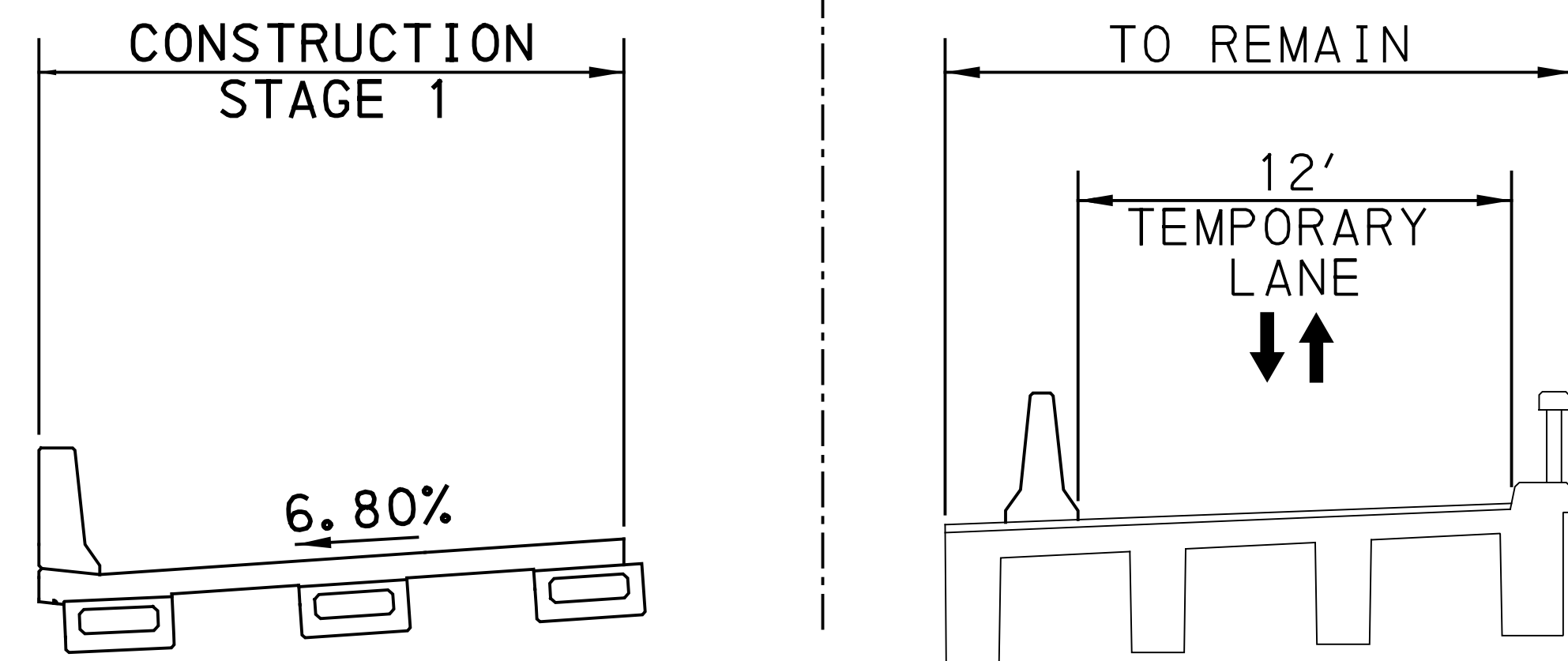

STAGE 1 CONSTRUCTION

SR 0125 SURVEY & CONSTR

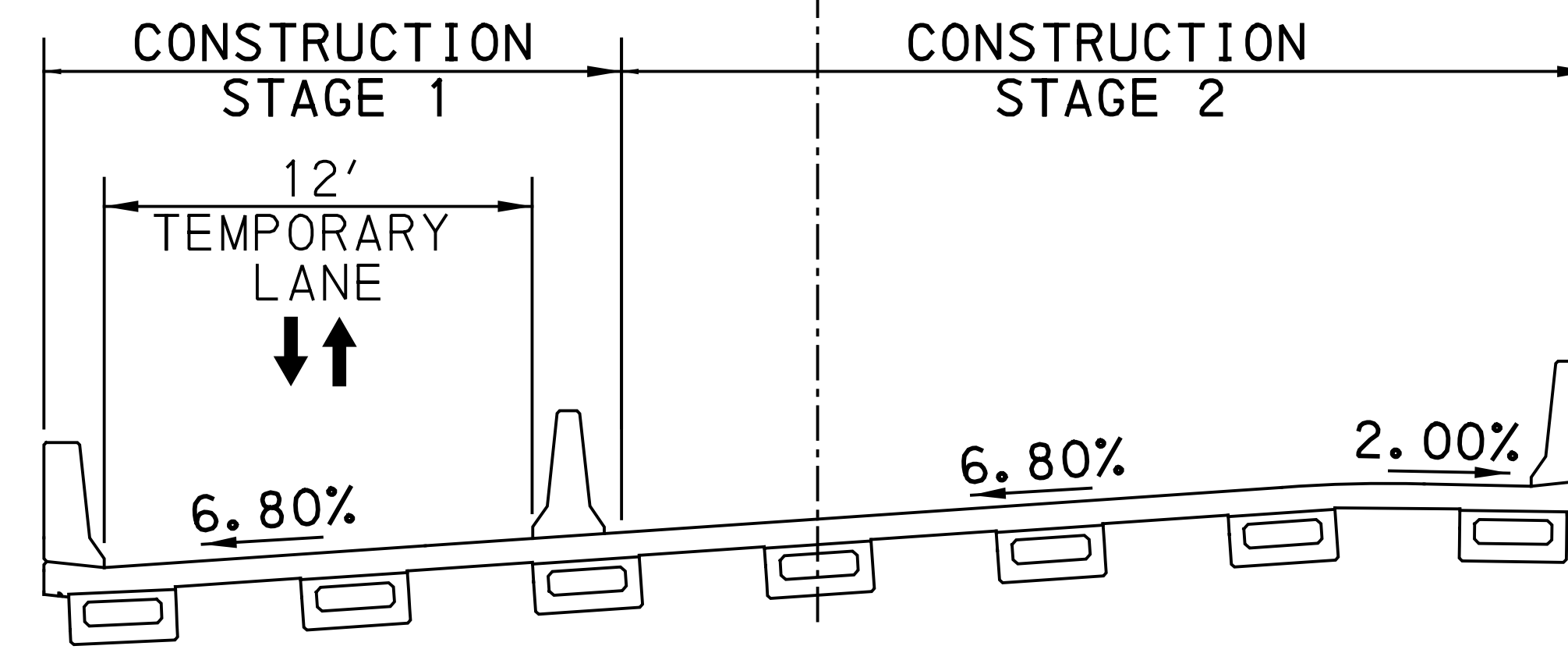

STAGE 2 CONSTRUCTION

SR 0125 SURVEY & CONSTR

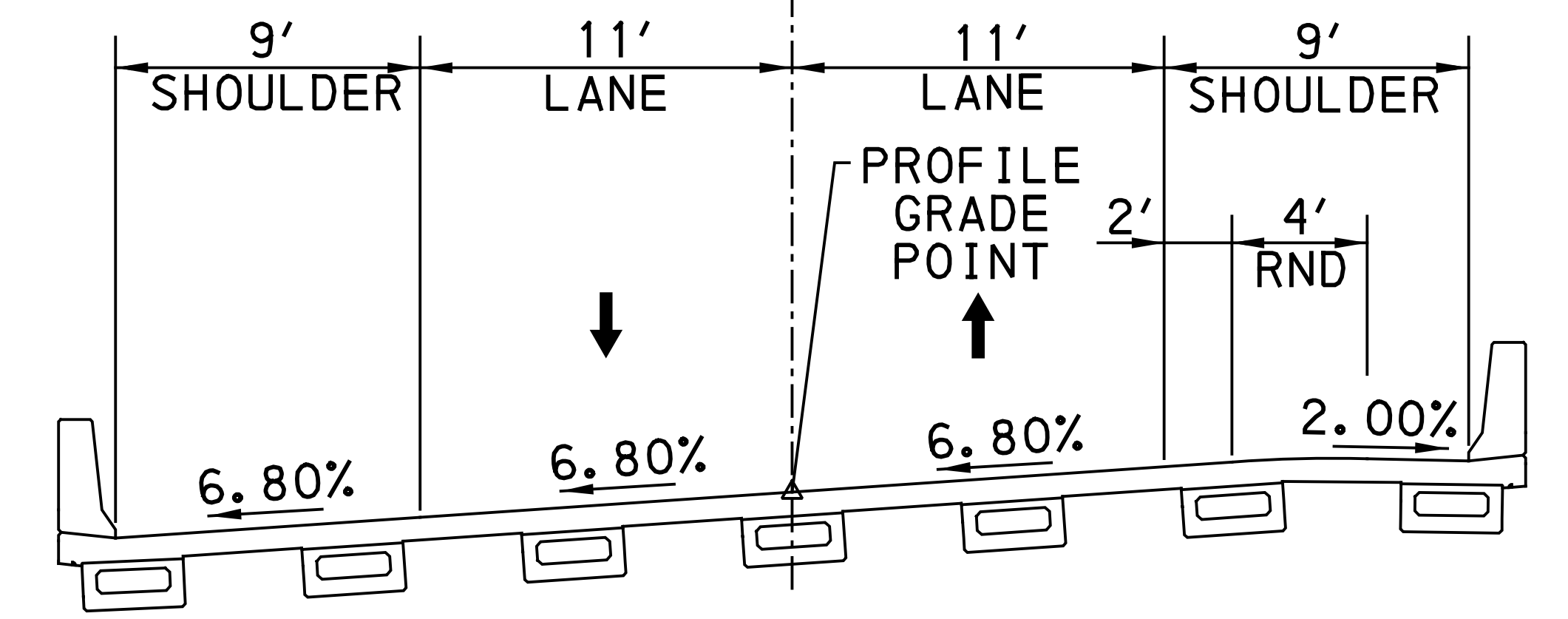

SR 0125 NORMAL SECTION (STRUCTURE)

TRAFFIC WILL BE MAINTAINED IN SINGLE LANE ALTERNATING PATTERN USING TEMPORARY SIGNALS DURING CONSTRUCTION

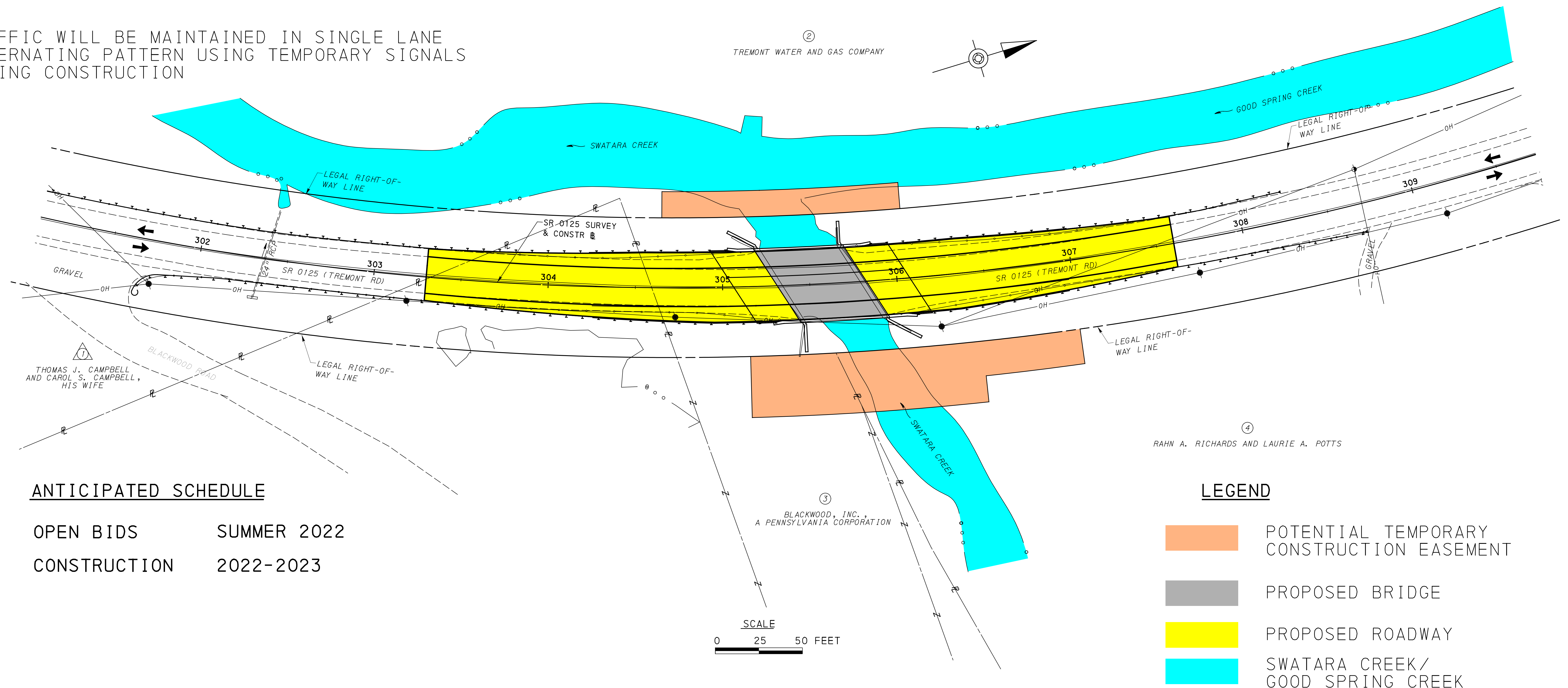

ANTICIPATED SCHEDULE

OPEN BIDS	SUMMER 2022
CONSTRUCTION	2022-2023

**PROJECT PLAN
MAY 2020**

PREPARED BY:



DATE: 4/27/2020 FILE: G:\working\101501\101501.dwg