

# SAMPLE BALLOT PAPELETA DE MUESTRA

Office Oficina	1 Presidential Electors for President and Vice President Electores Presidenciales para Presidente y Vicepresidente (Vote for one) - (Vote por uno)	2 State Supreme Court Justice Juez de la Corte Suprema del Estado 9th Judicial District - 9no Distrito Judicial (Vote for up to four) - (Vote por cuatro máximo)	3 Democratic	4 Democratic	5 Democratic	6 Democratic	7 Democratic	8 Democratic	9 Democratic	10 Democratic	11 Democratic	12 Democratic	13 Democratic
Democratic A	<input type="radio"/> 1 Elector For Joseph R. Biden For President Kamala D. Harris For Vice President	<input type="radio"/> 2 E. Loren Williams	<input type="radio"/> 3 Alexandra D. Murphy	<input type="radio"/> 4 Robert S. Ondrovic	<input type="radio"/> 5 Sam D. Walker	<input type="radio"/> 6 Sean Patrick Maloney	<input type="radio"/> 7 James G. Skoufis	<input type="radio"/> 8 Sarita Bhandarkar	<input type="radio"/> 9 Paul Trachte	<input type="radio"/> 10 Maria Patrizio			
Republican B	<input type="radio"/> 1 Elector For Donald J. Trump For President Michael R. Pence For Vice President	<input type="radio"/> 2 Richard J. Guertin	<input type="radio"/> 3 Mark T. Starkman	<input type="radio"/> 4 David V. Hasin	<input type="radio"/> 5 Sam D. Walker	<input type="radio"/> 6 Chele C. Farley	<input type="radio"/> 7 Steve Brescia	<input type="radio"/> 8 Colin J. Schmitt	<input type="radio"/> 9 Hyun Chin Kim	<input type="radio"/> 10 Carol S. Klein	<input type="radio"/> 11 Janet M. Haislip		
Conservative C	<input type="radio"/> 1 Elector For Donald J. Trump For President Michael R. Pence For Vice President	<input type="radio"/> 2 Richard J. Guertin	<input type="radio"/> 3 Alexandra D. Murphy	<input type="radio"/> 4 Robert S. Ondrovic	<input type="radio"/> 5 Sam D. Walker	<input type="radio"/> 6 Chele C. Farley	<input type="radio"/> 7 Steve Brescia	<input type="radio"/> 8 Colin J. Schmitt	<input type="radio"/> 9 Hyun Chin Kim	<input type="radio"/> 10 Carol S. Klein	<input type="radio"/> 11 Janet M. Haislip		
Working Families D	<input type="radio"/> 1 Elector For Joseph R. Biden For President Kamala D. Harris For Vice President					<input type="radio"/> 6 Sean Patrick Maloney	<input type="radio"/> 7 James G. Skoufis	<input type="radio"/> 8 Sarita Bhandarkar	<input type="radio"/> 9 Hyun Chin Kim	<input type="radio"/> 10 Maria Patrizio			
Green E	<input type="radio"/> 1 Elector For Howie Hawkins For President Angela Nicole Walker For Vice President								<input type="radio"/> 9 Hyun Chin Kim	<input type="radio"/> 10 Maria Patrizio			
Libertarian F	<input type="radio"/> 1 Elector For Jo Jorgensen For President Jeremy Cohen For Vice President					<input type="radio"/> 6 Scott A. Smith		<input type="radio"/> 8 Colin J. Schmitt	<input type="radio"/> 9 Hyun Chin Kim	<input type="radio"/> 10 Carol S. Klein			
Independence G	<input type="radio"/> 1 Elector For Brock Pierce For President Karla Ballard For Vice President					<input type="radio"/> 6 Sean Patrick Maloney		<input type="radio"/> 8 Colin J. Schmitt	<input type="radio"/> 9 Hyun Chin Kim	<input type="radio"/> 10 Maria Patrizio	<input type="radio"/> 11 Janet M. Haislip		
Sam H						<input type="radio"/> 6 Scott A. Smith	<input type="radio"/> 7 James G. Skoufis	<input type="radio"/> 8 Colin J. Schmitt	<input type="radio"/> 9 Paul Trachte	<input type="radio"/> 10 Carol S. Klein			
Community First I											<input type="radio"/> 12 Christopher J. Battiato	<input type="radio"/> 13 Elizabeth A. Reilly	
Write-In Por-Escrito	Write-In Por-Escrito	Write-In Por-Escrito	Write-In Por-Escrito	Write-In Por-Escrito	Write-In Por-Escrito	Write-In Por-Escrito	Write-In Por-Escrito	Write-In Por-Escrito	Write-In Por-Escrito	Write-In Por-Escrito	Write-In Por-Escrito	Write-In Por-Escrito	Write-In Por-Escrito

## ORANGE COUNTY GENERAL ELECTION NOVEMBER 3, 2020

## CONDADO DE ORANGE ELECCIÓN GENERAL 3 DE NOVIEMBRE 2020

### SHEET # 8

4 Election Districts  
County of Orange  
**18th Congressional District**  
**39th Senatorial District**  
**99th Assembly District**  
Town of: Chester  
Village of: Chester  
E.D.(s): 1, 2, 8, 9

### INSTRUCTIONS:

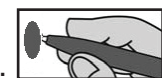

1. Mark the oval  to the left of the name of your choice.
2. To vote for a candidate whose name is not printed on the ballot, Print the name clearly in the box labeled write-in, staying within the box.
3. Any mark or writing outside the spaces provided for voting may void the entire ballot. The number of choices is listed for each contest.
4. Do not mark the ballot for more candidates than allowed. If you do, your vote in that contest will not count. If you make a mistake, or want to change your vote, ask a poll worker for a new ballot.

### INSTRUCCIONES:

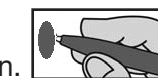

1. Marque el óvalo  a la izquierda del nombre de su elección.
2. Para votar por un candidato cuyo nombre no está impreso en la boleta, escriba el nombre claramente en el recuadro etiquetado como por-escrito, permaneciendo dentro del recuadro.
3. Cualquier marca o escritura fuera de los espacios previstos para la votación puede anular toda la boleta. El número de opciones se enumera para cada contienda.
4. No marque en la boleta más candidatos de los permitidos. Si lo hace, su voto en esa contienda no contará. Si comete un error o desea cambiar su voto, pídale a un trabajador electoral una nueva boleta.