

Project:	Type:
Date:	Comments:

GENERAL: Indoor Architectural LED Fixture. Pendant, Surface Mount, Recessed and Wall Mounted installation.

LED: Samsung LED Chips, 2700-5000K, Dynamic White and RGBW Available, 80CRI (90 optional)

OPTICAL: Direct & Direct/Indirect Configurations, 110° Beam Angle

CONSTRUCTION: High Grade Aluminum Extrusion 3.7 x 3.9", Die Cast End Caps, PMMA Diffuser, Integral Driver, Powder Coat Finish. X, T, L Lit Corners Available for Smooth, Seamless Patterns

\* 5-year warranty, 50,000 hour rated lifespan, IP40 (indoor). Custom size, lumen output and color temperature available.



Model #	Length	Wattage	Distribution	Lumen Output
TechoLED-BX-4-D-2-18-30-U-D	2 ft	18W	Direct	1800lm
TechoLED-BX-4-D-4-36-30-U-D	4 ft	36W	Direct	3600lm
TechoLED-BX-4-D-6-54-30-U-D	6 ft	54W	Direct	5400lm
TechoLED-BX-4-D-8-72-30-U-D	8 ft	72W	Direct	7200lm
TechoLED-BX-4-DI-2-27-30-U-D	2 ft	27W	Direct/Indirect	2700lm
TechoLED-BX-4-DI-4-54-30-U-D	4 ft	54W	Direct/Indirect	5400lm
TechoLED-BX-4-DI-6-81-30-U-D	6 ft	81W	Direct/Indirect	8100lm
TechoLED-BX-4-DI-8-108-30-U-D	8 ft	108W	Direct/Indirect	10800lm

### Ordering Guide

1-FIXTURE ID	2-DISTRIBUTION	3-LENGTH	4-WATTAGE	5-COLOR TEMPERATURE	6-VOLTAGE	7-FINISH	8-MOUNTING	9-DRIVER OPTIONS	10-OPTIONS	11-OPTIONS (CONT.)
BX-4	D - Direct DI - Direct/Indirect	2 - 2ft 4 - 4ft 6 - 6ft 8 - 8ft C - Custom	Direct 18 - 18W 36 - 36W 54 - 54W 72 - 72W  Direct/Indirect 27 - 27W 54 - 54W 81 - 81W 108 - 108 W C - Custom Wattage/ Lumen Output	27 - 2700K 30 - 3000K 35 - 3500K 40 - 4000K 50 - 5000K D - Dynamic/Tunable White DT - Lutron Digital T-Series Dynamic/Tunable white driver RGB - RGB RGBW - RGBW	U - Universal 110-277V HV - 347V	S - Silver W - White B - Black C - C (RAL#)	P - Pendant R - Recessed S - Surface Mount TG - Recessed in T Grid Ceiling W - Wall Mounted	D - 0-10V Dimming DA - Dali LDE1 - Lutron Hi-lume 1% EcoSystem, Soft-on, Fade- to-Black dimming	DFCSJ-OEM-RF - Lutron Vive In-Fixture control (RF only) FCJ/FCJS-ECO - Lutron wireless PowPak (EcoSys- tem) FCJ/FCJS-010 - Lutron RF PowPak (0-10V) DFCSJ-OEM-OCC - Lutron Vive In-Fixture control (with daylight & occ/vac sensors)	EM - Emergency Battery Backup (remote) M - Motion Sensor (remote) BM - Bluetooth Mesh Smart Wireless Control by BubblyNet

Project:	Type:
Date:	Comments:

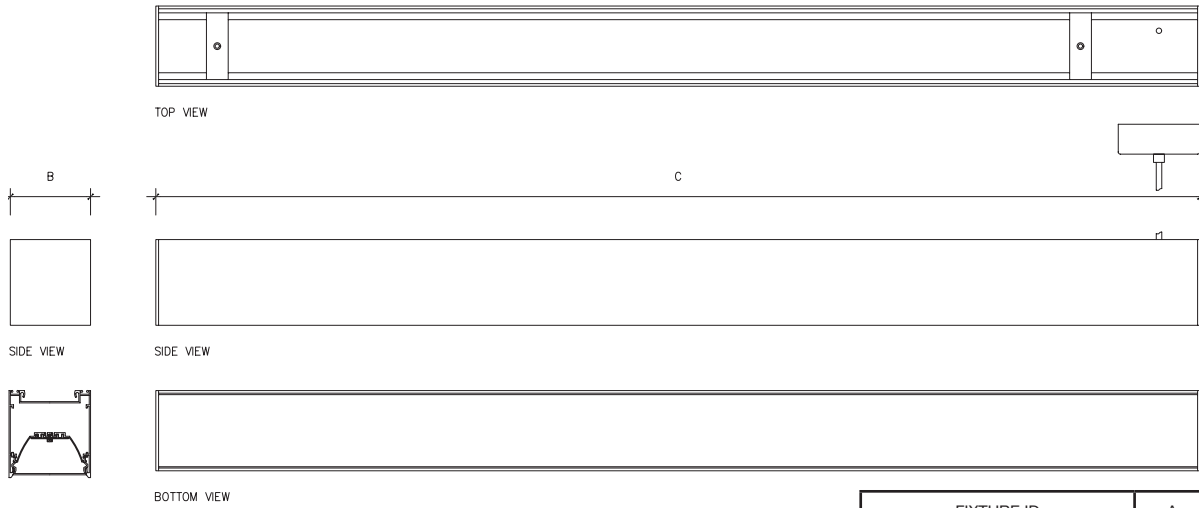

FIXTURE ID	A	B	C
TechoLED-BX-4-DI-2-27-30-U-M	3.7"	3.9"	24"
TechoLED-BX-4-DI-4-54-30-U-M	3.7"	3.9"	48"
TechoLED-BX-4-DI-6-81-30-U-M	3.7"	3.9"	72"
TechoLED-BX-4-DI-8-108-30-U-M	3.7"	3.9"	96"

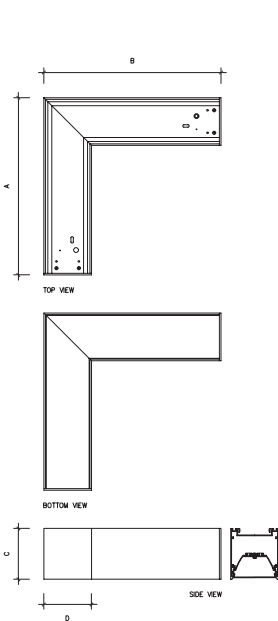

**BX-4-L Connector**

A	12"
B	12"
C	3.9"
D	3.7"

Not to scale

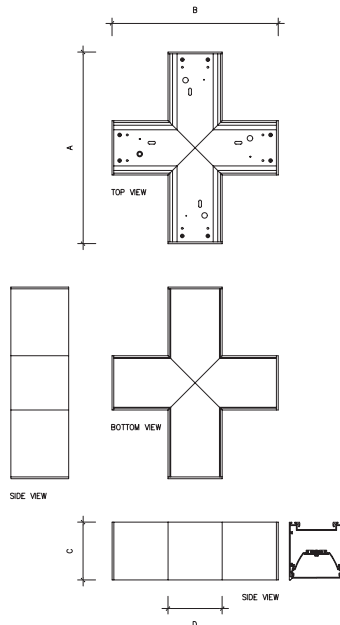

**BX-4-X Connector**

A	12"
B	12"
C	3.9"
D	3.7"

Not to scale

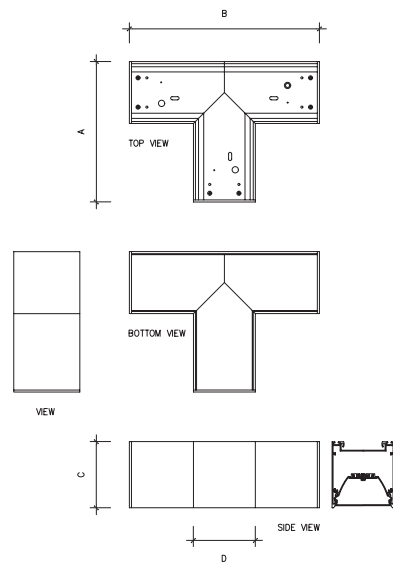

**BX-4-T Connector**

A	12"
B	12"
C	3.9"
D	3.7"

Not to scale

Project:	Type:
Date:	Comments:

### Photometrics

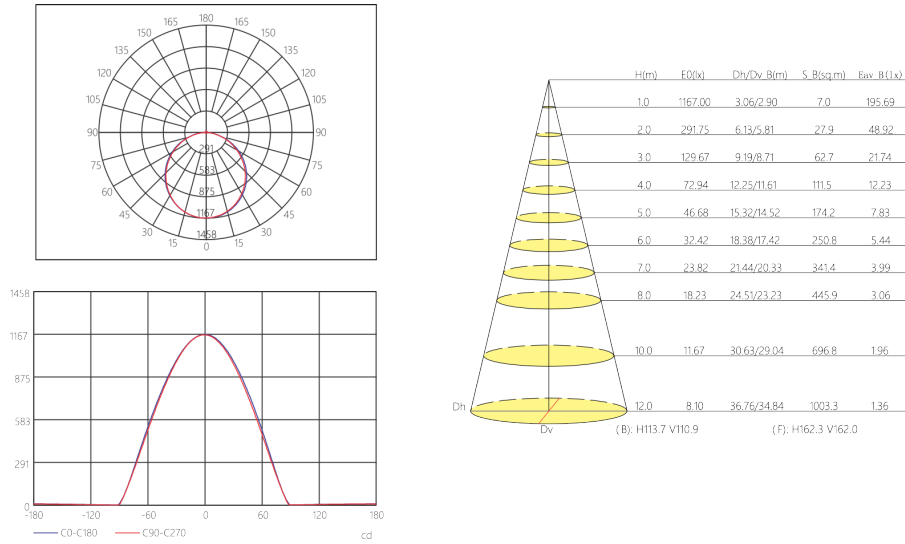

### Mounting

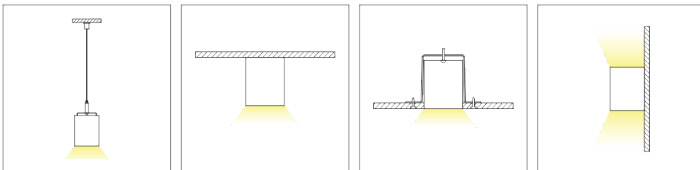

### Accessories

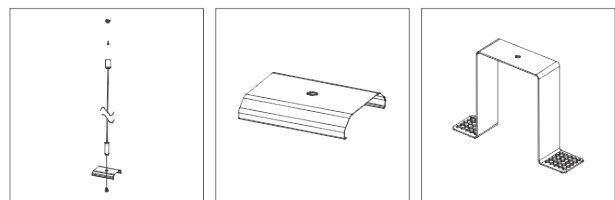

### Connectors

BX-4-L	L shape connector (lit)
BX-4-T	T shape connector (lit)
BX-4-X	X shape connector (lit)
BX-4-C	Continuous linear run connector
BX-4-AC	Pendant hangong kit (aircraft cable)
BX-4-WM	Wall mounting hardware
BX-4-FK	Flange Kit w/mud plate for recessed installation
BX-4-RG001	T Grid Ceiling Accessory

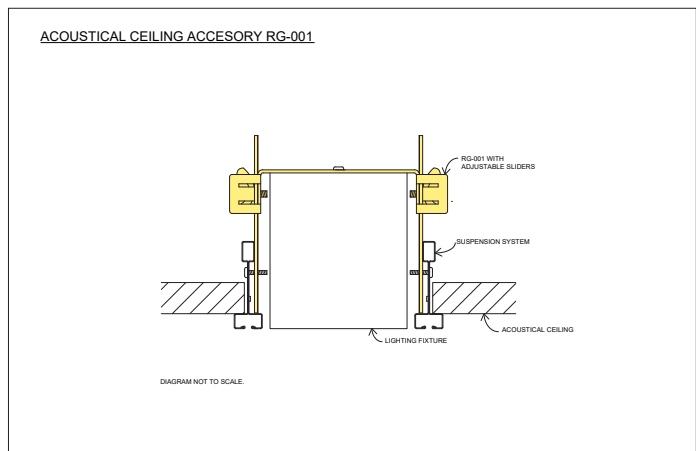

As we continue to innovate and improve our products, we reserve the right to edit, modify, and change our technical documentation.