

## C3R RGB

DMX COLOR CHANGING RIGID LED LINEAR ACCENT LIGHTING  
REMOTE POWER SYSTEM

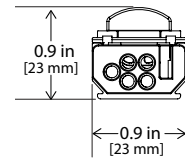

### APPLICATION

RGB three channel DMX color changing technology produces uniform illumination designed to accent and highlight spaces such as small coves, under cabinets or millwork. Tempo supplied DMX driver with optional Nicolaudio DMX intelligent control keypad provides easy color changing scenes. Designed with modular CLIP<sup>®</sup> (Configurable Lighting Platform), C3R provides options to suit multiple application requirements.

### CONSTRUCTION

- Designed with non-ferrous components and mounting brackets. Meets MRI room requirements when used with brass mounting screws (part number C3A-MNTSCREW-BRS).
- 12" long low profile modules in 1', 2', 3', 4', 5' or 6' fixture lengths
- Join sections and create continuous runs up to 16' from one power supply
- Easily replaceable LED printed circuit boards
- Proprietary quick wire connection device provides ease of installation
- Power feeds and jumper cables are available
- CSA damp location listed for indoor use

### OPTICS / LENS / DIFFUSER

- Low profile, lightly frosted lens.

### PERFORMANCE

- 292 total lm/ft
- Dense Pack (DP) LED spacing places more LED's closer together in each 12" module for high uniformity illumination.
- Operating temperature range of -20°C to 50°C
- Power Supply Total Harmonic Distortion <20%, Power Factor >0.9

### DMX COLOR CHANGING RGB

- Three Channel RGB
- Nicolaudio DMX lighting controller utilizing DMX512 (x2) output protocol. Easily view the zone, scene name and design. Change colors and dimming using touch sensitive circular palette.
- Universal input 120V-277V remote Class II 24V output power supply. 100w output. 3 channel DMX/RDM compatible. (PWR-UNV-EM-100-N)
- Sleek black glass design sits 11mm from the wall
- Multi-room control with 500 scenes, 10 zones
- 1024 DMX channels
- USB & Ethernet connectivity for programming and controlling lighting remotely
- Clock & Calendar with Sunrise/Sunset triggering
- Mounts in single or double gang wall box

### PERFORMANCE SUMMARY

<b>Total Watts/Foot</b>	<b>6.0</b>
Watts/ft. (RED)	2.0W
Lumens/ft. (RED)	80
Lumens/Watt (RED)	40
Watts/ft. (GREEN)	2.0W
Lumens/ft. (GREEN)	168
Lumens/Watt (GREEN)	84
Watts/ft. (BLUE)	2.0W
Lumens/ft. (BLUE)	44
Lumens/Watt (BLUE)	22
<b>TOTAL LUMENS/FT.</b>	<b>292</b>
Maximum Run Length*	16 feet

### WARRANTY

Tempo provides a 5-year limited warranty.

### 86,000 HOURS

**L85 LUMEN MAINTENANCE**  
LED Luminaires will reach 85% of initial lumen output at or beyond 86,000 hours at 25°C.

**MADE IN USA**  
OF US AND IMPORTED COMPONENTS



## C3R RGB

DMX COLOR CHANGING RIGID LED LINEAR ACCENT LIGHTING  
REMOTE POWER SYSTEM

### ORDERING INFORMATION

Example: **C3R-LL-00-6-RGB-LG**

C3R, lightly frosted lens, 6W/Ft, RGB, Light Gray

<b>C3</b>	<b>R</b>	<b>LL</b>		<b>6</b>	<b>RGB</b>	<b>LG</b>	
Series	Platform	Optic/Lens/Diffuser	Module Spacing	Watts/Foot	Color Temp	Finish	Fixture Length <sup>1</sup>
<b>C3</b>	<b>R</b> Rigid	<b>LL</b> Lightly frosted lens	<b>00</b> 0"	<b>6</b> 6 W/ft	<b>RGB</b> Red/Green/Blue	<b>LG</b> Light Gray	

NOTES:

(1) Fixture length measured in feet. 1', 2', 3', 4', 5' or 6' fixture lengths.

### SYSTEM INTEGRATION ACCESSORIES

24V DMX POWER SUPPLIES/CONTROLLER	
<b>PWR-UNV-EM-100-N</b>	120-277V AC Input, 24V DC Output, 100W, DMX/RDM
<b>PCC-DMX-N1</b>	Nicolaudie (Stick-DE3+) DMX Controller, DMX512 (x2), wall mount in single or double gang box. Includes AC/DC power supply, Micro SD card and USB Cable.
SURGE SUPPRESSION DEVICE A Tempo furnished surge suppression device must be installed on each supplying branch circuit to comply with Tempo's 5-year warranty terms	
<b>SSD-120</b>	120V Branch Circuit
<b>SSD-277</b>	277V Branch Circuit
POWER FEED CABLES Additional lengths available, contact factory	
<b>PFC4-F-24-36</b>	5-Pin Female Connector, 24V, 36 inches
JUMPER FEED CABLES Additional lengths available, contact factory	
<b>JFC4-MF-24-18</b>	5-Pin Female/Male, 24V, 18 inches
MOUNTING HARDWARE 18" maximum recommended spacing between mounting clips	
<b>C3A-MTGBRKT-SURF</b>	Set of 25 Mounting clips (screws included)
<b>C3A-MTGBRKT-SURF-20</b>	Set of 25, 20° Mounting clips (screws included)
<b>C3A-MNTSCREW-BRS</b>	Non Ferrous Brass mounting screw only for C3R mounting clip. (Meets MRI room requirements)

## C3R RGB

DMX COLOR CHANGING RIGID LED LINEAR ACCENT LIGHTING  
REMOTE POWER SYSTEM

### DIMENSIONAL INFORMATION Total Fixture Lengths of 1', 2', 3', 4', 5' or 6' available

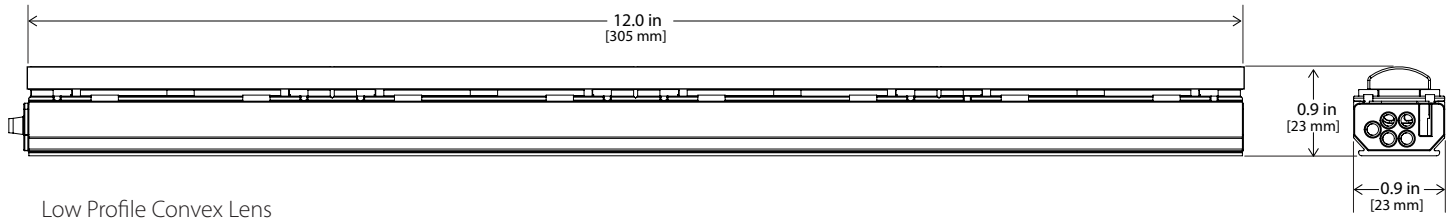

### MOUNTING CLIPS (Mounting screw provided)

NOTE: 18" maximum recommended spacing between mounting clips.

#### C3A-MTGBRKT-SURF

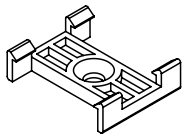
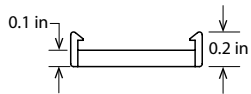
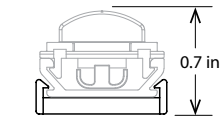
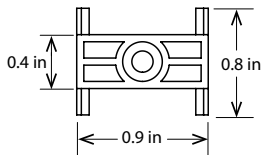

#### C3A-MTGBRKT-SURF-20

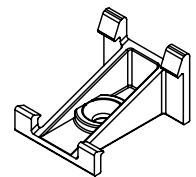
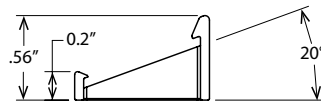
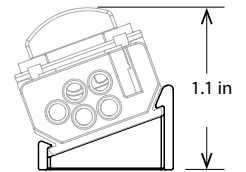
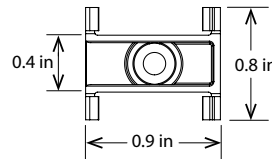

### NICOLAUDIE STICK-DE3+ DMX CONTROLLER

NOTE: Mounts inside single or double gang box



## C3R RGB

DMX COLOR CHANGING RIGID LED LINEAR ACCENT LIGHTING  
REMOTE POWER SYSTEM

### WIRING DIAGRAMS

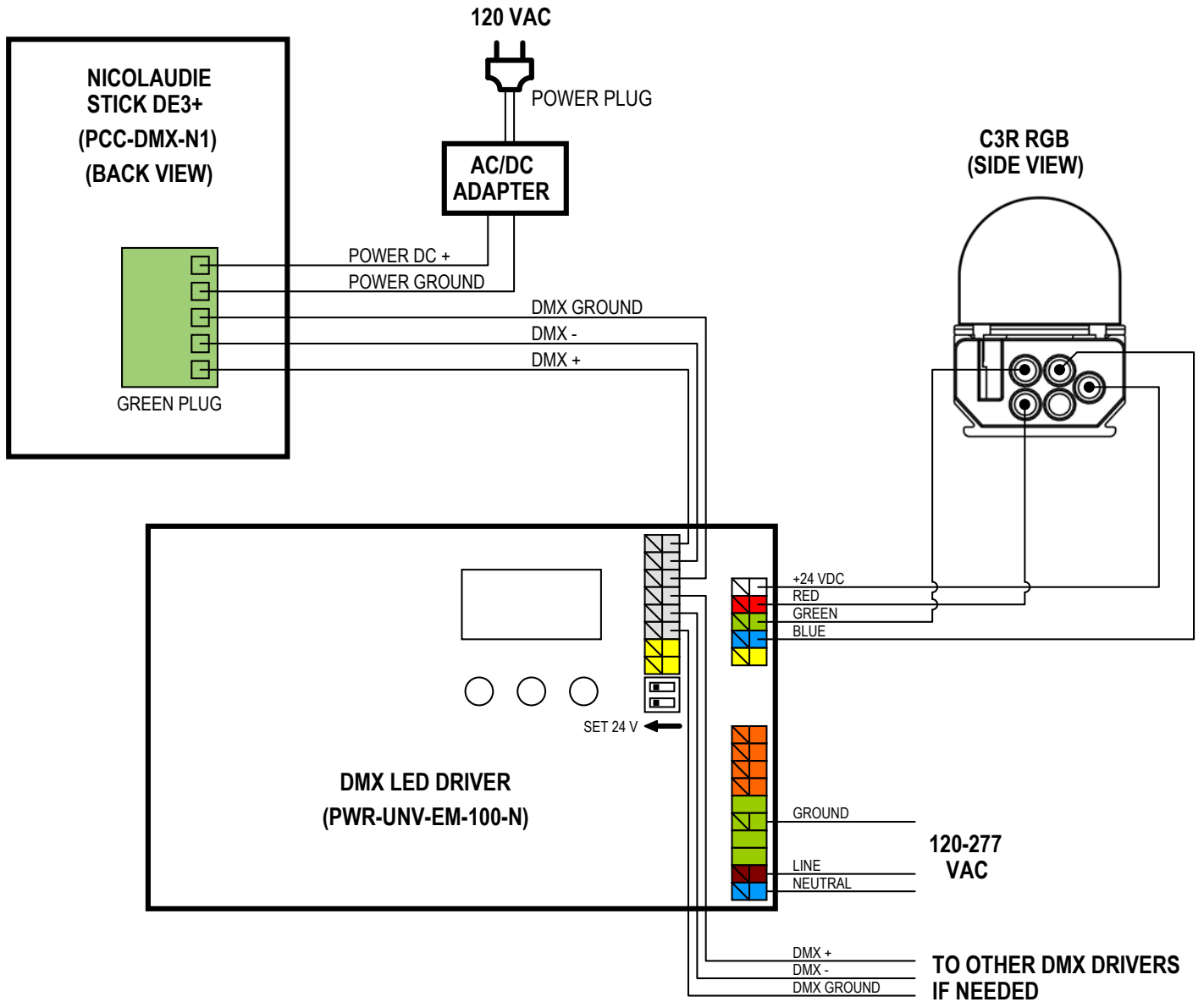

Tempo Industries reserves the right to change materials or modify the design of its product without notification as part of the company's continuing product improvement program. Please consult [www.tempoindustries.com](http://www.tempoindustries.com) for the most up-to-date specifications and technical data.