

LEAWOOD  
PLAN

MAIN FLOOR

1,080  
SQ. FT. | 1/2  
BATHROOM



2ND FLOOR

1,223  
SQ. FT. | 3  
BEDROOMS | 2  
BATHROOMS



POSSIBLE BASEMENT

820  
FINISHED SQ. FT. | 1  
BEDROOM | 1  
BATHROOM

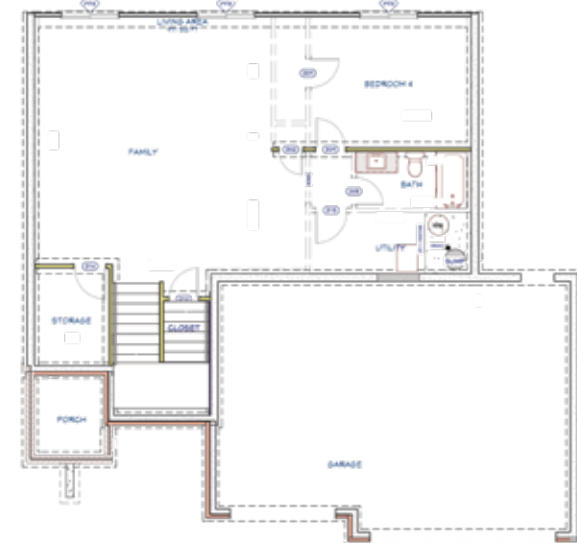

Disclaimer: Please note the floor plan is for illustrative purposes and is to be used as a guide only. The illustrations may include upgrades and optional features. Final square feet, bedrooms and bathrooms may vary from what is indicated here.

# LEAWOOD ELEVATION

## ELEVATION



## FEATURES

- Unique Sprawling Open-Concept Two Story Plan
- Pet Center Complete With Washing Station Off Garage Entry
- Dedicated Drop Zone and Half Bath Conveniently Located Off Garage Entry
- Massive Great Room With Windowed Staircase Feature
- Additional Living Space With The Upstairs Loft Space
- Third Living Space In The Basement
- Walk-In Pantry
- Walk-In Master Closet
- Two-Story Accommodating HVAC System
- 92% Energy Efficient Furnace
- Passive Radon Vent
- 1-Year Builder Warranty

## AVAILABLE IN

- Clear Creek
- Southern Ridge



MILLERFAMILYHOMES.COM

Disclaimer: Please note the floor plan is for illustrative purposes and is to be used as a guide only. The illustrations may include upgrades and optional features. Final square feet, bedrooms and bathrooms may vary from what is indicated here.