

# PAIR YOUR MILOCK ZWAVE LOCK TO SMARTTHINGS

Requires SmartThings hub to be installed and connected and paired before continuing. Please refer to your SmartThings instructions to do this.

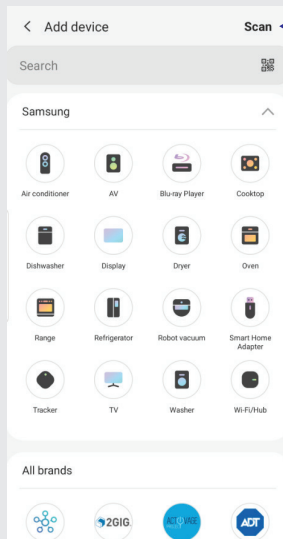
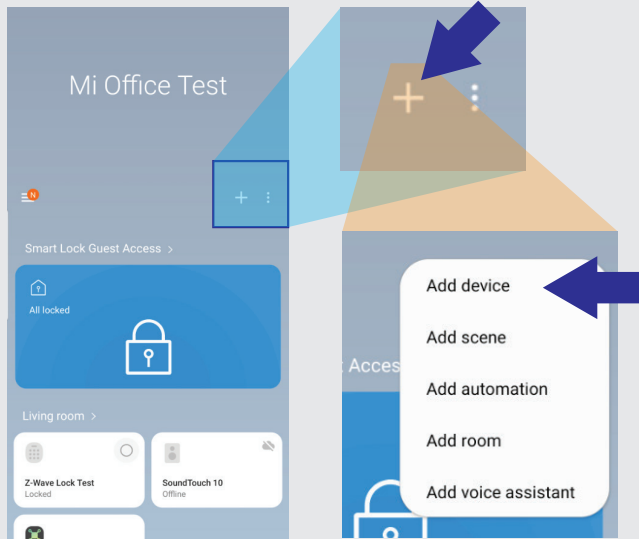

Tap on **SCAN** in Smarthings app.

Be sure the switch is set to **1** for Deadbolt model or **ON** for Lever/Knob models

Now press the **C** program button on your lock (three beeps indicate pairing)

Set preferred name and zone.

Your lock is now paired to SmartThings



*Lock Program Controls located under battery cover of lock.*

# UNPAIR AND DELETE YOUR MiLOCK ZWAVE LOCK FROM SMARTTHINGS

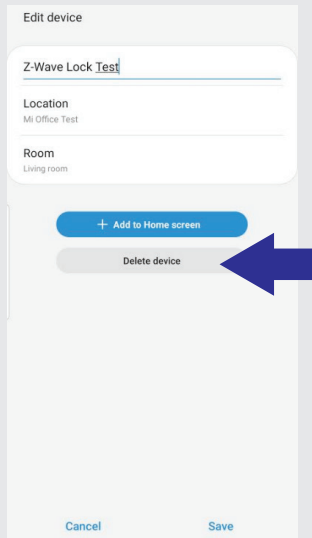
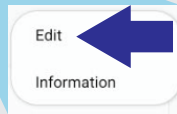
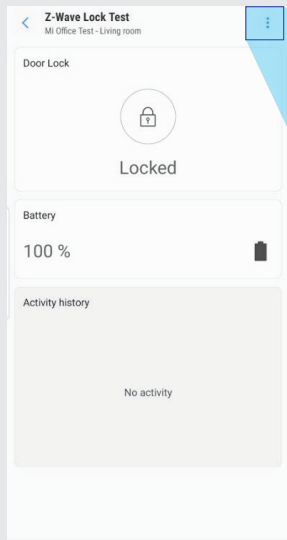
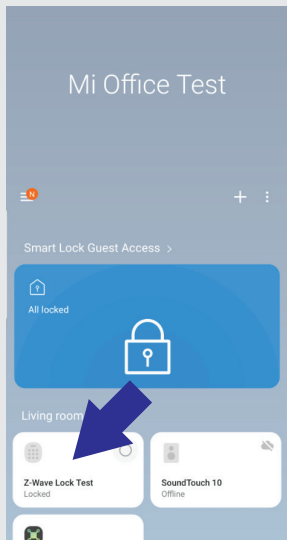

Tap on **DELETE DEVICE** in Smarthings app.

Be sure the switch is set to **1** for Deadbolt model or **ON** for Lever/Knob models

Now press the **C** program button on your lock (three beeps indicate delete process)

Your lock is no longer paired with your app.



*Lock Program Controls located under battery cover of lock.*

