



Interstate Marketing Services

2831 St Rose Parkway, Ste 200, Henderson, NV 89052
Telephone: 702-818-1155 (ask for sales) or Fax: 702-818-1156
<http://interstatemarketingservices.com>

The Tiny Marvel - 12' x 32' Loaded with Features!



CONSTRUCTION:

- Concealed Ridgebeam
- HUD Construction Zone II
- Insulation: R-11 Walls, R-22 Floor, R-25 Roof
- 30 Pound Roof
- 24" On Center Trusses
- 1 Year Factory Warranty

EXTERIOR:

- Vinyl Dual Paned Glazed Windows (no grids)
- Upgraded Porch Lights at Front and Rear Entries
- 3' Inswing Front Entry Door with Deadbolt
- 2'- 8" Inswing Rear Entry Door with Deadbolt
- 12" Front and Rear Overhangs on Doublewides
- 12" Front Overhang on Singlewides
- Cempanel Cement Siding

INTERIOR:

- Full Tape & Texture Drywall Throughout
- Vaulted Ceiling Throughout
- Linoleum Entry
- Moulding Package
- 6-Panel Passage Doors, Round Knobs
- White Hollow Core By-Pass Closet Doors (per plan)
- Dining Room Chandelier (per plan)
- Breakfast Room Pan Light (per plan)
- Ceiling Fan "Ready" in Living Room and Master Bed
- Ceiling Lights in All Secondary Bedrooms
- Valance Package
- Diamond Floor® Linoleum
- Mantra® Carpet, 1/2" FHA Pad
- Interior Decor Selection

KITCHEN:

- Laminate Edge, Countertops, Backsplash
- Single Lever Faucet with Sprayer
- 7" Stainless Steel Sink
- Gas or Electric Range (elec. requires elec. kitchen)
- 16 CF Double Door Frost Free Refrigerator

CABINET SYSTEM:

- Wood Cabinet Doors
- Drawers Over Drawers in Kitchen Base Cabinets
- Bank of Drawers in Kitchen Base Cabinets
- Cabinet Over Refrigerator
- Adjustable Shelves in Kitchen Overhead Cabinets
- Hidden Hinges
- Coved Cabinet Moulding on Overhead Cabinets

BATHROOMS:

- Upgraded Sinks
- Fiberglass Tub/Shower
- Shower Stall (per plan, glass enclosure is optional)
- Laminate Edge Countertops & Backsplash
- Single or Dual Lever Faucets
- Towel Bars & Tissue Holders
- Exhaust Fans
- Flat Edge Medicine Cabinet and Mirrors
- Lights Above Sinks
- Round Toilets

ENERGY SAVING COMFORT FEATURES:

- (Electric - Plumbing - Heating - Utility)
- Utility Overhead Shelf Above Washer/Dryer Space
 - Gas or Electric Furnace (electric requires total electric package)
 - 30 Gallon Electric Water Heater
 - Plumb/Wire and Vent for Washer/Dryer
 - Brass Shut-Off Valves Throughout
 - 100 AMP Service
 - Exterior Receptacle on Front Door Side

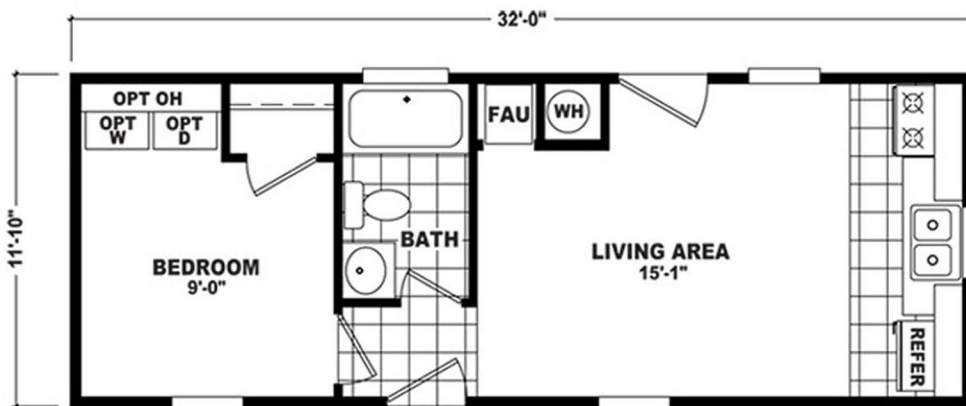

Call our sales department at 702-818-1155 (ask for sales) or call our cell at 701-334-0174. You can also email us at info@interstatemarketingservices.com for details about our services and current specials. We are a full service agency and can assist buyers with arranging transport and setup. Financing available on approved credit.