

# CLINTON SERVICE GUIDE

## MODEL 315NA-TA600

### FOR

## SEIKO DC-27 BANDER

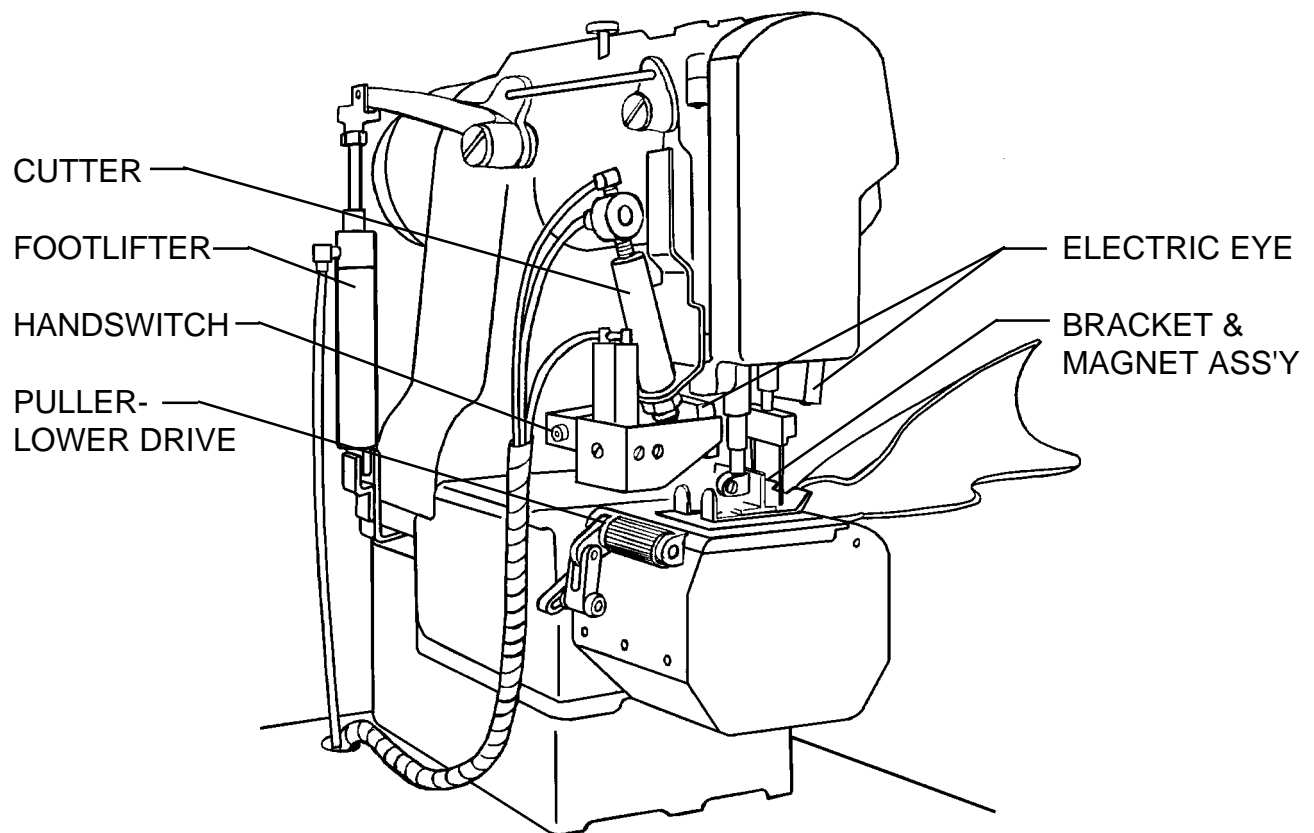

The Clinton Model 315NA-TA600 is an impact thread cutting and waist band puller system especially designed for the Seiko DC-27 Bander. An LCD programmable controller is used with electric eyes to sense the leading and trailing edge of the garment and control foot lifter, cutter, puller, limit speed and maximum speed sewing.



Clinton Industries, Inc.  
 700 Washington Ave.  
 Carlstadt, N.J. 07072  
 Phone: 201-935-4242  
 Fax: 201-935-3615  
[www.clintonind.com](http://www.clintonind.com)  
 E-mail: [general@clintonind.com](mailto:general@clintonind.com)

### BANDER KNIFE & PULLER PRESSURE FEET ASSEMBLY MODEL 315NA-TA600 80-0544-01

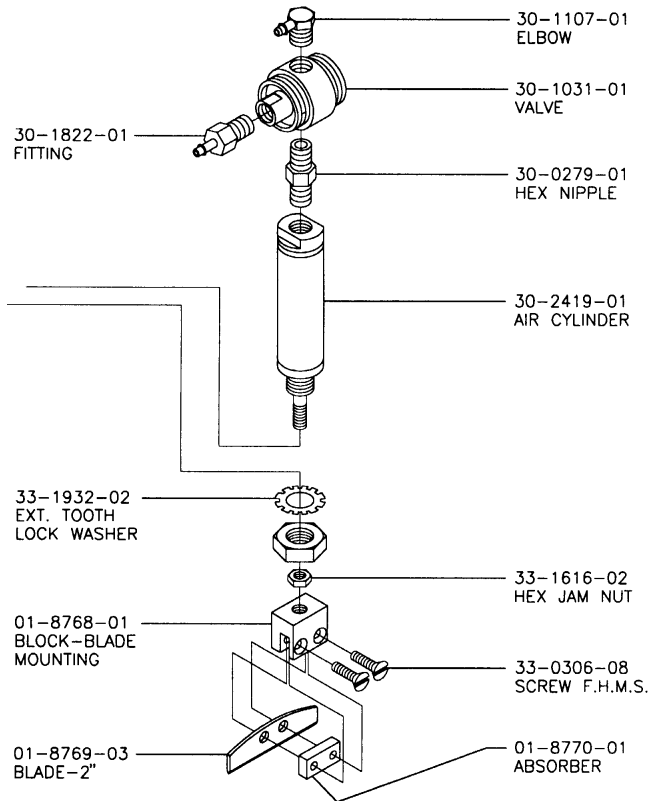
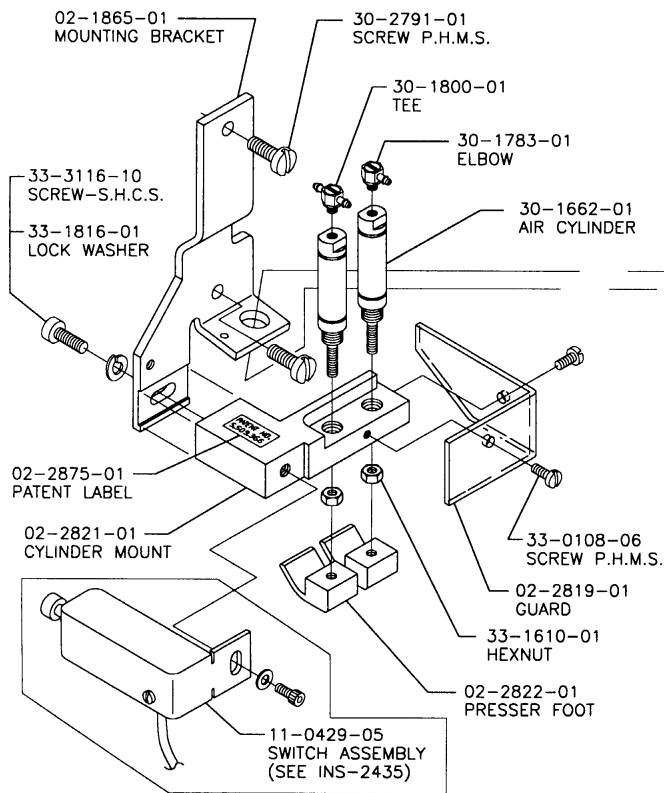

INS-2646

### PULLER SEIKO DC-27, BANDER 80-0520-03

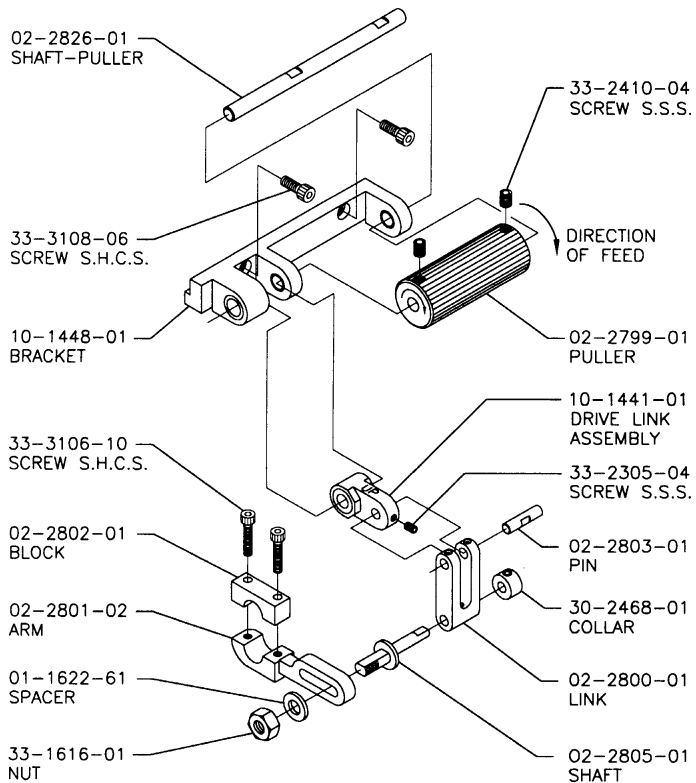

INS-2645

### PRESSER FOOT SINGER 302 BANDER 10-1446-01

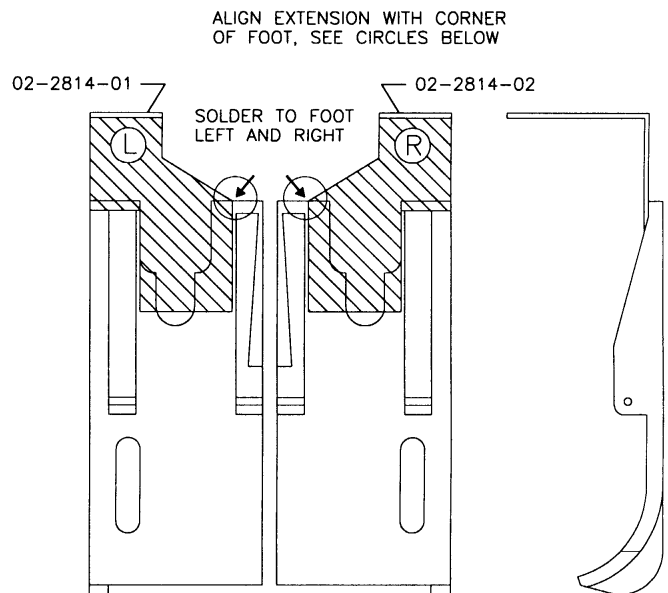

INS-2426B

**SENSOR ASSEMBLY**  
SEIKO DC-27 BANDER  
81-0842-03

INS-2647

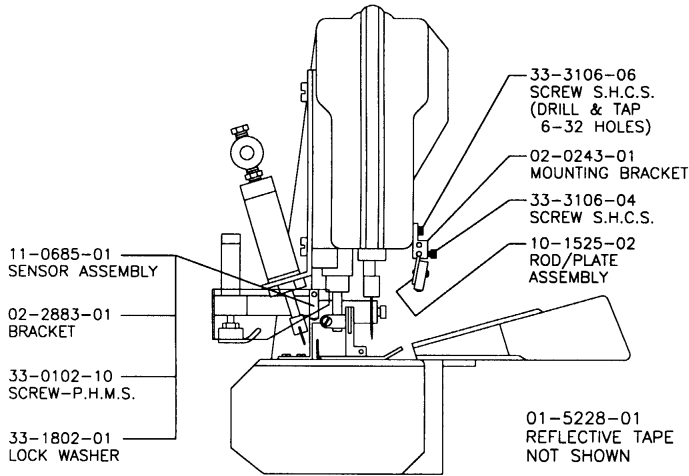

**FOLDER SENSOR ASSEMBLY**  
81-0843-01

INS-2433A

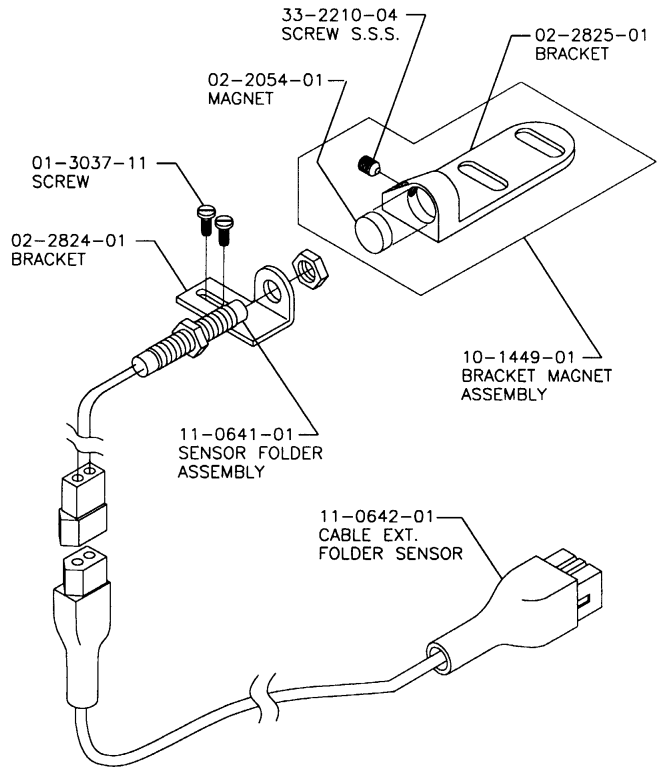

**MACHINE MODIFICATIONS**

INS-2434E

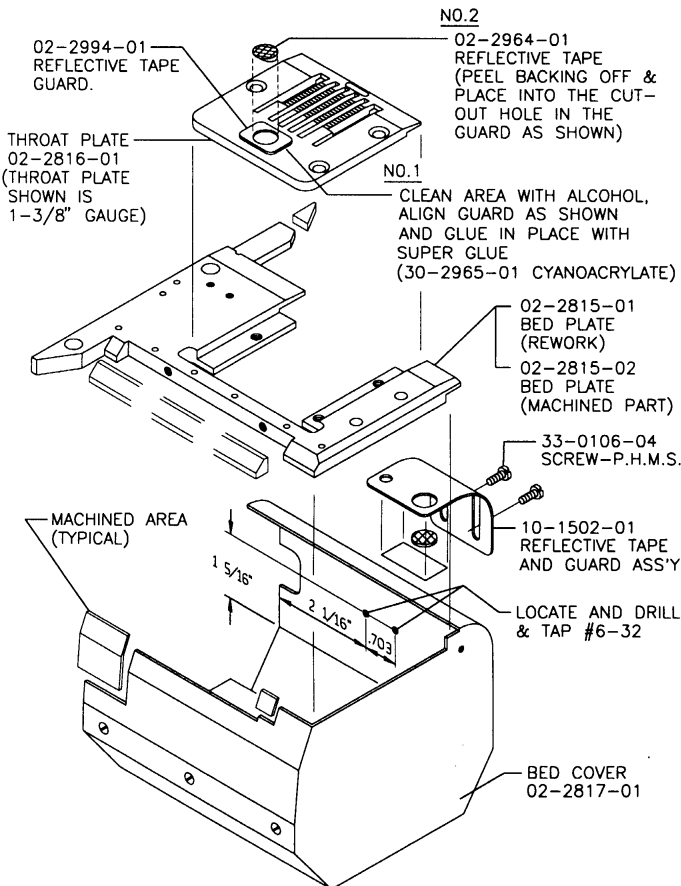

**SWITCH ASSEMBLY**  
11-0429-05

INS-2435

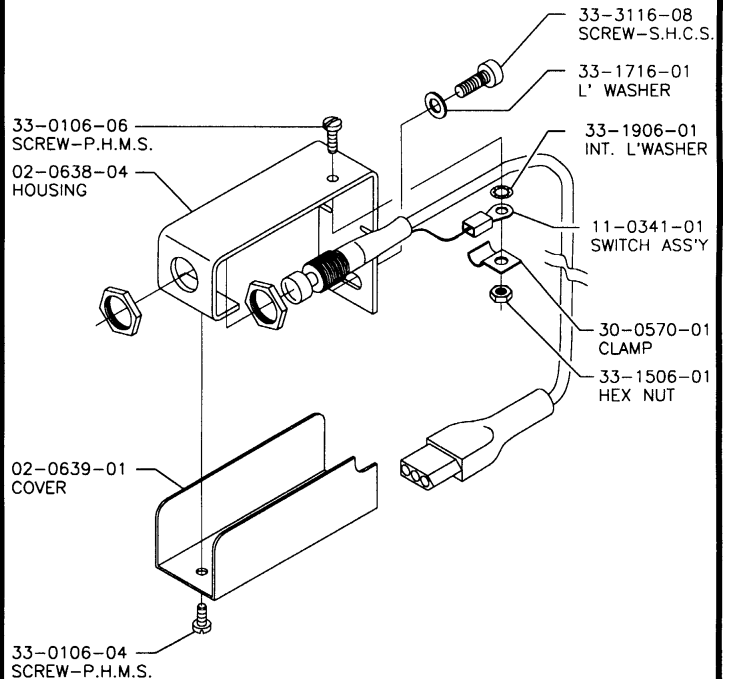

**SOLENOID VALVE ASSEMBLY**

INS-2424A

**MODEL 315NA-TA600**  
81-0841-01

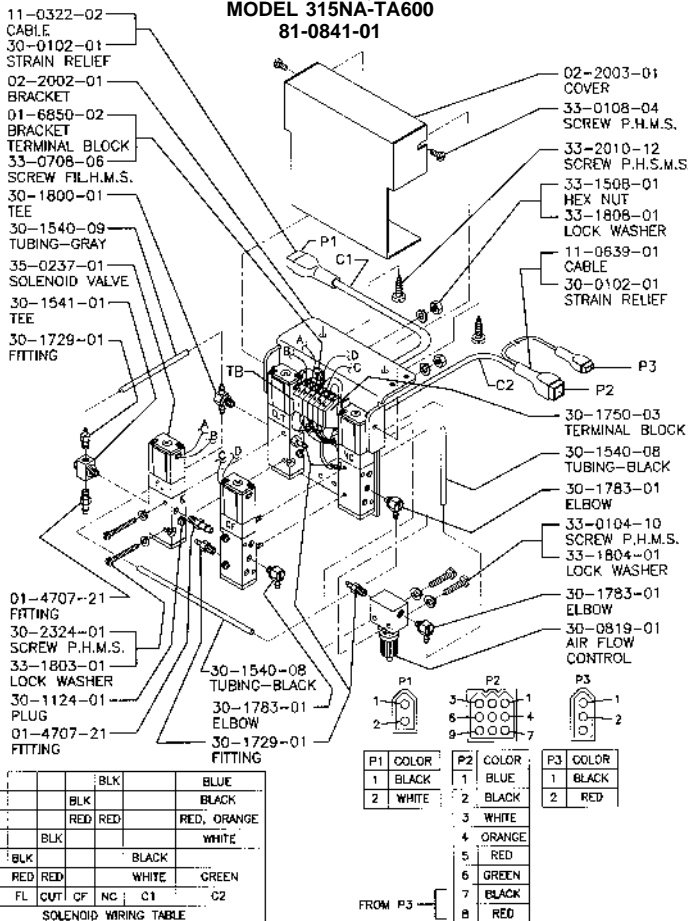

**AIR CIRCUIT DIAGRAM**  
**MODEL 315NA-TA600**

INS-2425

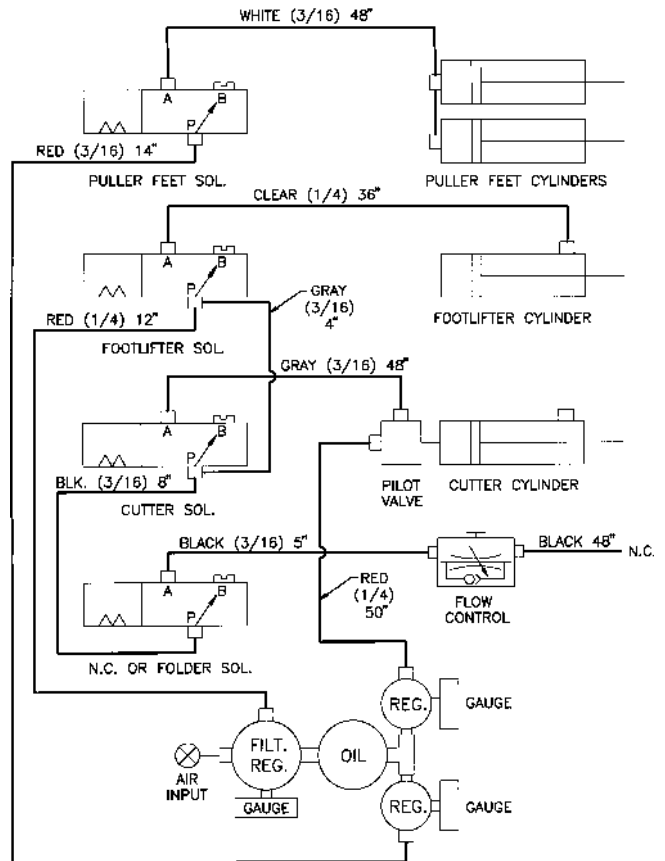

**FILTER, REGULATOR, GAUGE ASSEMBLY**  
**INDEPENDENT REGULATION**  
**MODEL 315NA-TA600**  
80-0181-28

INS-570-16A

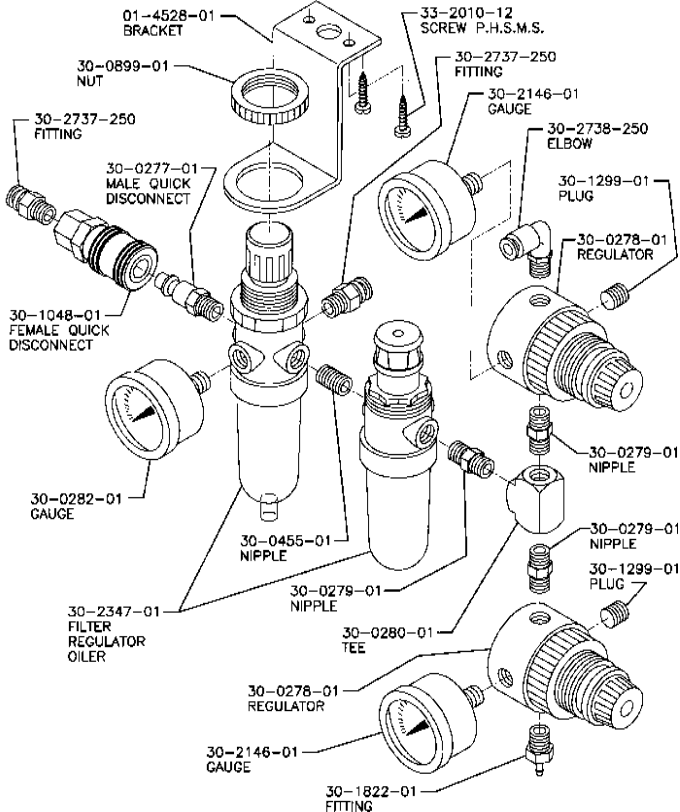

**FOOTLIFTER ASSEMBLY**  
SINGER 302 /201, 80-0180-119  
SEIKO DC-27, 80-0180-138

INS-2265D

