

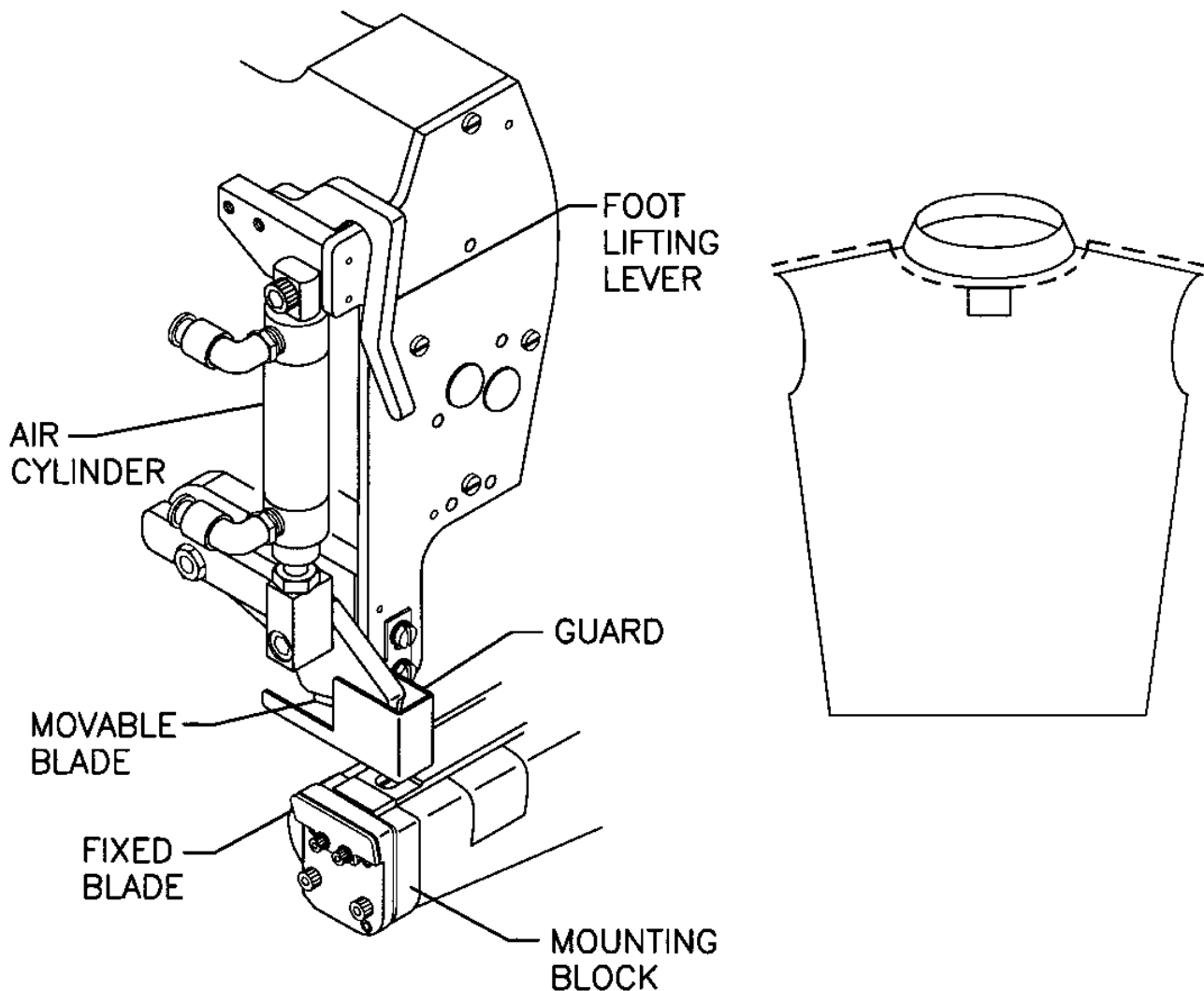

# CLINTON SERVICE GUIDE MODEL 117VS-FOTA-KS SINGER 261

## SHEAR CUTTER FOR SHOULDER TAPING OPERATION



 **CLINTON INDUSTRIES, INC.**  
700 Washington Avenue  
Carlstadt, N.J. 07072  
Phone: 201-935-4242  
FAX: 201-935-3615  
Web Site: <http://www.clintonind.com>  
Email: [general@clintonind.com](mailto:general@clintonind.com)

## DRILLING & INSTALLATION INSTRUCTIONS

### STEP 1

REMOVE EXISTING FACE PLATE.

### STEP 2

INSTALL THE CUTTER AS A COMPLETE ASSEMBLY. START BY PLACING THE LIFT ARM IN AND WORKING THE LIFT ARM UP AND AROUND BETWEEN THE MACHINE WALL AND BAR "A" AS SHOWN.

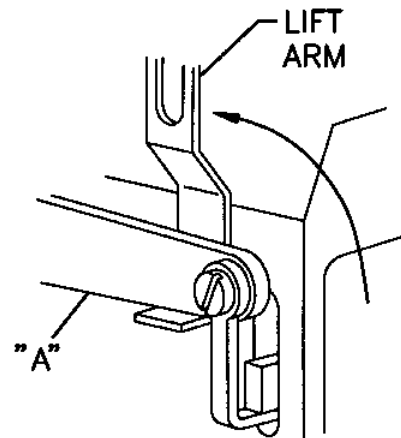
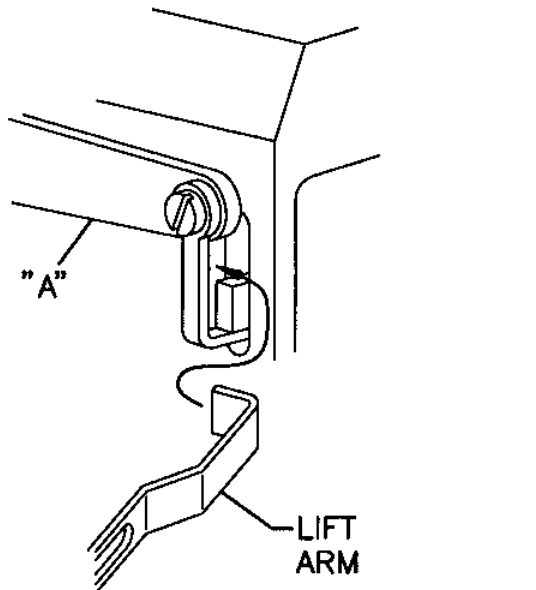

### ADJUSTMENTS

## WARNING!!

TO PREVENT SERIOUS INJURY, DISCONNECT AIR SUPPLY BEFORE MAKING ANY ADJUSTMENTS.

### STEP 3 MOUNT VERTICAL SHEAR CUTTER WITH THE (4) EXISTING SCREWS

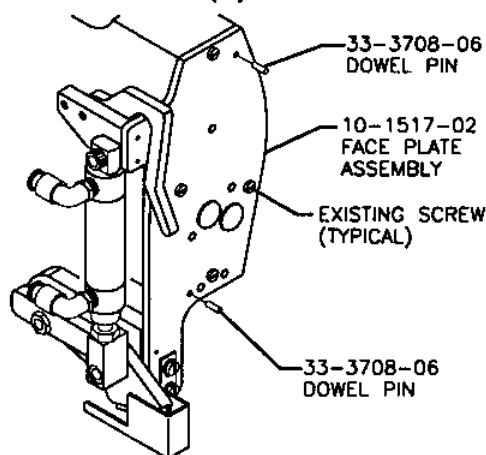

NOTE: LATER WHEN THE CUTTER IS INSTALLED COMPLETELY ALONG WITH THE STATIONARY BLADE AND ALL THE ADJUSTMENTS HAVE BEEN MADE AND THE CUTTER IS WORKING PERFECTLY, USE THE DRILLS PROVIDED TO DRILL HOLES FOR THE DOWEL PINS USING THE FACE PLATE HOLES AS THE TEMPLATE. USE DRILL #33 (30-1070-01) FOR THE PILOT HOLES FIRST, 3/16" DEEP. THEN USE 1\8" DIA. (30-2376-08), SAME DEPTH 3/16".

### STEP 4 ADJUSTING THE MOVABLE BLADE

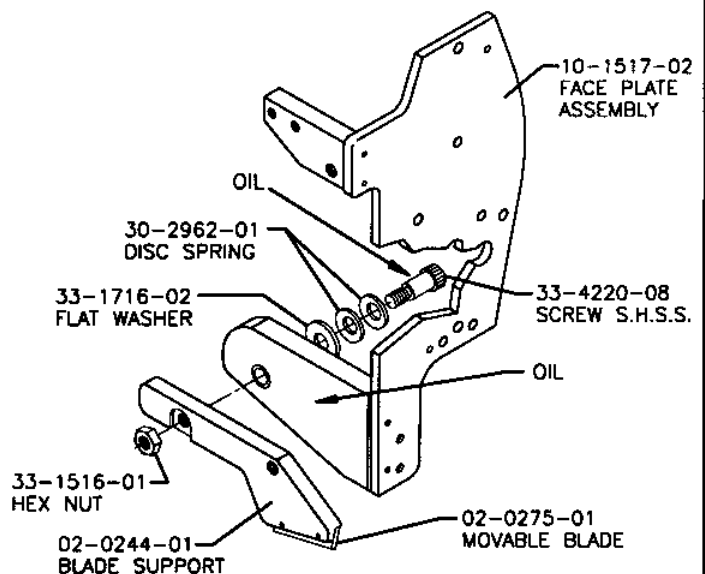

SHOULDER SCREW 33-4220-08 SHOULD BE SCREWED INTO THE BLADE SUPPORT, FINGER TIGHT. THE HEX NUT 33-1516-01 IS USED TO LOCK IN THE ADJUSTED CONDITION.

**STEP 5** ADJUSTING THE STATIONARY BLADE

IF THE BLADES ARE NOT TOUCHING EACH OTHER, LOOSEN THE THE (2) SCREWS 33-3210-08. THIS WILL ALLOW THE (2) TOP JACK SCREWS 33-2210-03 TO BE TURNED TO MAKE UP ANY ADJUSTMENT. ADJUST THE (2) SCREWS 33-2210-03 ON THE RIGHT FOR THE RADIAL ADJUSTMENT OF THE FIXED BLADE AS SHOWN. RETIGHTEN THE (2) SCREWS 33-3210-08. TRY LOWERING THE MOVABLE BLADE SLOWLY (WITHOUT THE AIR BEING ON) FOR TESTING THE SHEARING ACTION. IT MAY REQUIRE SEVERAL ADJUSTMENTS TO GET EXACTLY YOUR CUTTING NEEDS.

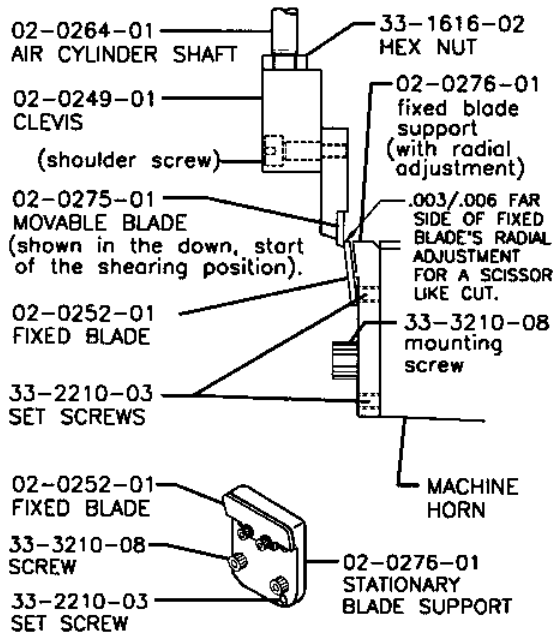

**AIR CIRCUIT DIAGRAM**  
 MODEL 117VS KS  
 MODEL 117VS F.O.R.G.-KS

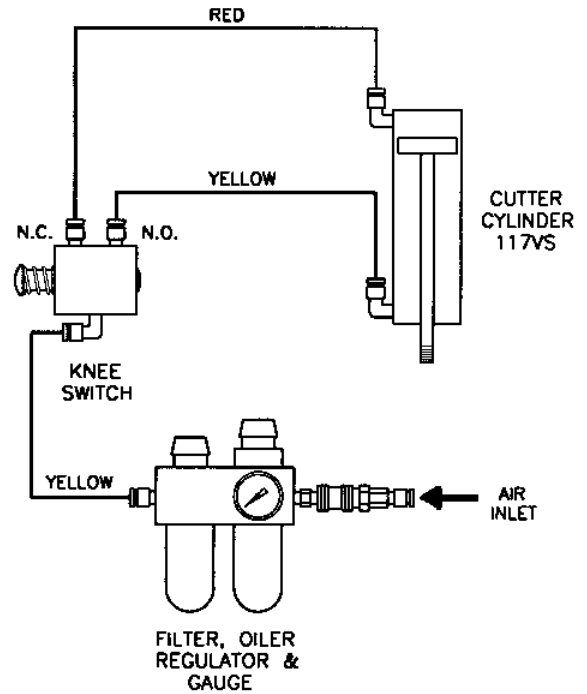

INS-570-30

**FILTER, OILER, REGULATOR, GAUGE ASSEMBLY**

80-0181-01  
 80-0181-10

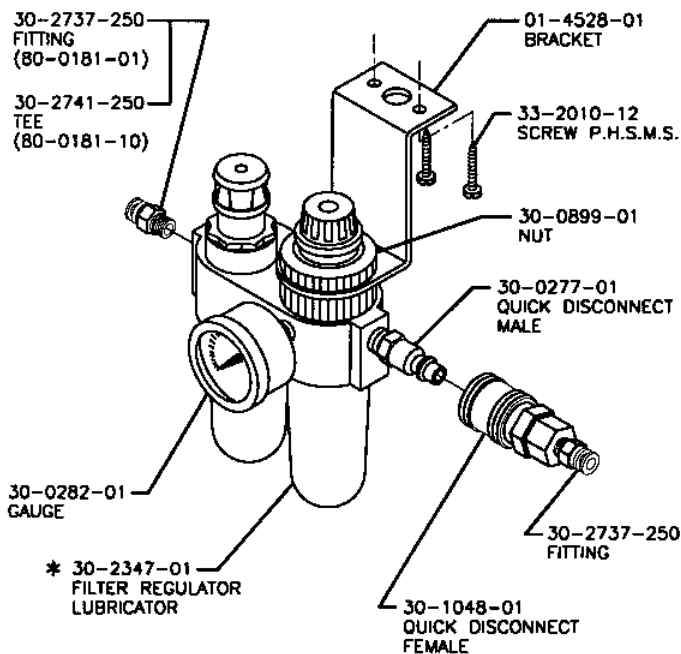

\* NOTE: SEE INS-DRAWINGS 2100-1 AND 2100-2 FOR SPARE PARTS

INS-619-1A

**4 WAY AIR VALVE, KNEE OPERATED**  
 80-0185-01

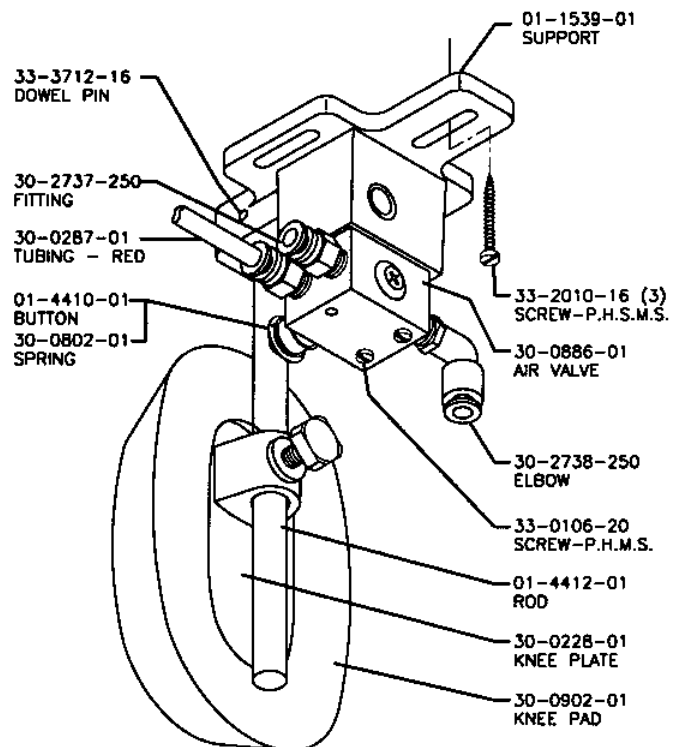

# CUTTER ASSEMBLY

MODEL 117VS  
SINGER 261  
80-0539-02

01-3061-11  
SCREW (LONG)  
01-1509-61  
BUSHING (LONG)  
02-0254-01  
LEVER

33-3210-04  
SCREW S.H.C.S.  
33-4220-06  
SCREW S.H.S.S.

30-2738-250  
ELBOW  
02-0264-01  
AIR CYLINDER

30-2962-01  
DISC SPRING  
33-1716-02  
FLAT WASHER  
02-0262-01  
BEARING

33-1516-01  
HEX NUT  
02-0244-01  
BLADE SUPPORT

02-0275-01  
MOVABLE BLADE  
33-1616-02  
HEX NUT

02-0249-01  
CLEVIS

02-0250-01  
SCREW S.H.S.S.

33-1805-01  
LOCK WASHER

33-3105-04  
SCREW S.H.C.S.

02-0252-01  
STATIONARY BLADE

33-3210-08  
SCREW S.H.C.S.

02-0276-01  
STATIONARY BLADE  
SUPPORT

02-0659-01 \*  
ROD

33-1516-01 \*  
HEX NUT

02-0256-01 \*  
ARM-RIBBON  
RACK

01-3061-51  
SCREW (SHORT)

01-1509-31  
BUSHING (SHORT)

02-0247-01  
LIFT ARM

10-1517-02  
FACE PLATE  
ASSEMBLY

EXISTING SCREW

33-3708-06  
DOWEL PIN

33-4220-08  
SCREW S.H.S.S.

EXISTING SCREW

33-3210-04 \*  
SCREW S.H.C.S.

EXISTING SCREW

30-1509-01  
RUBBER PLUG

33-0308-06 \*  
SCREW F.H.M.S.

02-0657-01 \*  
NUT PLATE

33-3210-08 \*  
SCREW S.H.C.S.

02-0261-01 \*  
FOLDER BRACKET

01-3849-10 \*  
SPACER

EXISTING SCREW

33-3708-06  
DOWEL PIN

33-0108-04  
SCREW P.H.M.S.

33-1708-01  
FLAT WASHER

02-0253-01  
GUARD

33-0305-04  
SCREW F.H.M.S.

EXISTING  
SCREW

02-0260-01  
MOUNTING BLOCK

33-2210-03  
SCREW S.S.S.

02-0258-01  
PRESSER FOOT  
EXTENSION

\* NOT PART OF 80-0539-02