

CLINTON SERVICE GUIDE MODEL 115VS-FOTA FOR YAMATO FD-62

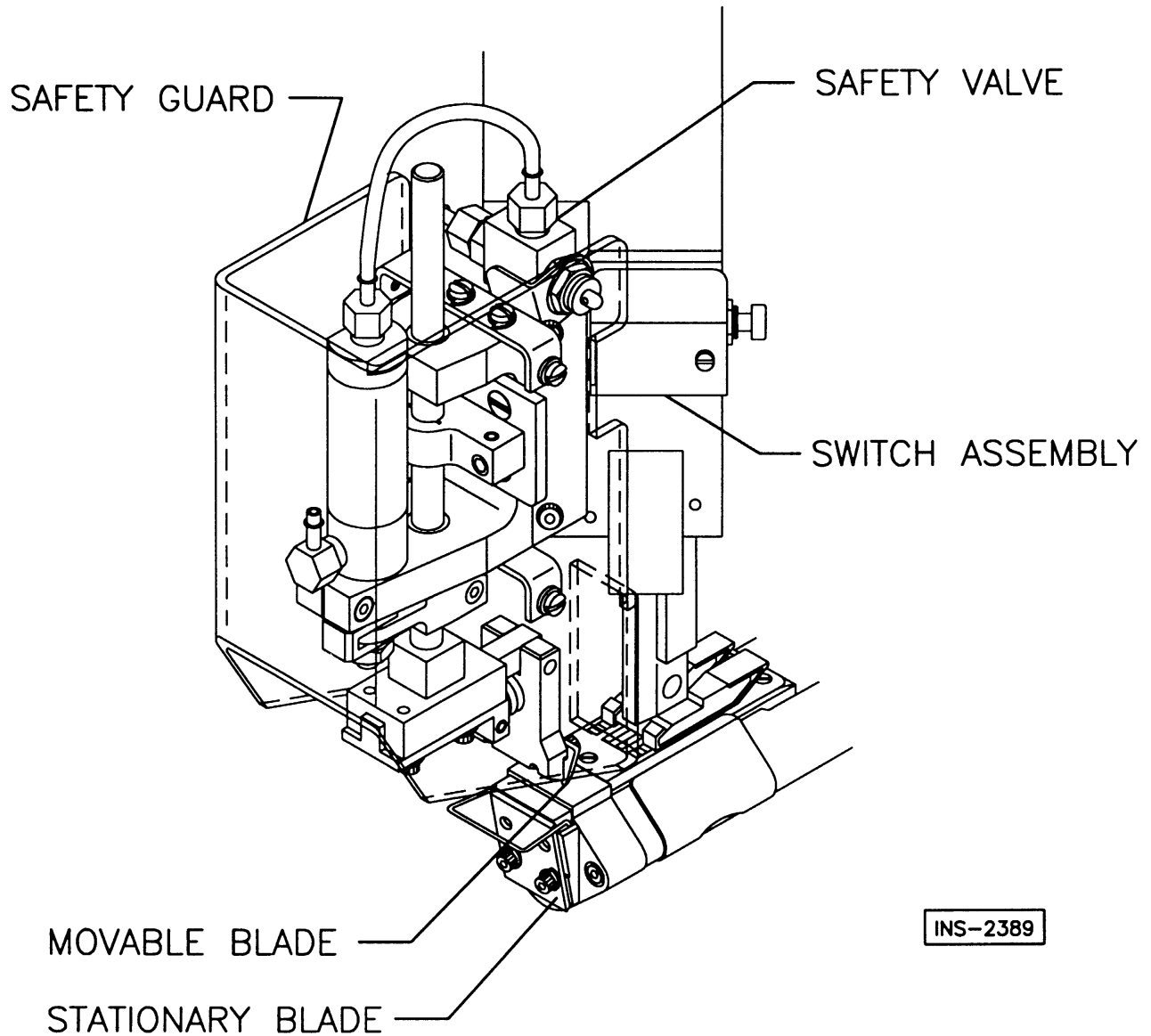

INS-2389

DRILLING & INSTALLATION INSTRUCTIONS

DRILLING INSTRUCTIONS CHAIN CUTTER MODEL 115VS FOTA

1. PLACE THE DRILL JIG ON THE MACHINE AS SHOWN.
2. ALIGN THE TOP OF THE DRILL JIG WITH THE TOP OF THE MACHINE BED.
3. TIGHTEN THE LOCKNUT ON END OF SHOULDER SCREW.
4. DRILL (2) TWO HOLES MARKED "A" WITH #29 DRILL (30-2130-29) SUPPLIED.
5. LOOSEN THE LOCKNUT AND REALIGN THE JIG SO THE TAPPING GUIDE HOLES WILL ALIGN WITH THE DRILLED HOLES.
6. TAP THE HOLES WITH AN 8-32 TAP (30-1266-01) USING THE TAP GUIDE HOLES TO GUIDE THE TAP STRAIGHT.
7. REMOVE THE DRILL JIG.

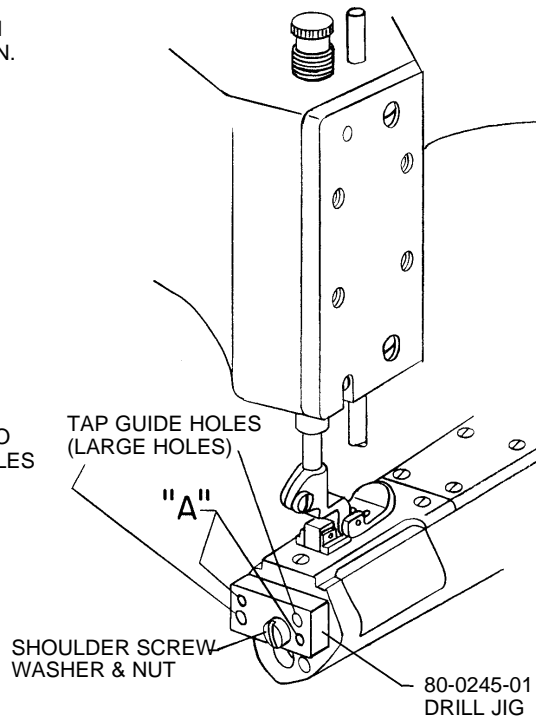

SWITCH ASSEMBLY 11-0429-03

INS-2396

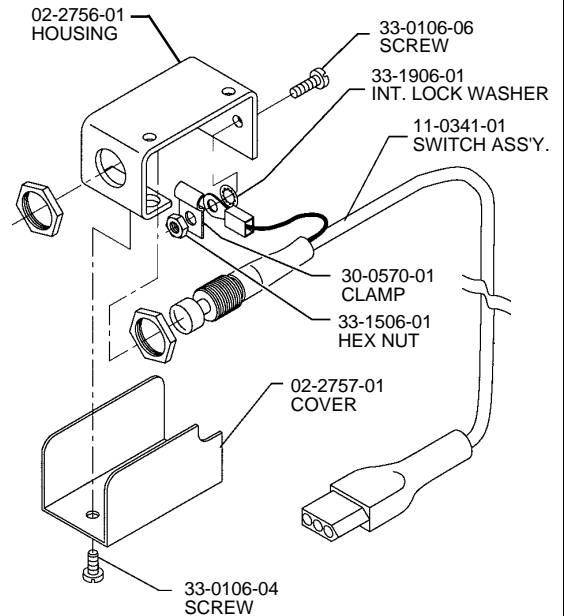

MOVABLE BLADE

INS-2297

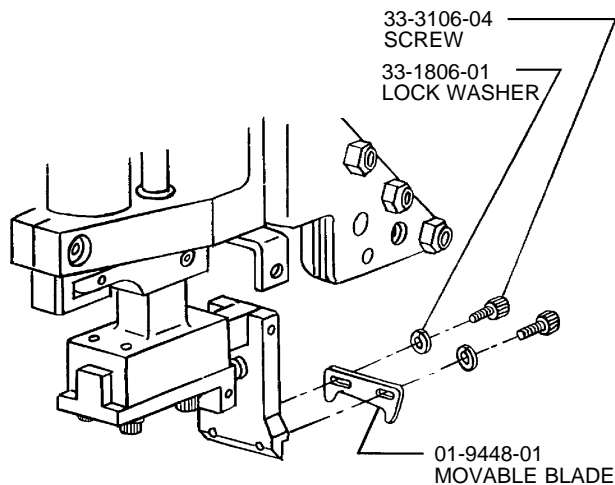

NOTES:

1. ASSEMBLE MOVABLE BLADE 01-9448-01 WITH SCREWS (2) 33-3106-04 AND LOCK WASHERS (2) 33-1806-01.
2. DO NOT TIGHTEN MOVABLE BLADE SCREWS AT THIS TIME. REFER TO ALIGNMENT ADJUSTMENT.

STATIONARY BLADE

INS-2390

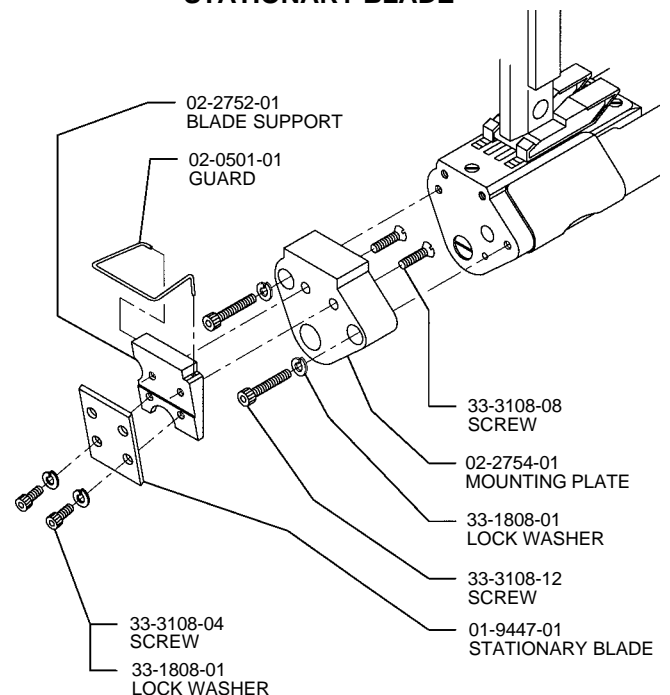

NOTE:
ASSEMBLE STATIONARY
BLADE AS SHOWN

ADJUSTMENTS

WARNING!! TO PREVENT SERIOUS INJURY, DISCONNECT AIR SUPPLY BEFORE MAKING ANY ADJUSTMENTS.

RADIAL

INS-2298

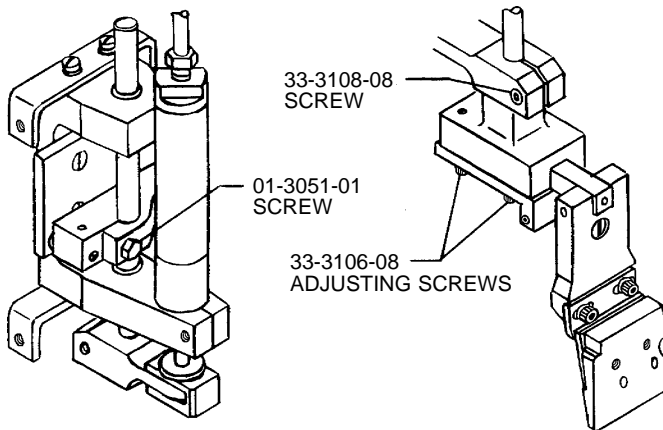

ALIGNMENT

INS-2299

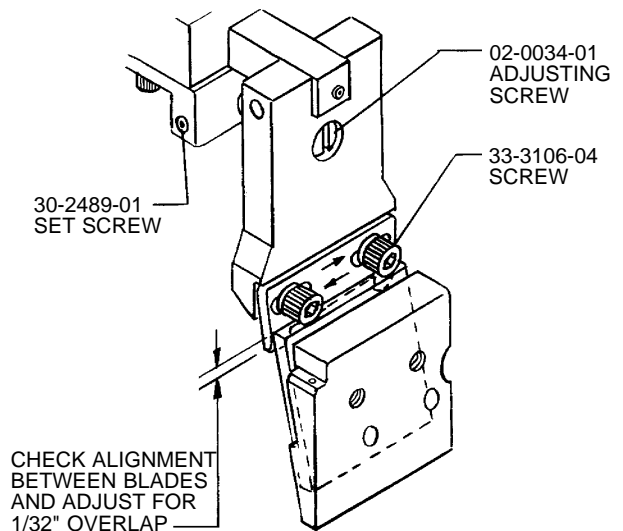

NOTES:

1. LOOSEN SCREW 01-3051-01 AND 33-3108-08 AND ROTATE ASSEMBLY FOR PROPER ENGAGEMENT.
2. LOOSEN SCREWS 33-3106-08 AND ADJUST MOVABLE BLADE AGAINST STATIONARY BLADE AND LOCK IN PLACE.

NOTE:

LOOSEN SET SCREW 30-2489-01 AND ADJUST SCREW 02-0034-01 COUNTER-CLOCKWISE FOR MORE CUTTING EDGE ENGAGEMENT.

AIR CIRCUIT DIAGRAM

INS-2664

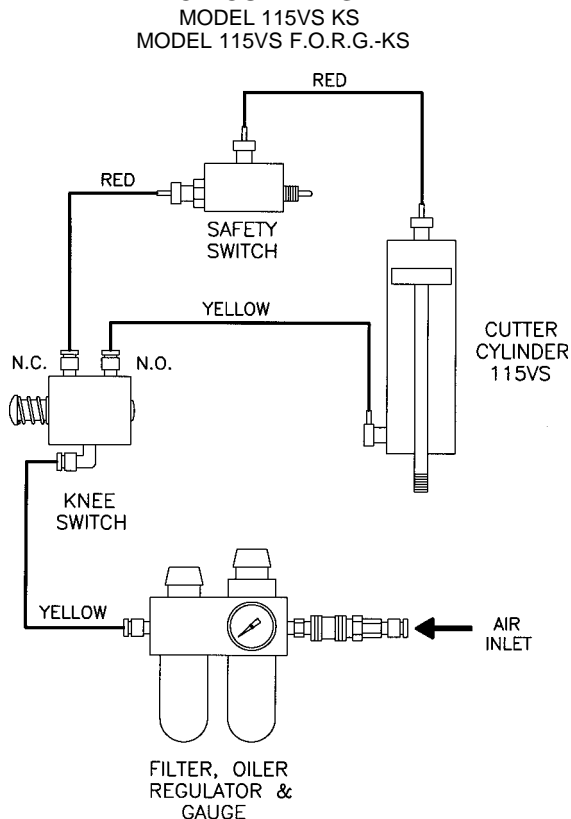

**4 WAY AIR VALVE, KNEE OPERATED
80-0185-01**

INS-619-1A

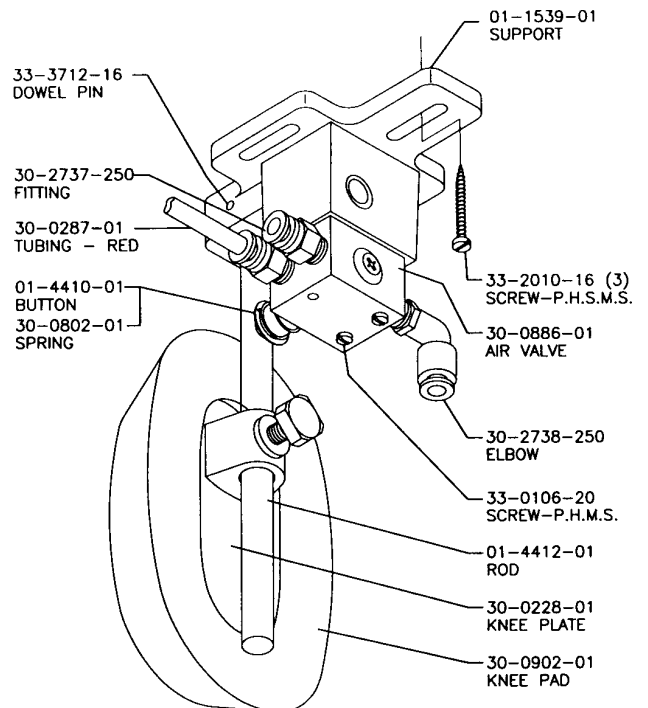

PARTS LIST
 MODEL 115VS-FOTA
 YAMATO FD-62
 80-0486-05

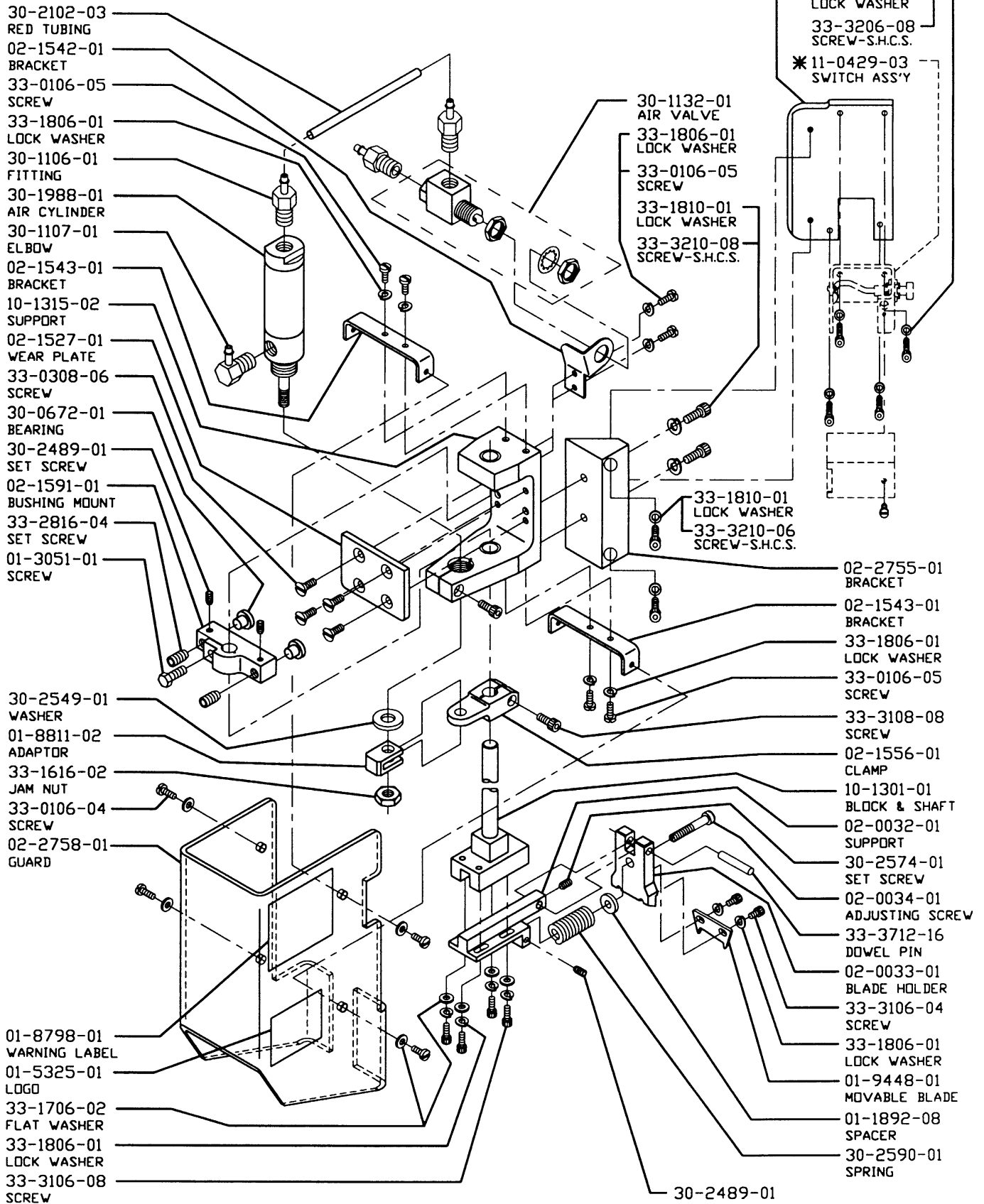

* NOT PART OF 80-0486-05 ASSEMBLY