

MDE Semiconductor, Inc.

78-150 Calle Tampico, Unit 210, La Quinta, CA., USA 92253 Tel : 760-564-8656 • Fax : 760-564-2414
 1-800-831-4881 [Email: sales@mdesemiconductor.com](mailto:sales@mdesemiconductor.com) Web: www.mdesemiconductor.com

Transient Tamer™ MOV

High Energy Thermally Protected TTxxxMOV VOLTAGE-150 to 690 Volts AC Integrated Transient Surge Protector

FEATURES

Surge Protective Device Component with thermal protection designed to open in the event of overheating due to an abnormal over-voltage, with High Fault Current.

- Quick response and MOV cutoff function with disconnecter and arc extinguishing device (Patent Pending).
- Wide operating temperature range (-40°C to + 85°C).
- High surge current capability.
- Low leakage current.
- Two way failure indicator when TTxxxMOV has been disconnected from the circuit.
 1. The Isolated Normally Open switch terminals can be connected to a monitoring circuit.
 2. A red indicator extends thru the top and provides a visual indication
- Application in AC mains, service entrance, and heavy industrial etc.
- All products have a SCCR rating of 200 kA rms
- All products approved to UL1449 3rd Edition, Type 4 tested to Type 1 or 2 Listed to UL and CSA file # E337840

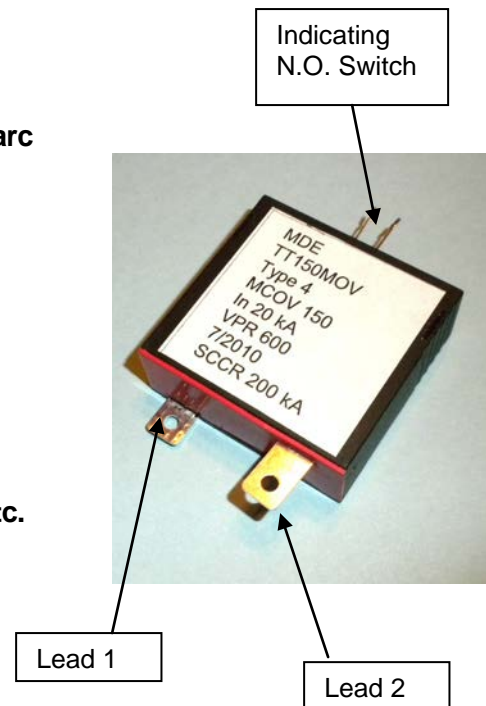

Component for PCB Mounting

Type	Continuous MCOV		Max Peak Current I _{max} (kA)	Test Current I _n (kA)	Rating VPR rating	Energy (2ms) WTM (J)	Varistor Voltage		Max Clamping Voltage	
	V _{rms} (V)	V _{dc} (V)					V _{1mA} (V)	ΔV _{1mA} (%)	V _C (V)	I _p (A)
TT150MOV	150	200	50	20	600	360	240	±10	395	300
TT275MOV	275	350	50	20	900	550	430	±10	710	300
TT320MOV	320	415	50	20	1200	640	510	±10	850	300
TT420MOV	420	560	50	20	1500	910	680	±10	1120	300
TT550MOV	550	745	50	20	1800	960	910	±10	1500	300
TT690MOV	690	910	40	20	2500	1100	1100	±10	2000	300

MDE Semiconductor, Inc.

TTxxxMOV

Mechanical layout

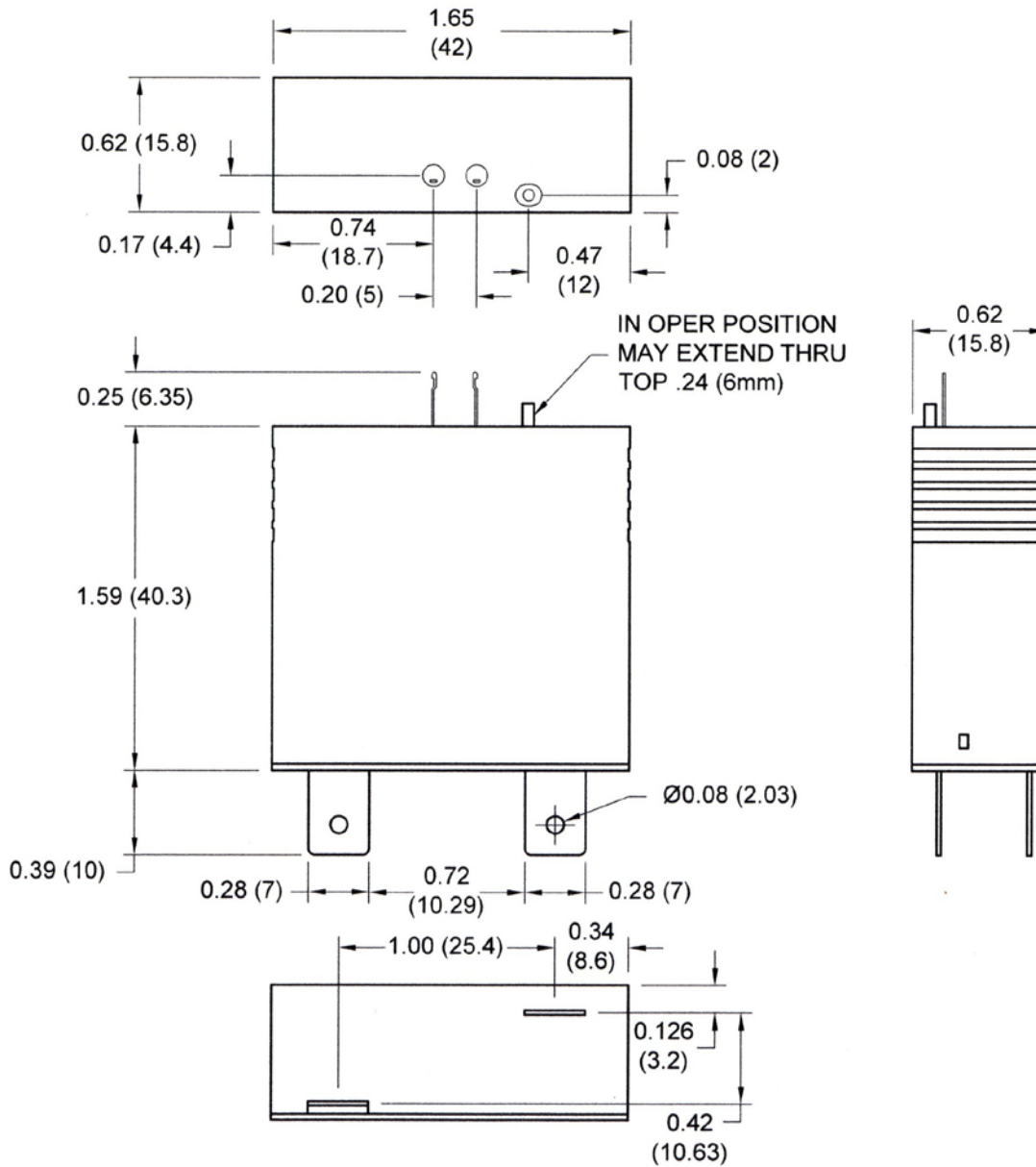

DIMENSIONS ARE IN inch (mm)

MDE Semiconductor, Inc.

TTxxxMOV

PCB Layout

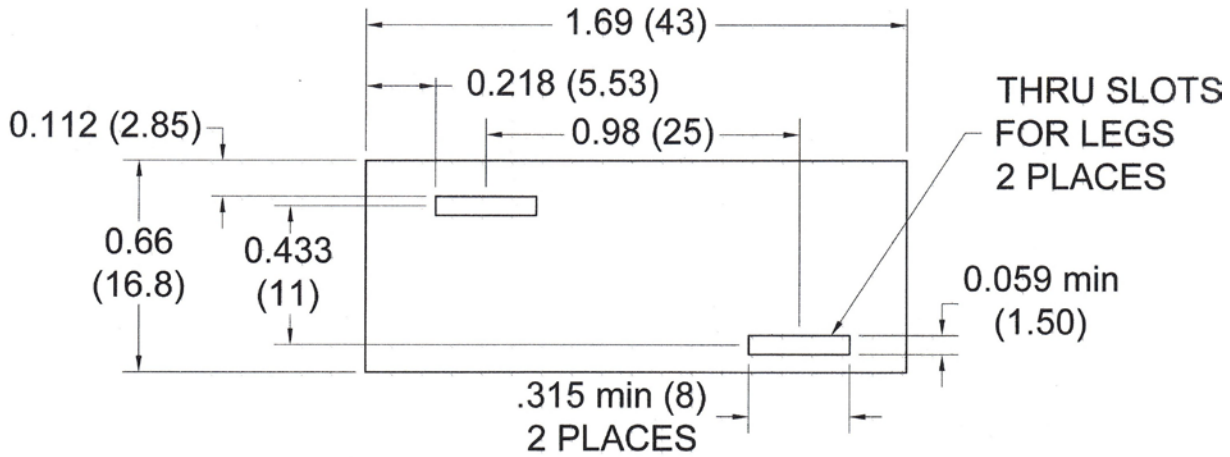

**BOARD LAYOUT DIMENSIONS
DIMENSIONS ARE IN inch (mm)**

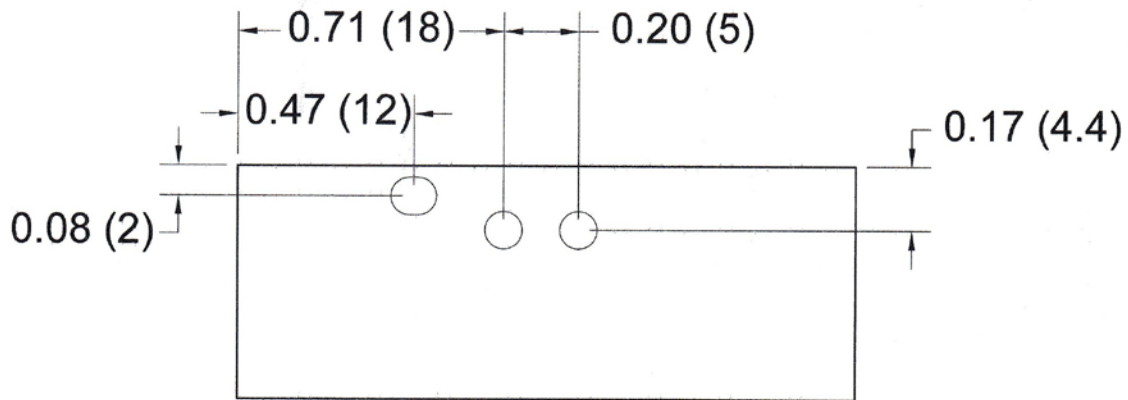

**MONITOR LAYOUT DIMENSIONS
DIMENSIONS ARE IN inch (mm)**