

MAC CORPORATION'S STATIONARY

Compactors

MAC 220



STANDARD FEATURES

- Key-lock Start Switch
- Power Unit Weather Cover
- Reverse Push Button
- Power Unit Factory Ready for 208-230-460 Volt 3 phase
- Red Mushroom-head Stop Button
- Automatic Motor Starter Reset
- Solid State Motor Starter Overload
- Adjustable 9-45 Amp
- NEMA 12/13 Panel Box

MAC
CORPORATION



QUALITY

By implementing the highest quality steel fabrication and welding techniques, MAC Corporation's stationary compactors are designed and engineered to efficiently and economically handle maximum loads and stresses in commercial and medium industrial situations.

SAFETY

The MAC 250 features industrial grade electrical and hydraulic systems and conforms to all ANSI codes and safety requirements.

OPTIONAL FEATURES

Compactors can be built for your specific needs with custom-fitted side or rear load hoppers, security chutes drive on decks and other optional equipment.

INDUSTRY EXPERTISE

Specializing exclusively in the manufacturing of refuse equipment, MAC Corporation provides over a century of combined experience in the industry. MAC Corporation provides quality equipment with cost-saving benefits.



4717 Massachusetts Avenue
 Indianapolis, Indiana 46218
 Telephone **317-545-3341**
 Toll Free 1-800-447-5205
 Fax 317-545-8760

SPECIFICATIONS

MAC 220	
Mfr. Rating	2 cubic yards
Industry Rating	1.44 cubic yards
Clear Top Opening	58" x 42"
Hydraulic Cylinders	(2) 4-1/2" bore x 2-1/2" rod
Ram Penetration	14"
Packing Force	Normal: 50,300 lbs. Maximum Pack-Out: 54,300 lbs.
Ram Face PSI	Normal: 27.94 PSI Maximum: 30.16 PSI
Hydraulic Pressure	Normal: 1850 PSI Maximum: 2000 PSI
Ram Face Dimensions	30" x 60"
Cycle Time	51 seconds
Motor	10 H.P. TEFC
Pump	10 GPM vane
Frame Floor	3/8" plate
Frame Sides	3/8" plate
Breaker Bar	8" x 6" x 3/4" angle
Ram Face	1/2" plate
Ram Floor	1/2" plate
Ram Top	1/4" plate
Ram Sides	1/4" plate
Ram Guides (4)	UHMWPE

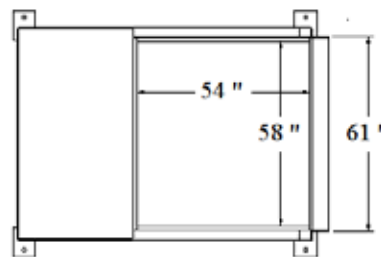

Top View

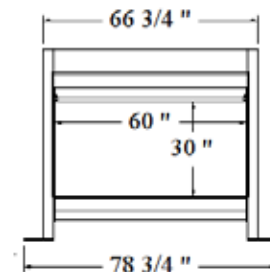

Front View

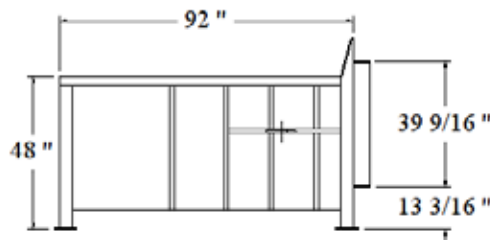

Side View

Pictures are for illustration only. Specifications are subject to change without notice to accommodate design changes. All compactors comply with ANSI regulations, OSHA standards, and all electrical components are UL certified.