

Soils Map

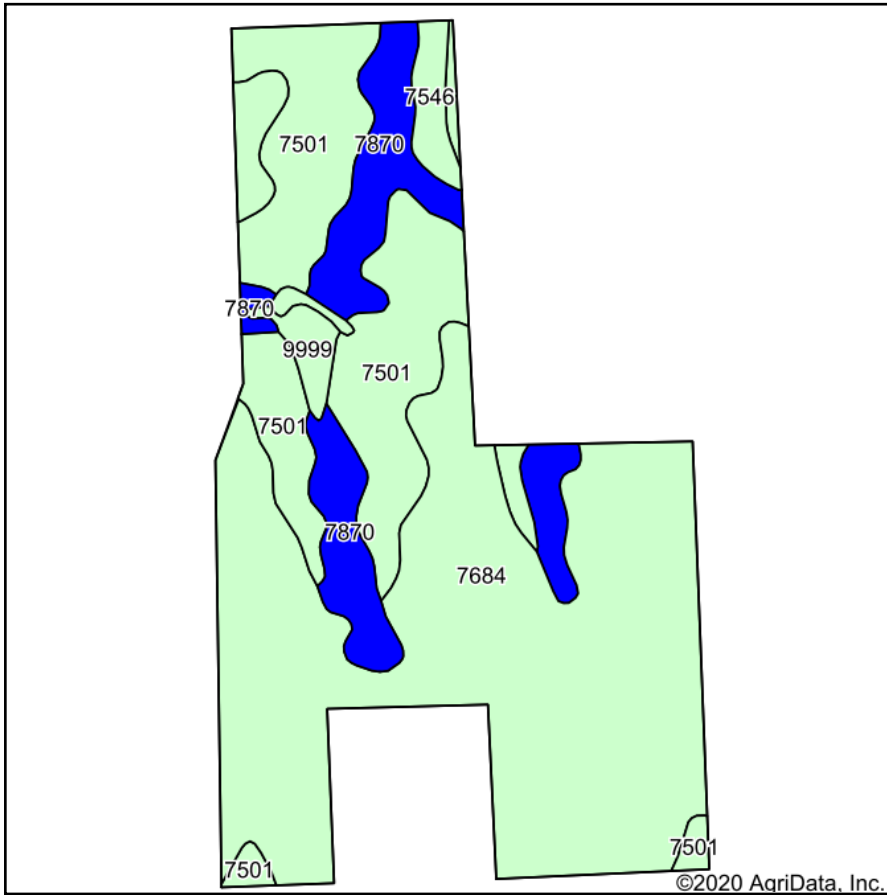

Soils data provided by USDA and NRCS.

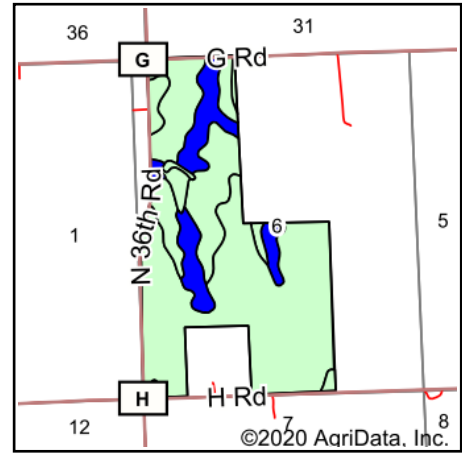

State: **Nebraska**
 County: **Otoe**
 Location: **6-8N-12E**
 Township: **Delaware**
 Acres: **233.31**
 Date: **7/6/2020**



Area Symbol: NE131. Soil Area Version: 19										
Code	Soil Description	Acres	Percent of field	Non-Irr Class Legend	Non-Irr Class *c	Irr Class *c	Range Production (lbs/acre/yr)	SRPG	*n NCCPI Soybeans	
7684	Wymore silty clay loam, 3 to 6 percent slopes, eroded	135.32	58.0%		IIIe	IVe	3563	70	49	
7501	Pawnee clay loam, 4 to 8 percent slopes, eroded	59.03	25.3%		IIIe		3188		35	
7870	Nodaway-Colo complex, occasionally flooded	29.86	12.8%		IIw	IIw	4808	70	82	
7546	Shelby and Burchard clay loams, 11 to 17 percent slopes	4.54	1.9%		IVe		3400	58	54	
9999	Water	3.56	1.5%				0	0	0	
9971	Arents, earthen dam	1.00	0.4%		VIII		0		0	
Weighted Average								3554.7	50.7	*n 48.8

*n: The aggregation method is "Weighted Average using major components"

*c: Using Capabilities Class Dominant Condition Aggregation Method

Soils data provided by USDA and NRCS.