

Mapleton
 Name: CAMPBELL, RONALD S. JR
 CAMPBELL, JUDY L.

Valuation Report

08/01/2019

Page 1

Account: 2055 Card: 1 of 1

Map/Lot:
 Location:

012-026-B
 44 HAYNES RD

Neighborhood 1 7000 Schedule

Zoning/Use Residential-Farm
 Topography LevelRolling
 Utilities Public WaterDrilled Well
 Street Paved

Sale Data
 Sale Date 05/25/2017
 Sale Price 74,300
 Sale Type Land & Buildings
 Financing Conventional
 Verified Public Record
 Validity Related Parties

Reference 1
 Reference 2 B5079P103
 Tran/Land/Bldg 2 1 9
 FLOOD MAP & 0 SHORELAND ZONE 0
 Exemption(s) Land Schedule 1

Land Description

Units	Method - Description	Price/Unit	Total	Fctr	Influence	Value
1.00	Acres-Homesite	8,400.00	8,400	100%		8,400
1.00	Acres-Secondary 1	1,500.00	1,500	100%		1,500
3.70	Acres-Secondary 2	700.00	2,590	100%		2,590
1.00	# -Lot Improvements	7,500.00	7,500	100%		7,500
Total Acres 5.70			Land Total			19,990

Outbuildings/Additions/Improvements

Description	Year	Units	Grade	RCN	Cond	Percent Good			Value Rcnld
						Phy	Func	Econ	
Double Wide Moho	2013	27X44	C 100	43,392	Good	81%	100%	100%	35,364
Camper	2013			---- S O U N D V A L U E ----				1,500	
Frame Shed	2013			---- S O U N D V A L U E ----				500	
Frame Garage	1996	600	C 100	10,028	Avq+	86%	100%	100%	8,624
Concrete Slab	1996	600	C 100	1,827	Avq.	82%	100%	100%	1,498
Concrete Slab	1994	1620	C 100	4,933	Avq.	81%	100%	100%	3,996
Wood Deck	2012	144	C 100	752	Avq.	91%	100%	100%	684
Wood Deck	1997	180	C 100	940	Avq-	72%	100%	100%	677
1,188 SFLA		Field1				Outbuilding Total			52,843

Acpt Land 20,000 **Accepted Bldg** 52,800 **Total** 72,800

Mapleton
Name: CAMPBELL, RONALD S. JR
CAMPBELL, JUDY L.
Account: 2055

Valuation Report

Map/Lot:
Location:

08/01/2019
Page 2
012-026-B
44 HAYNES RD

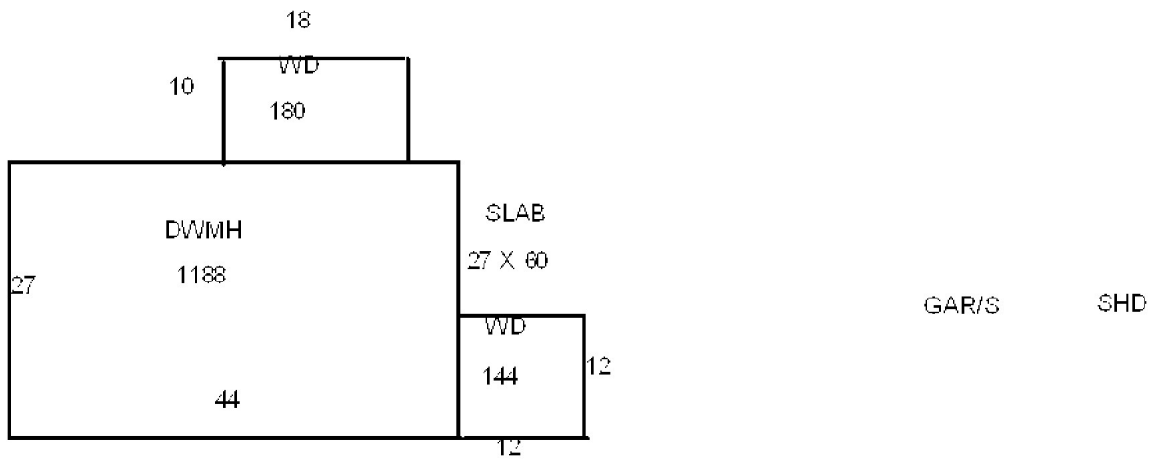

CMPR