



SAND TIGER Mk II

PRODUCT DESCRIPTION

DHI's SAND TIGER II™ is designed to handle liquid solid separation at the flowback site. Equipped with 8 inch gas diffusers and a proprietary design which separates oil sand and water effectively reducing many costs on the flowback location.

Single speed system, no need for variable speed drive.

Electrical connections and components are all Class 1 Div. 2 for for well site applications in all zones.

The drag chain conveyer is designed to have no shear resistance with the return chain travelling above the effluent levels. This reduces the opportunity of fouling at high solid flow rates.

Anti clog design prevents sand build up during high flow rates that can stall the system.

Protection devices prevent catastrophic damage.

- Torque limiter
- Motor protection

FEATURES AND BENEFITS

- Reduced cost of sand disposal.
- Clean sand separated from liquids
- Easy access fluid level measurement
- Easy access walkways
- High efficiency gas buster



General Parameters

Dimensions	45' x 8'6" x 13'11"	
Power Unit	5 HP 1,200 ft.lb torque	Chain drive at 40'ft/min
Maximum Liquid Flow Rate	10,000 BBL/D	Combined Liquids
Solid Handling Process	350,000 lb/day	Sand flow rate (Dry Weight)
Electrical Connections	Class 1 Div 2 (Ex)	NEMA junction boxes and connectors
Separation	Liquid / Solids	Sand and Solids are dumped from the rea
Gas Diffuser	Dual 8" x 10 ft	Perforated dual compartment gas buster
Conveyer	15" x 20' @ 40°	Hardened steel 40ft/min speed.



Sand Removal Process

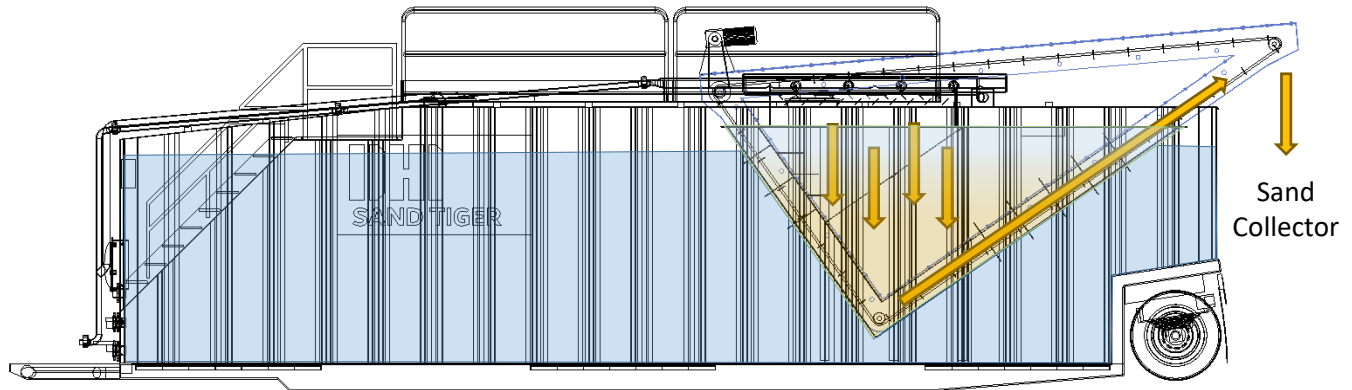

- Liquids and solids feed into the hopper section of the tank that feed liquids to a spill over weir and solids are removed from the bottom bay by the conveyor.
- Chain link drag conveyor is designed to pull solids up the conveyor the sand and debris are cleaned in the process, water drains back into the hopper continuously and sand is discharged out of the top into collection bins.
- The gas busters feeding the sand collection hopper are designed to minimize spray and are a dual chamber two stage diffusion configuration
- Liquids spill out of the hopper into the main tank that can be connected to adjacent tanks for additional storage and recycling.

Safety

Access walkways all protected by 42" hand rails

Electricals are all intrinsically safe.

Motor protection to prevent any overheating and working outside of parameters.

Benefits

Reduces the cost of sand disposal

Sand may be repurposed

Reduces tank cleaning costs