

**INSTALLATION INSTRUCTIONS
INSTALLATION OF RUE RING, ICE BEVERAGE DISPENSER
AGITATOR BAR RETAINING PIN**

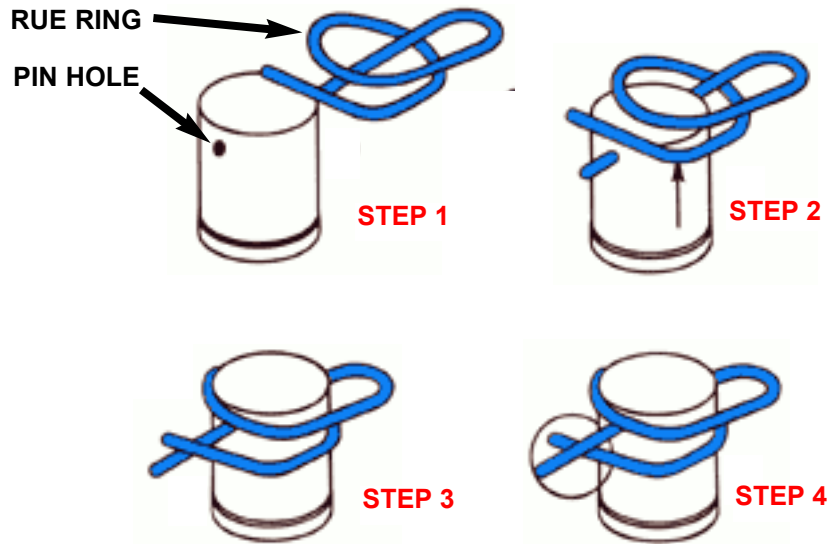

1. PROCEDURE

1.1 INSTALLATION

- A. Insert straight part of Rue Ring through hole in side of Pin (see Step 1 above).
- B. Wrap circular part of Rue Ring over end of Pin (see Steps 2 and 3 above).
- C. Lock Rue Ring with straight part over bent portion of Rue Ring as shown on Step 4 above.
- D. Insert Retaining Pin through the Paddle Wheel, Agitator Bar, and the Motor Shaft.
- E. Install other Rue Ring onto other end of Retaining Pin in the same manner.

1.2 REMOVAL

- A. To remove, do steps in reverse order.

Please refer to the Lancer web site (www.lancercorp.com) for information relating to Lancer Installation and Service Manuals, Instruction Sheets, Technical Bulletins, Service Bulletins, etc.

LANCER 6655 LANCER BLVD. • SAN ANTONIO, TEXAS 78219 USA • (210) 310-7000

FAX SALES
• NORTH AMERICA – 210-310-7245 • INTERNATIONAL SALES – 210-310-7242 • CUSTOMER SERVICE – 210-310-7242 •
• LATIN AMERICA – 210-310-7245 • EUROPE – 32-2-755-2399 • PACIFIC – 61-8-8268-1978 •

FAX ENGINEERING: • 210-310-7096
"Lancer" is the registered trademark of Lancer
Copyright • 2003 by Lancer, all rights reserved.

**REV 10/30/03
Lancer P.N.28-0563**

**INSTALLATION INSTRUCTIONS
INSTALLATION OF RUE RING, ICE BEVERAGE DISPENSER
AGITATOR BAR RETAINING PIN**

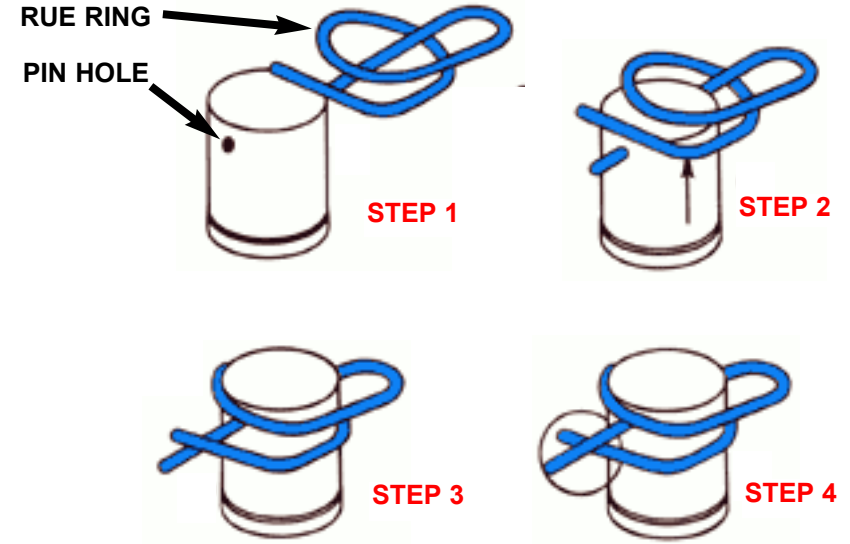

1. PROCEDURE

1.1 INSTALLATION

- A. Insert straight part of Rue Ring through hole in side of Pin (see Step 1 above).
- B. Wrap circular part of Rue Ring over end of Pin (see Steps 2 and 3 above).
- C. Lock Rue Ring with straight part over bent portion of Rue Ring as shown on Step 4 above.
- D. Insert Retaining Pin through the Paddle Wheel, Agitator Bar, and the Motor Shaft.
- E. Install other Rue Ring onto other end of Retaining Pin in the same manner.

1.2 REMOVAL

- A. To remove, do steps in reverse order.

Please refer to the Lancer web site (www.lancercorp.com) for information relating to Lancer Installation and Service Manuals, Instruction Sheets, Technical Bulletins, Service Bulletins, etc.

LANCER 6655 LANCER BLVD. • SAN ANTONIO, TEXAS 78219 USA • (210) 310-7000

FAX SALES
• NORTH AMERICA – 210-310-7245 • INTERNATIONAL SALES – 210-310-7242 • CUSTOMER SERVICE – 210-310-7242 •
• LATIN AMERICA – 210-310-7245 • EUROPE – 32-2-755-2399 • PACIFIC – 61-8-8268-1978 •

FAX ENGINEERING: • 210-310-7096
"Lancer" is the registered trademark of Lancer
Copyright • 2003 by Lancer, all rights reserved.

**REV 10/30/03
Lancer P.N.28-0563**