

INCA Kitchen Bath Inc

T: 818-392-7863

F: 818-392-7923



# Cabinet Catalog

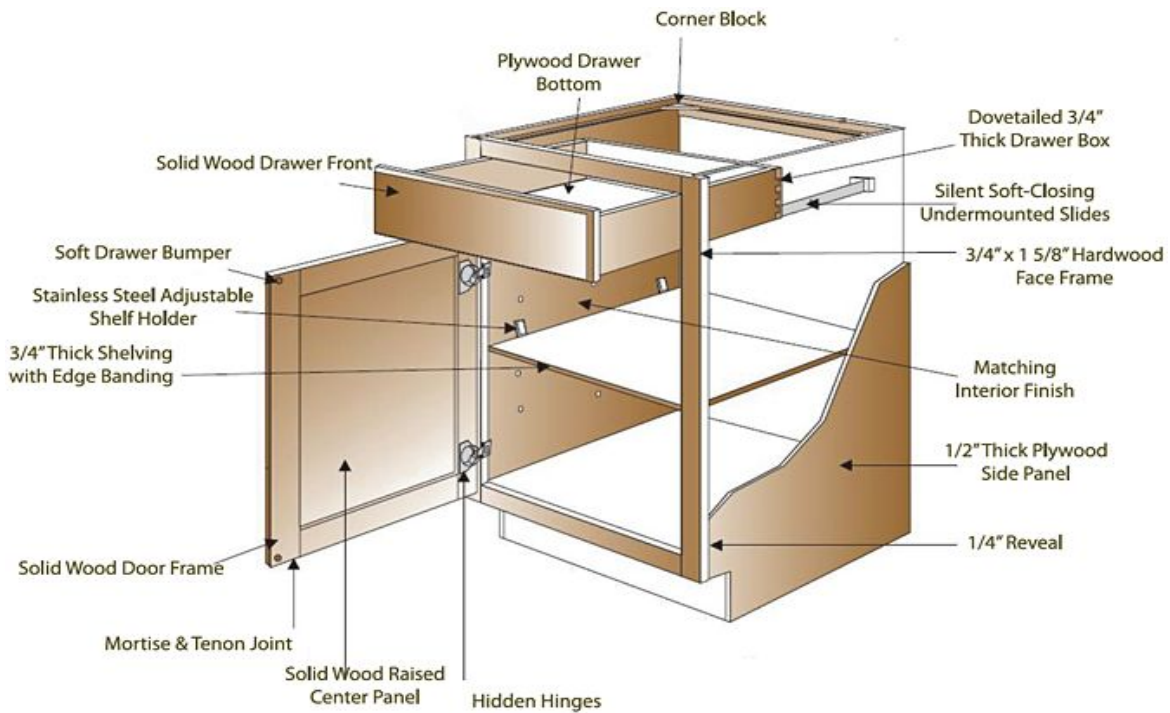

# Understanding Our Cabinet Guide

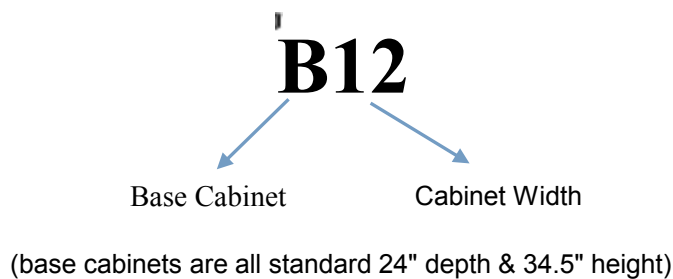
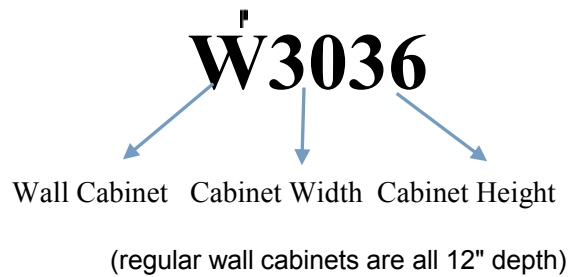

## **A few basics about cabinet dimensions:**

Wall cabinet widths and heights range from 9" to 42" and increase in 3 inch increments.

Base cabinets are 34.5" high and range in width from 9" to 42" increasing in 3 inch increments. each base cabinet has a toe kick area.

Tall cabinets are usually 84", 90", or 96" high, 24" deep and available in 18" 24" and 30" wide. They include a toe kick area.

# INCA Kitchen Bath Inc

T: 818-392-7863

F: 818-392-7923

## Wall cabinet -----Single Door

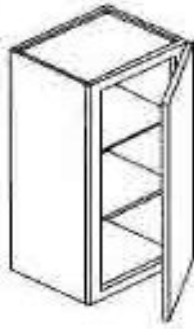

Item	width	height	depth	shelf
W0930	9	30	12	2
W1230	12	30	12	2
W1530	15	30	12	2
W1830	18	30	12	2
W2130	21	30	12	2
W0936	9	36	12	2
W1236	12	36	12	2
W1536	15	36	12	2
W1836	18	36	12	2
W2136	21	36	12	2

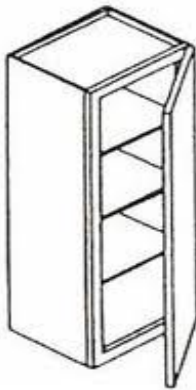

Item	width	height	depth	shelf
W0942	9	42	12	3
W1242	12	42	12	3
W1542	15	42	12	3
W1842	18	42	12	3
W2142	21	42	12	3

## Wall cabinet----- Double Door



Item	width	height	depth	shelf
W2430	24	30	12	2
W2730	27	30	12	2
W3030	30	30	12	2
W3330	33	30	12	2
W3630	36	30	12	2
W2436	24	36	12	2
W2736	27	36	12	2
W3036	30	36	12	2
W3336	33	36	12	2
W3636	36	36	12	2

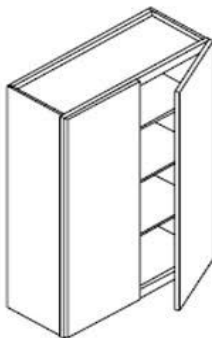

Item	width	height	depth	shelf
W2442	24	42	12	3
W2742	27	42	12	3
W3042	30	42	12	3
W3342	33	42	12	3
W3642	36	42	12	3

# INCA Kitchen Bath Inc

T: 818-392-7863

F: 818-392-7923

Bridge Wall cabinet-----double door -----no shelf

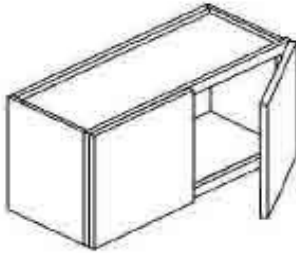

Item	width	height	depth	shelf
W3012	30	12	12	0
W3015	30	15	12	0
W3018	30	18	12	0
W3612	36	12	12	0
W3615	36	15	12	0
W3618	36	18	12	0

Bridge Wall cabinet-----double door -----1 shel

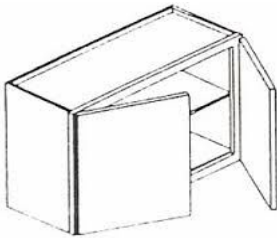

Item	width	height	depth	shelf
w3021	30	21	12	1
w3024	30	24	12	1
w3621	36	21	12	1
w3624	36	24	12	1

Referagerator cabinet-----double door-----24" depth

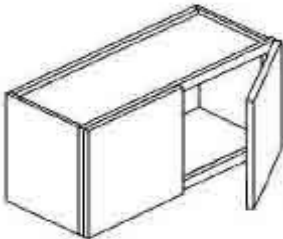

Item	width	height	depth	shelf
W361224	36	12	24	0
W361524	36	15	24	0
W361824	36	18	24	0
W362124	36	21	24	1
W362424	36	24	24	1

Wall Dignal Cabinet

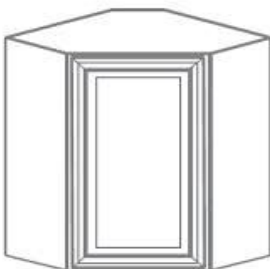

Item	width	height	depth	shelf
WDC2430	24	30	24	2
WDC2436	24	36	24	2
WDC2442	24	42	24	3

# INCA Kitchen Bath Inc

T: 818-392-7863

F: 818-392-7923

## Wall End Shelf Cabinet



Item	width	height	depth	shelf
WES1230	12	30	12	3
WES1236	12	36	12	4
WES1242	12	42	12	4

## Wall Wine Rack

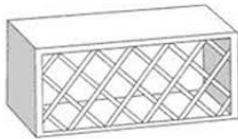

Item	width	height	depth	shelf
WWR3015	30	15	12	

## Glass Rack

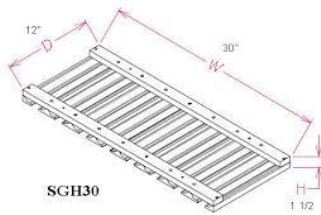

Item	width	height	depth	shelf
SGH30	30	1.5	12	

## Base Spicy Rack

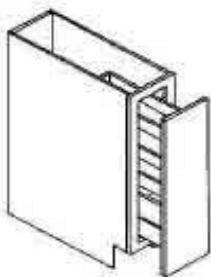

Item	width	height	depth	shelf
BSR09	9	34.5	24	3

# INCA Kitchen Bath Inc

T: 818-392-7863

F: 818-392-7923

Base cabinet      1 drawer   1 door

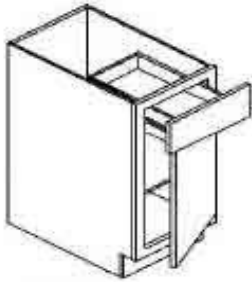

Item	width	height	depth	shelf
B09	9	34.5	24	1
B12	12	34.5	24	1
B15	15	34.5	24	1
B18	18	34.5	24	1
B21	21	34.5	24	1

Base cabinet      1 drawer   2 doors

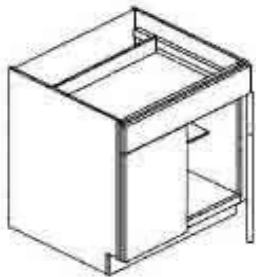

Item	width	height	depth	shelf
B24	24	34.5	24	1
B27	27	34.5	24	1
B30	30	34.5	24	1
B33	33	34.5	24	1

Base cabinet      2 drawers   2 doors

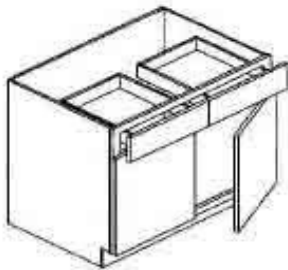

Item	width	height	depth	shelf
B36	36	34.5	24	1
B42	42	34.5	24	1

Sink Base Cabinet

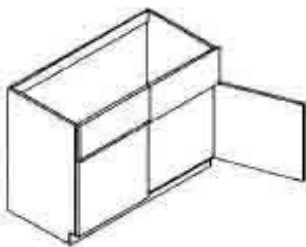

Item	width	height	depth	shelf
SB33	33	34.5	24	none
SB36	36	34.5	24	none
SB42	42	34.5	24	none

# INCA Kitchen Bath Inc

T: 818-392-7863

F: 818-392-7923

## Drawer Base Cabinet

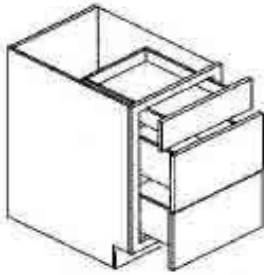

Item	width	height	depth	shelf
DB12	12	34.5	24	none
DB15	15	34.5	24	none
DB18	18	34.5	24	none
DB21	21	34.5	24	none
DB24	24	34.5	24	none
DB27	27	34.5	24	none
DB30	30	34.5	24	none

## Blind Base Corner Cabinet



Item  
BBC36-42

## Base Lazy Susan Cabinet

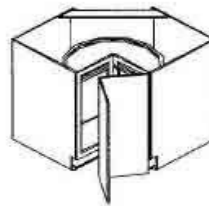

Item  
BLS33  
BLS36

## Base End Shelf---left side

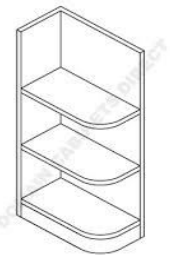

Item  
BES12-L

## Base End Shelf-----right side

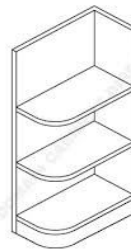

Item  
BES12-R

## Base Trash Can Cabinet

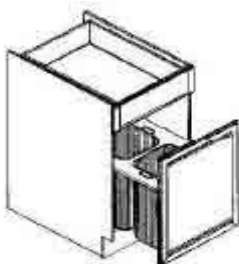

Item  
BTC18

## Roll Out Tray

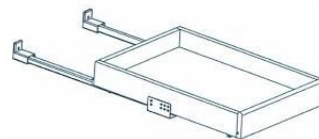

Item  
ROT18  
ROT21  
ROT24  
ROT27  
ROT30  
ROT33  
ROT36

# INCA Kitchen Bath Inc

T: 818-392-7863

F: 818-392-7923

## Pantry Cabinets

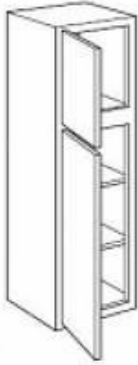

Item	width	height	depth	shelf
PC1884	18	84	24	3
PC1890	18	90	24	4
PC1896	18	96	24	4

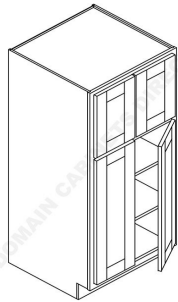

Item	width	height	depth	shelf
PC2484	24	84	24	3
PC2490	24	90	24	4
PC2496	24	96	24	4
PC3084	30	84	24	3
PC3090	30	90	24	4
PC3096	30	96	24	4

## Double Oven Cabinet



Item	width	height	depth	open space
DOC3084	30	84	24	
DOC3090	30	90	24	
DOC3096	30	96	24	
DOC3384	33	84	24	
DOC3390	33	90	24	
DOC3396	33	96	24	



# INCA Kitchen Bath Inc

T: 818-392-7863

F: 818-392-7923

Vanity Drawer Base Cabinet----32" height----21"depth---non soft closed



Item	width	height	depth
VD12	12	32	21
VD15	15	32	21
VD18	18	32	21
VD21	21	32	21

Note: CS & HS & WS vanity is 34.5" height and soft-closed rail

Vanity Sink Base Cabinet----32" height----21"depth---non soft closed



Item	width	height	depth
VSB24	24	32	21
VSB27	27	32	21
VSB30	30	32	21
VSB36	36	32	21

Note: CS & HS & WS vanity is 34.5" height and soft-closed rail

Vanity with 3 Drawers on your right side  
32" height----21"depth---non soft closed



Item  
VSD36-3R  
VSD42-3R

Vantiy with 3 drawers on your left side  
32" height----21"depth---non soft closed



Item  
VSD36-3L  
VSD42-3L

Note: 24" sink on VSD36; 27" sink on VSD42

Note: CS & HS & WS vanity is 34.5" height and soft-closed rail

Vanity with 3 Drawers in the middle  
32" height----21"depth---non soft closed



Item  
VCD60

Vanity with 3 drawers on both side  
32" height----21"depth---non soft closed



Item  
VDD60

Note: sink is 24", drawer is 12"

Note: CS & HS & WS vanity is 34.5" height and soft-closed rail

Note: sink is 30"width, drawer is 15" width

# INCA Kitchen Bath Inc

T: 818-392-7863

F: 818-392-7923

**Base Filler**



Item  
BF3  
BF6

**Wall Filler**



Item  
WF330  
WF336  
WF342  
WF642

**Tall Filler** TF396

**Rosette Fluted Wall Filler**



Item  
RWF330  
RWF336  
RWF342

**Toe Kick**



Item  
TK8

**Crown Molding----8' L**

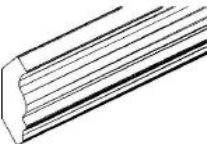

Item  
CM8 2.5  
CM8 4.5

Note: CM8 2.5 available in all color  
CM8 4.5 available in ES;GS;CS;CW

**Crown Molding with Rope Design----8'Long**



Item  
CMR8 4.5

Note: only available in MR;PR

**Flat Molding**



Item  
FM8 4.5

Note: only available in HS; ES

**Crown Molding with Dental Design**



Item  
CMD8 4.5

**Scribe Molding**



Item  
SM8

**Outside Molding**



Item  
OC8

# INCA Kitchen Bath Inc

T: 818-392-7863

F: 818-392-7923

**Quarter Rould Molding**

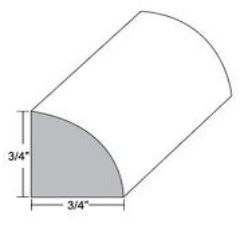

Item  
QR8

**Light Rail Molding**

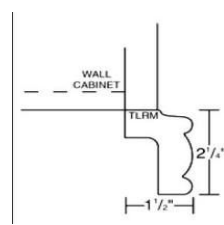

Item  
LR8

**Ogee Molding**

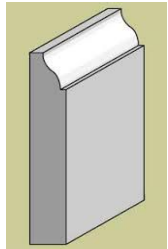

Item  
OG8 4.5

**Refrigerator End Panel--with 1.5" front filler**

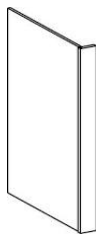

Item  
REF 1.5

Note: 24" depth x 96" height

**Skin Panel**

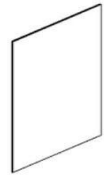

Item  
TEP9636

Note: 36" width x 96" Height x 1/4" thick

**Refrigerator End Panel-----flat panel**



Item  
REF 0.75

Note: 24" depth x 96" height x 3/4" thick

**Dish Washer Panle 3" Front Filler**

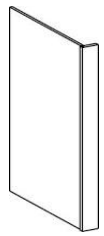

Item  
DWR3

**Turning Post**

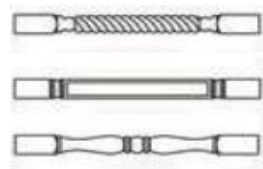

Item  
P3  
PS9-3  
Spool

**Corble**



Item  
C1958  
C1962

**Valance**



Item  
VAL36  
VAL42  
VAL60