

VICINITY MAP  
NTS

BOUNDARY SURVEY OF PRN 5012  
BOYDTON MAGISTERIAL DISTRICT  
MECKLENBURG COUNTY, VIRGINIA

Countryside Service Company, L.C.  
28 IMPERIAL DRIVE • STAUNTON • VIRGINIA • 24401  
PHONE (540) 886-6155 • FAX (540) 886-6154

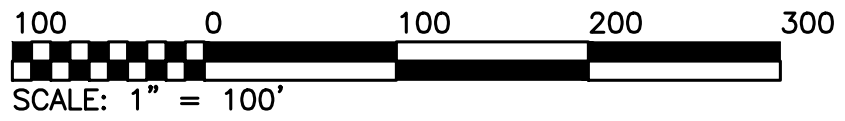

- NOTES:**
1. THIS SURVEY HAS BEEN PREPARED WITHOUT THE BENEFIT OF A TITLE REPORT AND DOES NOT NECESSARILY INDICATE ALL ENCUMBRANCES UPON THE TITLE.
  2. THESE PROPERTIES ARE IN ZONES A AND X, AS SHOWN ON FIRM MAP FOR FRANKLIN, VIRGINIA, MAP NO. 51117C0275C DATED SEPTEMBER 11, 2009.
  3. THE BUILDINGS ARE SHOWN WITHIN 50' OF THE NEWLY CREATED PROPERTY LINES.
  4. THIS SITE DOES NOT CONTAIN ANY VISIBLE GRAVES OR PLACES OF BURIAL. (CEMETERY SHOWN NEAR EASTERLY CORNER OF PROPERTY)
  5. THIS PLAT HAS BEEN PREPARED FROM AN ACTUAL FIELD SURVEY DONE AS PER DATE OF THIS PLAT AND ALL EASEMENTS THAT ARE EVIDENT ARE SHOWN ON THIS PLAT.
  6. THIS PLAT IS BASED ON THE SAME PROPERTY ACQUIRED BY COUNTRYSIDE LAND COMPANY, LC, INSTRUMENT # 210000703.

**SURVEYOR'S CERTIFICATION:**  
I, TIMOTHY B. BUTLER, A DULY LICENSED LAND SURVEYOR IN THE COMMONWEALTH OF VIRGINIA, DO HEREBY CERTIFY THAT THIS PLAT WAS PREPARED IN ACCORDANCE WITH THE STANDARDS AND PROCEDURES ESTABLISHED BY THE VIRGINIA STATE BOARD OF ARCHITECTS, PROFESSIONAL ENGINEERS, LAND SURVEYORS, CERTIFIED INTERIOR DESIGNERS, AND LANDSCAPE ARCHITECTS.

TIMOTHY B. BUTLER, LS  
COUNTRYSIDE SERVICE COMPANY, LC

SCALE: AS SHOWN  
DESIGNED: NDK  
CHECKED: TBB

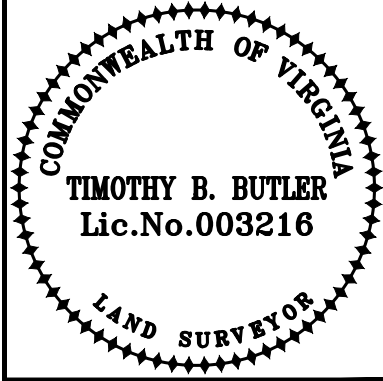

DATE: 2/11/2021