

Nominal diameter		main dimensions(mm)				
inch	DN	L	H	D	T	d
1/2"	15	79	61	21.8	9.6	9
3/4"	20	92	61	27.1	12.7	13

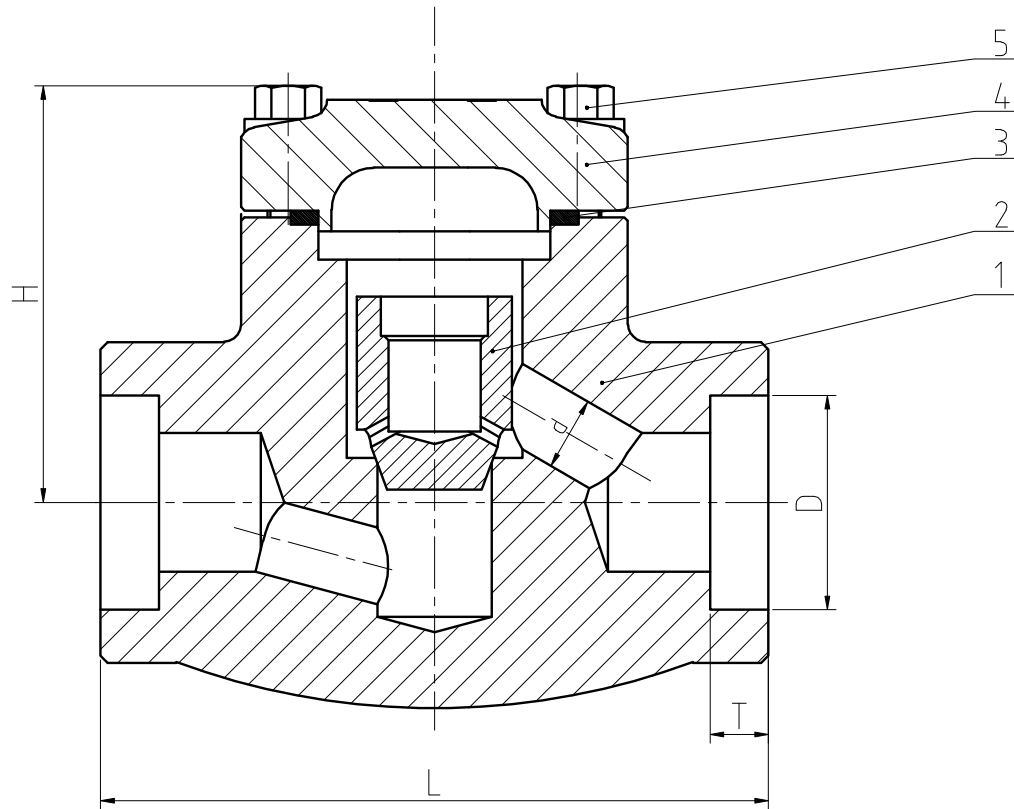

Specification			
Class		800LB	
test pressure	strength test	215	MPa
	sealing test	15.5	
	air sealing test	0.6	
max.working temp.		≤200℃	
suitable media: water,steam,oil			
Technical Requirement			
Construction design conform		BS 5352	
Socket welded dimension conform		ASME B16.11	
Face to face conform		ASME B16.10	
Inspecting &testing accord		API 598	

5	Bolt	4	A193 B8M
4	Bonnet	1	F316
3	Gasket	1	316+Graphite
2	Disc	1	316
1	Body	1	F316
NO.	Name	QTY	Material

Check Valve			Fig No	
Design			H61W-800LB	
Checked			Drawing NO	
Standard			REV	
Approved				