

# UniCure

Spraybooths

## Paint Mixing Room ES8X8MR

The UniCure ES8X8MR is an economical model that assembles easily. It is constructed of 18 gauge galvanized steel panels and comes with all the necessary fasteners and sealing materials. The personnel door is 3'0" and includes a window.

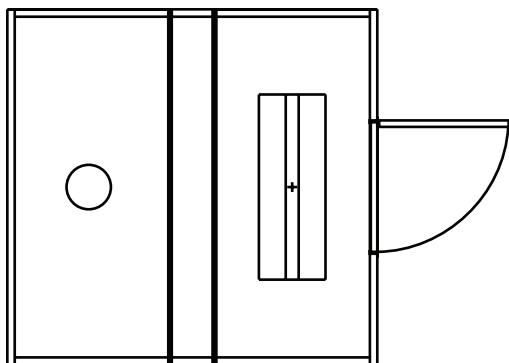

**TOP VIEW**

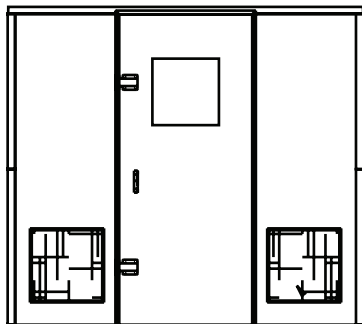

**FRONT VIEW**

### Outside Dimensions

Length: 8'-0"  
Width: 8'-0"  
Height: 7'-2"

### Inside Dimensions

Length: 7'-8"  
Width: 7'-8"  
Height: 7'-0"

# e-Spray

by UniCure  
*economy made easy!*



Shown with Optional Powder Coating

### Included:

- Galvanized Steel Panels
- Fasteners and Sealing Material
- Personnel Door with 18" x 18" Window
- (1) 48" 4 Tube Light Fixture with Tubes
- (1) 12" Tubeaxiel Fan with 1 PH Motor
- Filters Intake/Exhaust

### Available Options:

- Powder Coating
- Exhaust Ducting

# UniCure

Spraybooths

### INTERSTATE MARKETING CORPORATION

104 Spence Lane, Nashville, TN 37210  
Your Collision Repair Equipment Headquarters  
Call Toll Free: 1-800-868-3033 • TN (615) 889-3330  
e-mail: unicure@spraybooths.com • www.spraybooths.com