

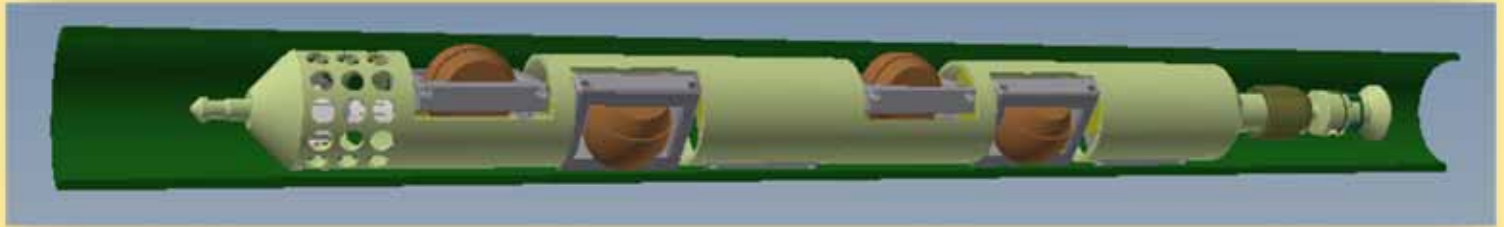

SUBSEA SYSTEMS

DIV. BAUGH CONSULTING ENGINEERS, INC.

DRAG TRAILER



THE BETA DRAG TRAILER FEATURES:
6 WHEEL/PUMPS IN THE CENTER,
A PIVOTED BETA LATCH AT THE FRONT,
A REAR HYDRAULICS SECTION, AND
A REAR LATCHING PROFILE

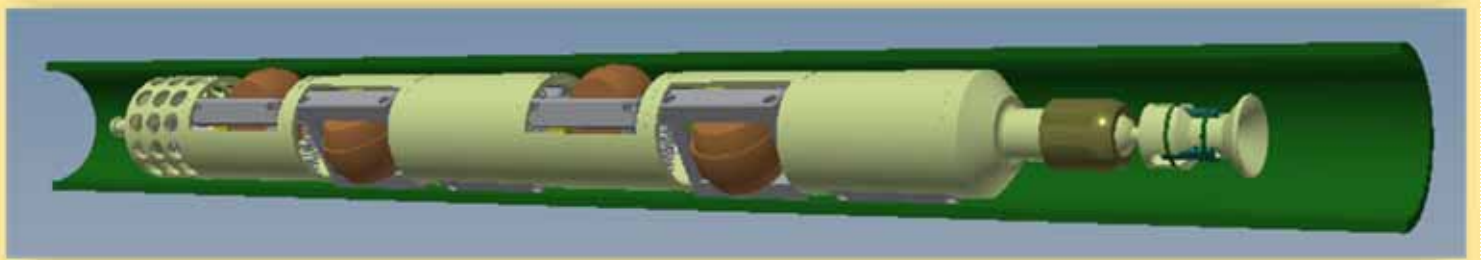

EACH OF THE WHEEL/PUMPS HAS AN EXTERNAL COATING FOR GRIPPING FRICTION AND IS SPRING LOADED ONTO THE INTERNAL BORE OF THE PIPELINE.

AS THE WHEEL/PUMPS ARE ROLLED, AN INTERNAL PUMP DRIVES FLUID TO THE REAR CHAMBER AND ACROSS AN ADJUSTABLE RELIEF VALVE TO SET THE LOAD.



A BETA DRAG TRAILER IS SHOWN CONNECTED ONTO THE REAR OF A CUSTOMER'S PIG WHICH WAS EQUIPPED WITH A LATCHING PROFILE.

THE DRAG TRAILER CAN BE UTILIZED AS A MODULAR TOOL AS ILLUSTRATED, OR CAN BE INTEGRATED DIRECTLY INTO THE CUSTOMER'S PIGS

Beta Subsea Systems offers a combination of patent licensing, engineering, manufacturing capabilities, and products to assist you grow your business.

Primary Contacts: Benton F. Baugh, Ph.D., P.E., 713-419-8683, bbaugh@baughengrs.com
James R. Crawford, 337-344-0289, jimbofcrawford@gmail.com

PATENT PENDING



SUBSEA SYSTEMS

DRAG TRAILER

DIV. BAUGH CONSULTING ENGINEERS, INC.

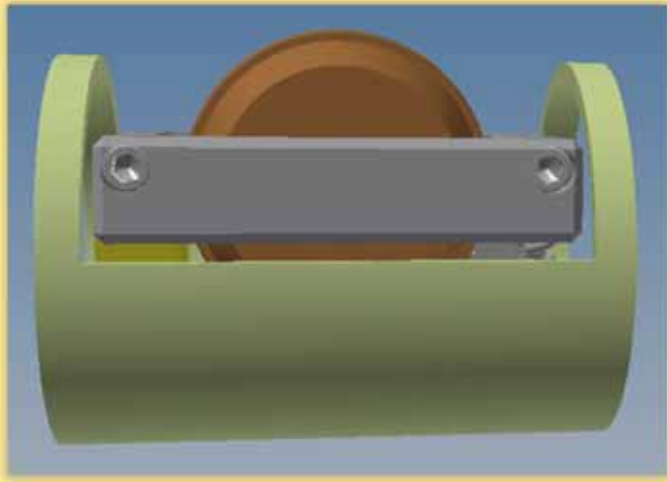

SIDE VIEW OF DRAG SECTION SHOWING YELLOW PIVOT POST TO THE LEFT AND BROWN FRICTION WHEEL/PUMP IN THE CENTER. WHEEL/PUMP IS PORTED THRU THE SILVER FRAME

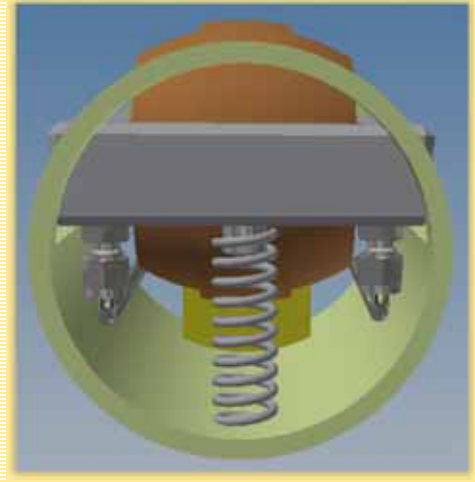

END VIEW OF DRAG SECTION SHOWING SPRING LOADING FOR WHEEL/PUMP AND TUBE FITTINGS GOING TO THE END FOR LOADING

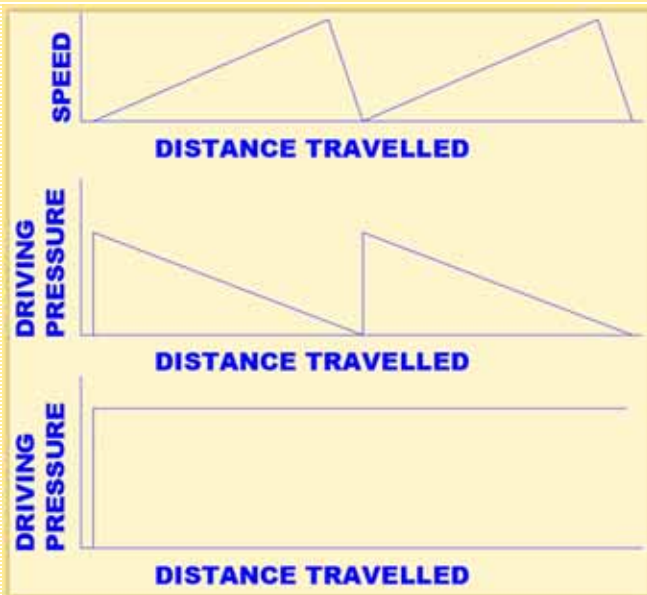

SHOWING A PIG OPERATING WITH STOP & START MOTION ASSOCIATED WITH STICTION

DRIVING PIPELINE PRESSURE DURING STOP & START

DRIVING PRESSURE WITH DRAG ADDED, ALWAYS ABOVE STICTION THRESHOLD

Beta Subsea Systems offers a combination of patent licensing, engineering, manufacturing capabilities, and products to assist you grow your business.

Primary Contacts: Benton F. Baugh, Ph.D., P.E., 713-419-8683, bbaugh@baughengrs.com
James R. Crawford, 337-344-0289, jimbobcrawford@gmail.com

PATENT PENDING