

---

QUATREAU™  
SmartTap  
User Guide

## QUATREAU SMARTTAP USER INSTRUCTIONS

Please read this guide thoroughly  
before using your Quatreau SmartTap.

### TAP FUNCTIONS: BOILING WATER WITH TOUCH SAFETY SEQUENCE

For your safety and to prevent accidental use, the boiling function has a safety switch that needs to be released to activate the flow of boiling water.

1. Depress and **hold** boiling (red).
2. Depress and **release** the chilled button (blue).
3. Fill you cup then **release** the boiling (red) button to stop.

1

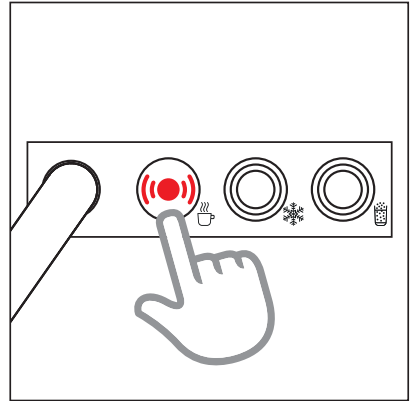

2

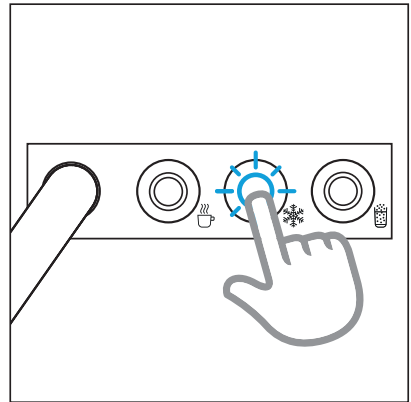

3

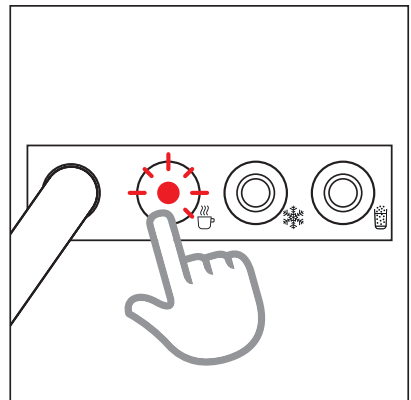

## 5.0

### **TAP FUNCTIONS: SPARKLING FILTERED WATER ADJUSTING THE CARBONATION OF THE SPARKLING WATER**

The CO<sub>2</sub> is controlled via the gas canister regulator on the front of the unit (see diagram)

Use a large flathead screwdriver or a 19mm spanner to increase the level of carbonation in the water turn the regulator by a half turn in a clockwise direction.

To decrease the level of carbonation turn the regulator by a half turn in an anti clockwise direction.

Between adjustments you must run off several glasses of sparkling water to see the effects of the adjustment. If the sparkling function is spluttering there is too much gas in the water, reduce the setting by one full turn and try again.

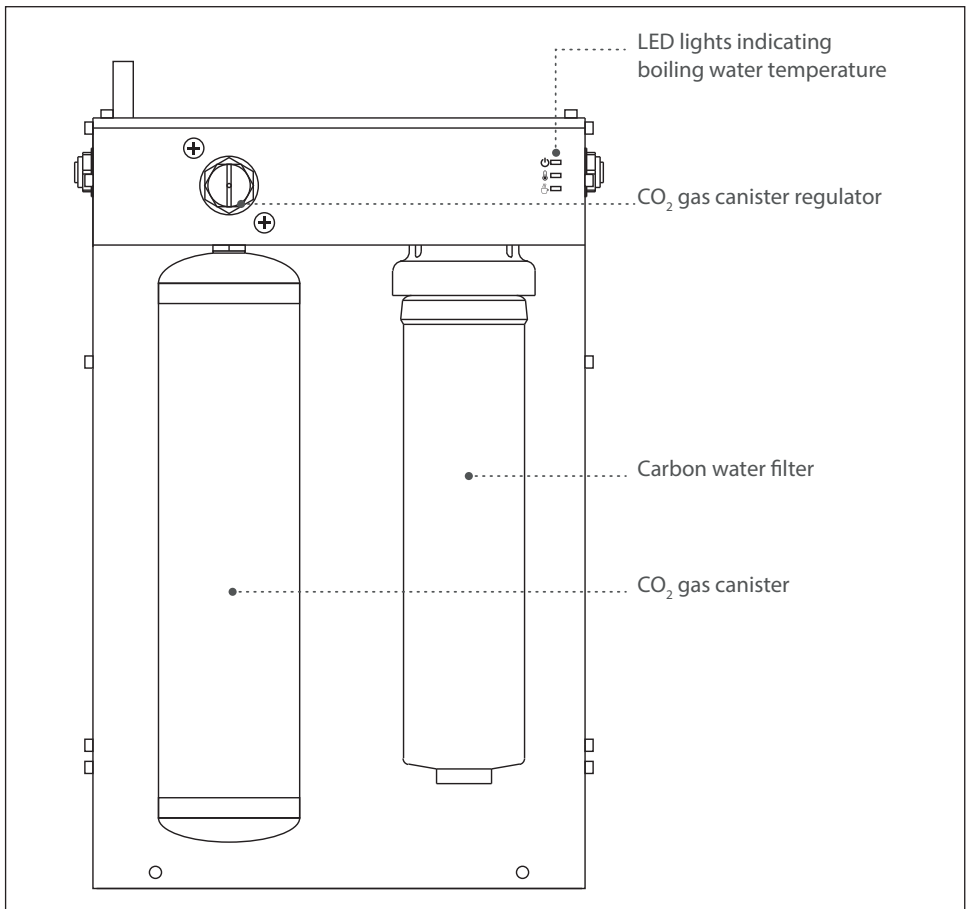

---

## 5.1

### **TAP FUNCTIONS:**

#### **SPARKLING FILTERED WATER CHANGING THE CO2 CANISTER**

When the sparkling water tastes flat it is necessary to change the gas canister.

The integral CO2 gas canister is sited on the left hand side at the front of the unit (see diagram opposite).

Please follow the instructions below to ensure your CO2 canister is correctly installed:

- 1 To remove a canister unscrew in an anticlockwise direction.
- 2 Locate the thread on the regulator where the gas canister will connect.
- 3 Carefully present the canister ensuring the canister is supported.
- 4 Rotate the canister in a clockwise direction being careful not to cross thread the regulator.
- 5 Rotate until you hear a hissing sound. This is the gas being released from the canister. It is important to keep screwing until you can no longer hear this hissing.
- 6 When the canister cannot be turned further it is safely connected. Do not turn the canister any further as this will damage the regulator.
- 7 Press the glass icon button and run off an amount of sparkling water to re-calibrate the system.

#### **Note:**

While removing a canister it is important to support its weight to avoid the canister dropping onto the floor.

When attaching a new gas cannister hand tighten the gas cylinder firmly but and do not over tighten. Check by listening that gas is not escaping.

The regulator has an internal opaque white coloured seal that should stay firmly in place. Older models have a black o-ring. If these are removed or fall out the gas will escape.

The regulators have two cross head screws attaching the regulator to the front panel. These are tightened during manufacture and should be checked periodically at service intervals, if they come loose gas will escape.

The Pure H2O Company Ltd, Unit 21 Boundary Business Centre, Boundary Lane,  
Woking, Surrey GU21 5DH United Kingdom [www.quatreau.com](http://www.quatreau.com)

---

QST 0719

Quatreau is a registered trademark of the Pure H2O Company Limited.  
Copyright © 2019 The Pure H2O Company Limited. All rights reserved.