



HPT Series

The HPT Series is our range of manual hand pallet trucks with capacity from 5,500 to 6,600 lb, offering a very competitive and reliable solution for lifting and moving operations. Engineered featuring European design, quality production processes, a wide range of fork sizes and hydraulic unit types, provide long-lasting strength and versatility.



5500 / 6600 lb



36-48 in



20-27 in



3.1 in



7.6 in



QUICKLIFT standard

FEATURES / ADVANTAGES

QUALITY PRODUCTION



HPT Series is designed in a dedicated production plant, with robot welding, specific painting system through epoxy-polyester powder coating, to ensure the highest level of performance and durability.

ENTRY / EXIT ROLLERS



Additional nylon rollers at the fork tip allows an easier pallet entry and exit. The wheels are designed to maintain optimal contact with floor, which helps users easily maneuver across dock plates, in and out of trailers and over uneven floors.

WIDE RANGE OF HYDRAULIC UNITS



Resistant and reliable one piece cast iron pump, in three different versions, worked with numerical control machine, including:

- Maximum pressure valve: safety device that ensures overloading the jack. When the pressure inside the hydraulic circuit exceeds the set calibration value according to the maximum nominal flow, the valve automatically locks the forks.

CONFIGURATIONS



STANDARD

Nylon steering wheels and Nylon rollers
2 curves steering Handle



OPTIONAL

Rubber and polyurethane steering wheels, polyurethane rollers. 4 curve covered handle ergonomic tiller.



STANDARD

Quick lift. The perfect tool to lift loads up to 330 lb quickly. The hydraulic pump is specifically engineered to cut job time in half compared to standard manual jacks.

Hand Pallet Truck

		HPT SERIES - HAND PALLET TRUCK					
DESCRIPTION	1.2	MODEL			HPT	HPT	HPT
	1.3	DRIVE			MANUAL	MANUAL	MANUAL
	1.5	LOAD CAPACITY	Q	lb	4400	5500	6600
	1.6	LOAD CENTRE DISTANCE	c	in	24	24	24
	1.8	LOAD DISTANCE, CENTRE DRIVE AXLE TO FORK	x	in	39.6	39.6	39.6
	1.9	WHEEL BASE	y	in	49.7	49.7	49.7
2.1							
TIRES/CHASSIS	3.1	TYRES			Nylon - Nylon	Nylon - Nylon	Nylon - Nylon
	3.2	TYRE SIZE, FRONT (Ø x width)		in	7.9x2.2	7.9x2.2	7.9x2.2
	3.3	TYRE SIZE, REAR (Ø x width)		in	3.2x3.2-2.4	3.2x3.2-2.4	3.2x2.4
	3.5	WHEELS, NUMBER (x=DRIVEN) FRONT/REAR			2/2-2/4	2/2-2/4	2/4
	3.6	TREAD, FRONT	b10	in	6.10	6.10	6.10
	3.7	TREAD, REAR	b11	in	21.1	21.1	21.1
DIMENSIONS	4.4	LIFT	h3	in	4.5	4.5	4.5
	4.9	HEIGHT OF TILLER IN DRIVE POSITION MIN/MAX	h14	in	25.6/48.4	25.6/48.4	25.6/48.4
	4.15	HEIGHT, LOWERED	h13	in	2.9	2.9	2.9
	4.19	OVERALL LENGTH	l1	in	63.8	63.8	63.8
	4.20	LENGTH TO FACE OF FORKS	l2	in	15.7	15.7	15.7
	4.21	OVERALL WIDTH	b1	in	27	27	27
	4.22	FORK DIMENSIONS	s/e/l	in	2.2/5.9/48.0	2.2/5.9/48.0	2.2/5.9/48.0
	4.25	DISTANCE BETWEEN FORK ARMS	b5	in	27	27	27
	4.32	GROUND CLEARANCE, CENTRE OF WHEEL BASE	m2	in	0.9	0.9	0.9
	4.34	AISLE WIDTH FOR PALLETS 800x1200	Ast	in	72.9	72.9	72.9
	4.35	TURNING RADIUS	Wa	in	56.6	56.6	56.6
PERFORMANCE DATA	5.2	LIFT SPEED, LADEN/UNLADEN		strokes	5/9	5/9	5/9
	5.3	LOWERING SPEED, LADEN/UNLADEN		ft/s	0.16/0.06	0.16/0.06	0.16/0.06
		MAX LOAD FOR QUICKLIFT FUNCTION		lb	-	330	330

HPT available with fork size:

22"x36", 21"x42", 21"x48", 27"x36", 27"x42", 27"x48"

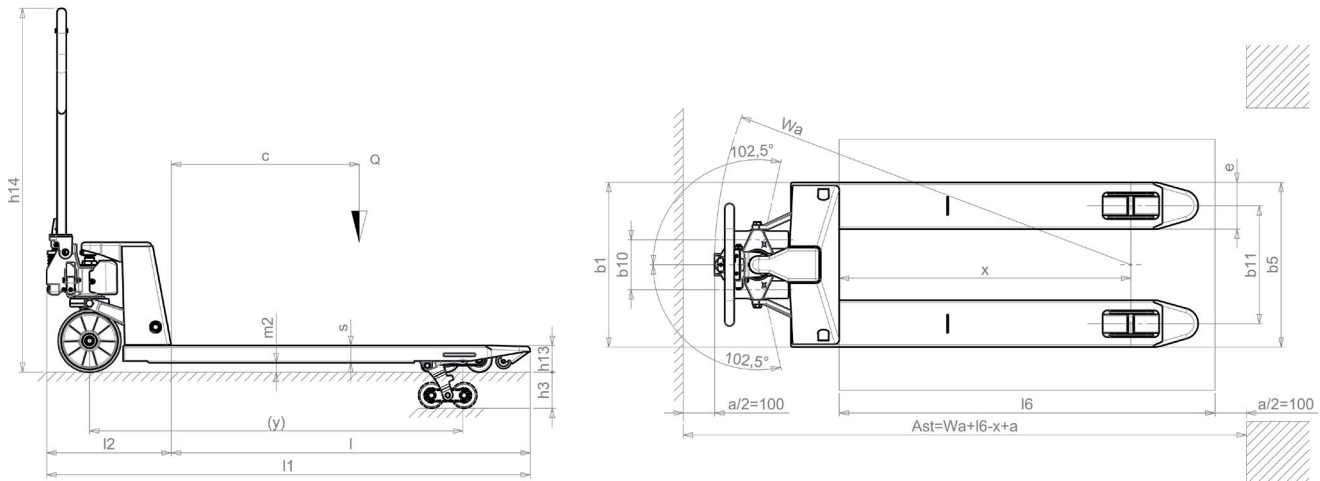

Distributed by



POWERHANDLING, INC.

1110 W RIVERSIDE AVE, STE 400 SPOKANE WA 99201

TEL: 509-244-8860 Fax: 509-267-6428 / sales@powerhandling.com / www.powerhandling.com