



RESIDENTIAL APPLICATION PARCEL# _____

CITY OF HIGHFILL 15036 W HWY 12 HIGHFILL AR 72734
PHN: 479-736-5711 FAX: 479-736-5921 EMAIL: admin@highfillar.com

Checklist: Application Site Plan Building Plan Driveway Permit Septic Approval
 Contractor license Documents larger than 11x7 must be digital and all documents must be legible. FLOOD

PRIMARY CONTACT Owner Contractor

PROPERTY OWNER INFORMATION

Property Owner Name: _____
Project Address: _____
Phone: _____ Email: _____
Property owners mailing address: _____

I the undersigned will be responsible for performing the work and meeting the requirements of all codes, ordinances, and laws; and that I am the owner of the above described property.

Property Owners Signature _____ Date

CONTRACTOR INFORMATION

Contractors Name: _____ Primary Contact: _____
Phone: _____ Email: _____ Lic. # _____

SUB-CONTRACTORS:

Electrician: _____ Phone: _____ Email: _____
Plumber: _____ Phone: _____ Email: _____
HVAC: _____ Phone: _____ Email: _____

A copy of licenses must be provided with each new project.

BUILDING INFORMATION

New Home Addition Garage/Shop
Heated SF: _____ Garage SF: _____ Unfinished Basement SF: _____ Total SF: _____
Bedrooms: _____ #Bathrooms: _____ #Stories: _____ Foundation Type: _____

UTILITY INFORMATION

Septic Sewer
Electric Provider: _____ Water Provider: _____

CLASS OF WORK

Plumbing \$100 Gas \$100 Electric \$100 Mechanical \$100 Pool \$150
 Deck \$50 Remodel \$150 Mobile Home \$100 Storm Shelter \$150
Other: _____

Note: This permit becomes null and void if work or construction authorized is not commenced within 6 MONTHS, or if construction or work is suspended or abandoned for a period of 6 MONTHS at any time after work is commenced. I hereby certify that I have read and examined this application and known the same to be true and correct. All provision of the Law and Ordinances governing this type of work will be complied with whether specified herein or not. The granting of a permit does not presume to give authority to violate or cancel the provisions of any other State or Local law regulating construction or the performance of construction.

Signature _____ Date



215 E. Central Ave., #12
Bentonville, AR, 75712
479-271-1085

BENTON COUNTY 9-1-1 ADMINISTRATION ADDRESS NUMBER REQUIREMENTS

9-1-1 addresses are assigned to aid emergency responders in finding your home or business. Benton County Ordinance No. 0-89-27 requires that addresses be displayed. Please follow these guidelines set by the 9-1-1 Administrative Board to ensure the quickest response to your 9-1-1 call.

- All 9-1-1 address numbers should be installed and maintained at the owner's expense.
- Address numbers must be clearly visible from the street or road so that an emergency response vehicle can readily identify the location of your home or business. The numbers should be of a color that contrasts with the background and made of reflective material. Preferably 3 to 4 inches in height. Numbers must be at least 3 ft to 4 ft from the ground so they are easily seen
- Numbers must be displayed on the front of your building or on the side that faces the street or driveway. If your building is not visible from the street, the numbers must be displayed where your driveway starts so an emergency vehicle will know your house or building is down that driveway. Make sure to keep weeds and grass cut so they do not cover up the numbers. If there is more than one address on a driveway make sure all addresses are visible.

Special instructions for apartment buildings

Apartment buildings must have the building number affixed to each building and must have individual apartment numbers affixed on or near each apartment door.

Special instructions for commercial buildings

Any building that has separate suites or other designators in addition to the building, numbers must be affixed on or near the door of each individual office or suite.

Special instructions for pedestal mailboxes

The box number for the pedestal mailbox is not part of your 9-1-1 address and must not be posted with your 9-1-1 address on the building.

Please call the 9-1-1 Administration Office if you have any questions, Monday through Friday, 8:00 am to 4:30 pm at numbers listed below.

Useful Numbers for Benton County				
Dept of Emergency Management	Community Risk Reduction	Planning Office	Sherriff's Office Non-emergency	Environmental Office
479-271-1004	479-271-1003	479-464-6166	479-271-1008	479-271-1083

FOUNDATION PLAN

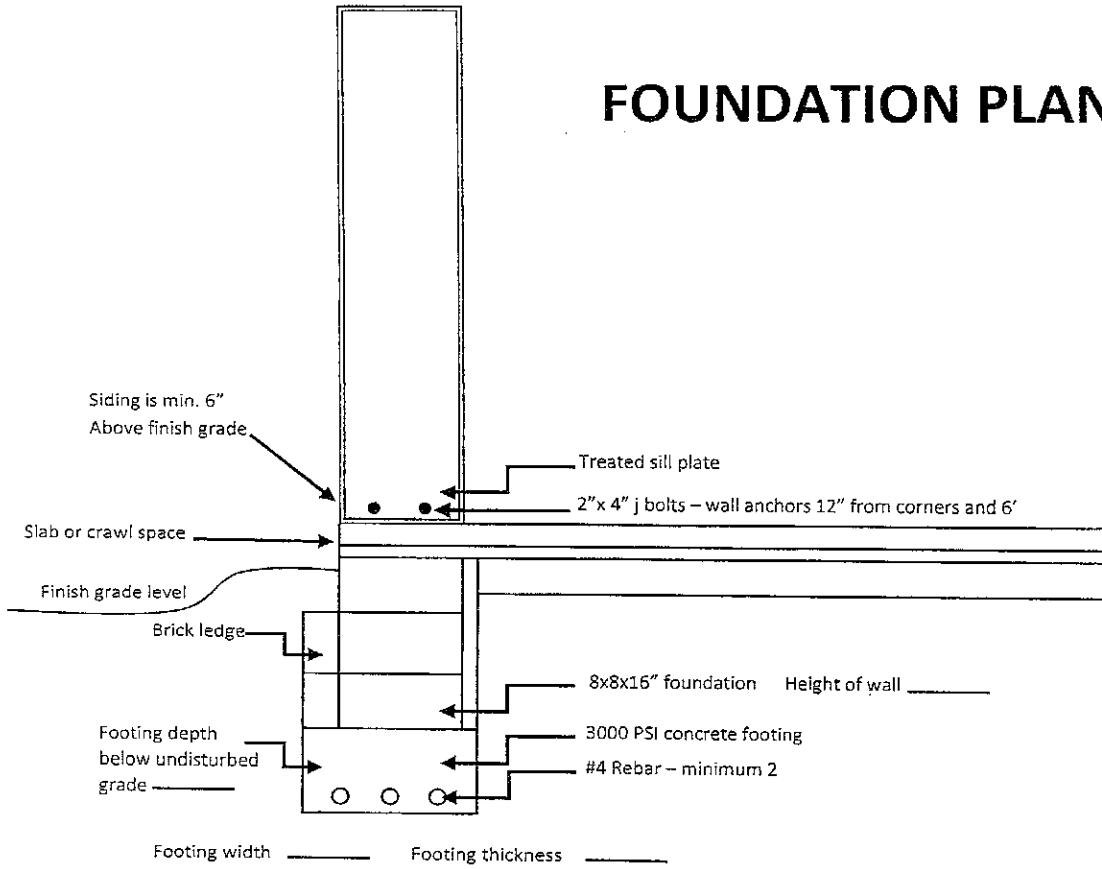

SLAB FOUNDATION PLAN

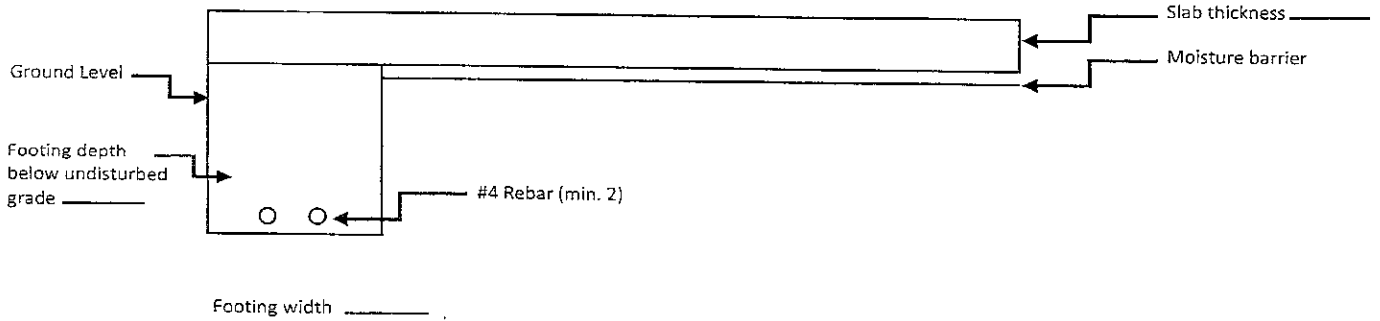

POLE BARN FOUNDATION PLAN

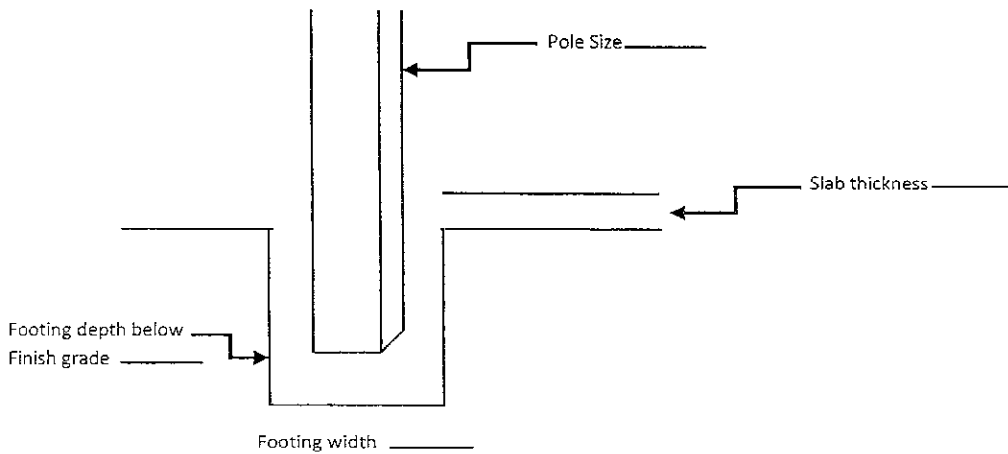

HIGHFILL FIRE DEPT.

REFLECTIVE ADDRESS MARKER ORDER FORM

Please complete the following information:

Name _____
Address _____
City, ST Zip _____
Phone Number _____

Address Number Requested

<input type="checkbox"/>	<input type="checkbox"/>	<input type="checkbox"/>	<input type="checkbox"/>	<input type="checkbox"/>
--------------------------	--------------------------	--------------------------	--------------------------	--------------------------

Note: If your address has fewer than 5 digits, please X those boxes not used.

Mounting Preference

HORIZONTAL _____

VERTICAL _____

HORIZONTAL

V
E
R
T
I
C
A
L

**ONLY
\$10**

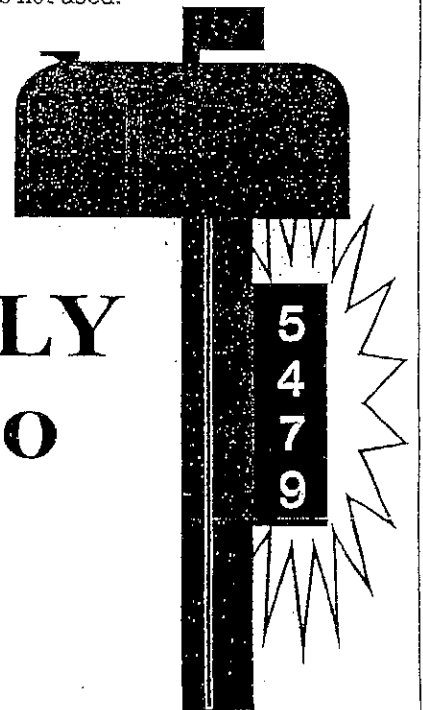

Call City Hall @
479-736-5711

2014 ARKANSAS ENERGY CODE LABEL

BUILDING ENVELOPE INSULATION TYPE R-VALUE

Ceiling Flat:	_____	_____
Vaulted Ceiling:	_____	_____
Above Grade Walls:	_____	_____
Foundation Walls:	_____	_____
Exposed Floor:	_____	_____
Slab:	_____	_____

Other Info:

(HERS Score, Duct/Envelope Leakage Rate, Radiant Deck Barrier, Lighting specification, etc., if applicable)

WINDOW DATA & DOORS U-FACTOR SHGC

Window:	_____	_____
Door:	_____	_____

MECHANICAL EQUIPMENT TYPE RATING

HEAT:	_____	_____
COOL:	_____	_____
DHW:	_____	_____

COMPLIANCE PATHWAY

Pathway: Prescriptive Trade Off Performance

BUILDER INFORMATION

General Contractor: _____

Signature: _____

License Number: _____

Date: _____

This label serves as an indication that the home, at the time of completion, is in compliance with the code.





Your Local Energy Partner

Application for Residential New Construction Checklist

THE ITEMS BELOW APPLY TO YOUR APPLICATION FOR NEW ELECTRIC SERVICE

- _____ Application for Service must be signed and returned.
 - For accounts in a business name, please provide a notarized affidavit from an "Officer" of the company stating whoever is signing the application has the authority to do so.
- _____ Photocopy of a proper form of identification: Driver's License or State ID Card, Military ID, Passport, I-551 (Permanent Resident Card/Green Card) or Mexican Consular ID Card.
- _____ Membership fee of \$25.00 (refundable) must be paid.
- _____ New service meter connect fee of \$50.00 (non-refundable) must be paid.
- _____ New service application fee of \$80.00 (non-refundable) must be paid.
- _____ New service meter base hook up/wiring fee of \$100.00 (non-refundable) must be paid
- _____ Service deposit of \$230.00 (refundable with interest) must be paid. However, the following may be provided in lieu of a service deposit:
 - For accounts in an individual's name, a letter of good credit rating for the previous 12 months from a former gas, water or electric utility (residential service only)
 - For accounts in a business name, a surety bond or irrevocable bank letter of credit
- _____ W-9 for accounts in a business name; Social Security number for accounts in an individual's name
- _____ Bank draft form attached; please provide a voided check if you would like to enroll.
- _____ Provide the 911 address and a copy of the deed/parcel description.

Carroll Electric's standard installation provides the following options:

- | | |
|---|---|
| <input type="checkbox"/> 200 Amp Meter Base - \$190.53
Turnkey Installation (signed release form required) <ul style="list-style-type: none"> • 200-amp main breaker • 20-amp circuit breaker • GFCI outlet • Slip joint for permanent power | <input type="checkbox"/> 400 Amp Meter Base - \$707.97
Turnkey Installation (signed release form required) <ul style="list-style-type: none"> • Two 200-amp main breakers • 20-amp circuit breaker • GFCI outlet • Slip joints (2) for permanent power |
|---|---|

TO ADD A NEW SECURITY LIGHT, PLEASE REFER TO THE INFORMATION BELOW:

- _____ I would like to have (a) new security light(s) installed at my new service location and agree to pay the \$50.00 light connect fee(s) and the associated monthly service fee(s). Carroll Electric offers the following light for residential use:
 - LED – Standard Residential Wattage - \$8.92

PLEASE RETURN THE REQUESTED DOCUMENTS BY EMAIL TO info@carrollecc.com OR IN PERSON OR BY MAIL TO A LOCAL OFFICE NEAR YOU.

NOTE: After one year of no activity, the application will expire.

Bentonville
707 SE Walton Blvd.
PO Box 329
Bentonville, AR 72712
(479) 273-2421

Berryville
920 Hwy. 62 Spur
PO Box 4000
Berryville, AR 72616
(870) 423-2161

Huntsville
5056 Hwy 412B
PO Box 280
Huntsville, AR 72740
(479) 738-2217

Jasper
511 E Court St.
PO Box 389
Jasper, AR 72641
(870) 446-5114

CARROLL ELECTRIC COOPERATIVE CORPORATION
APPLICATION FOR MEMBERSHIP
AND/OR ELECTRIC SERVICE

The applicant, whose signature appears below, applies to the CARROLL ELECTRIC COOPERATIVE CORPORATION of Berryville, Arkansas, (hereinafter called the "Cooperative") for membership and electric service to be supplied at the location herein described and, upon request, at any other location within the area served by this Cooperative.

The Applicant agrees to conform to and abide by the bylaws and regulations of the Cooperative; to pay for said service as bills are due in accordance with the rates, rules, and regulations as now exist or as may hereafter be adopted; and authorizes the Cooperative to verify information provided, including the use of any credit reporting agency to verify identity. The Applicant agrees to keep the Cooperative informed of the current mailing address.

The Applicant will cause his premises to be wired in accordance with wiring specifications of the appropriate governing jurisdiction and the Cooperative assumes no responsibility for loss or damage due to defective wiring and/or equipment located on the Applicant's side of the meter installation.

The Cooperative shall use reasonable diligence to provide a constant and uninterrupted supply of electric power and energy hereunder. If the supply of electric power and energy shall fail or be interrupted, or become defective through acts of God, governmental authority, action of the elements, public enemy, accident, strikes, labor troubles, required maintenance work, inability to serve right-of-way, or any cause beyond the reasonable control of the Cooperative, the Cooperative shall not be liable therefore or for damages caused thereby.

The Cooperative agrees to furnish electrical service at the standard 120/240 volts, AC, unless otherwise stated in accordance with the approved schedules, rules and regulations.

I HEREBY APPLY TO THE CARROLL ELECTRIC COOPERATIVE
CORPORATION FOR MEMBERSHIP AND/OR ELECTRIC
SERVICE IN ACCORDANCE WITH THE TERMS AND
CONDITIONS APPEARING ABOVE.

Applicant Signature _____ Date _____
 Co-Applicant Signature _____ Date _____
 Electronic billing (eBilling) Yes No
 eBilling Email Address _____

Attention to: _____

Complete and Return

Date Service Desired _____ Connect Date _____
 Applicant _____
 Soc. Sec. No. _____ Date of Birth _____
 Driver's License No. _____ Other _____
 Home Phone No. _____ Work Phone No. _____
 Place of Employment _____
 Co-Applicant _____
 Soc. Sec. No. _____ Date of Birth _____
 Driver's License No. _____ Other _____
 Home Phone No. _____ Work Phone No. _____
 Place of Employment _____

Billing Address _____

Previous Billing Address _____

Address of meter (if different than billing address) _____

Lot _____ Block _____ Phase _____ Subdivision _____

Email Address _____

I am a: Homeowner _____ Tenant (Rent) _____

Landlord _____ Tenant's Name(s) _____ Landlord's Name _____

If there is a SECURITY LIGHT at this location, would you like to keep it?

Yes _____ No _____

FOR RESIDENTIAL CUSTOMERS ONLY: Mark the box(s) below if your account should be marked as:

Age 65 or Older _____

Handicapped (Doctor's certification required - certification from a physician, licensed psychologist, by the United States Veteran's Administration, the Social Security Administration, the Arkansas Department of Human Services, the Arkansas State Hospital, or a licensed mental health center).

CECC USE ONLY	
Account Location No. _____	_____
Account No. _____	Member No. _____

Carroll Electric is an equal opportunity employer and provider.

Meter Base Package Release

I hereby acknowledge receipt of and accept full ownership of the following described material(s) from *Carroll Electric Cooperative Corporation* (the "Cooperative") upon the following terms and conditions:

- 1) 200 Amp Meter Base Package
 400 Amp Meter Base Package

- 2) Upon installation by the Cooperative, I assume full responsibility and control of all material(s) obtained hereunder. Any costs for repair, replacement, or removal of the material(s) shall be at my expense. I understand that a licensed electrician should be the only party who repairs, replaces, or removes the materials. If the materials are installed in an area where an official inspection is required by any government agency, or any county, city, or other controlling entity, I agree that I am completely responsible for having the materials and/or installation inspected by an appropriate expert. The Cooperative will work with all local inspection offices to ensure a proper installation.

- 3) I agree to indemnify and save and hold the Cooperative harmless from any liability from any cause whatsoever that might be claimed by me, any subsequent owner, or any person or entity, claiming damages by virtue of or in any manner arising out of a defect in the material(s), the use or condition of the material(s), or any other function or circumstances relating to the material(s). In the event any legal action is brought against the Cooperative by any party for any reason regarding a defect in the material(s), the use or condition of the material(s), or any other function or circumstances relating to the material(s), the undersigned agrees to reimburse the Cooperative for any and all costs, charges, expenses, judgments, or otherwise, together with its attorney's fees and costs, to investigate and/or defend such claims.

Printed name

Account Number, if known

Signature

Date

ACKNOWLEDGED:
Carroll Electric Cooperative Corporation

By: _____

Simplify with eServices from  Carroll Electric



- Automatically pay each month using a bank account or credit card.
- Bill is drafted on the due date.
- Free when set up using checking or savings.
- A transaction fee applies when using a credit card.*
- Eliminates shut-off notices and late fees.
- Convenient and trusted by thousands of members.
- Helps preserve low electric rates.

* A pass-through fee from credit card processing vendor. The Cooperative receives no benefit from this fee.



- An email is sent when monthly bill is available.
- View bill online through *myAccount*.
- Paperless.
- Saves postage.
- Links to newsletters and other communications.
- The perfect partner for *eDraft*.

Name:

eDraft: *Checking* CECC Account
 Savings Number(s):

Daytime Phone:

Start Date*:

Bank Name:

Bank City/State:

Bank Routing Number (max of 9 numbers):

Bank Account Number (max. of 15 numbers):

Name(s) on Bank Account:

eBilling:** Email address:

- Complete and send this form with a voided check to:

Carroll Electric Cooperative
PO Box 4000
Berryville, AR 72616

- or go to carrollecc.com.
- or visit one of our convenient locations: Bentonville, Berryville, Huntsville or Jasper.

*Must provide minimum of 5 business days notice prior to due date.

**Must establish myAccount ID and password to view bills. See myaccount.carrollecc.com for details.



Establishing Service for New Construction

200 Amp Meter Base: 400 Amp Base Available

Startup Fees:

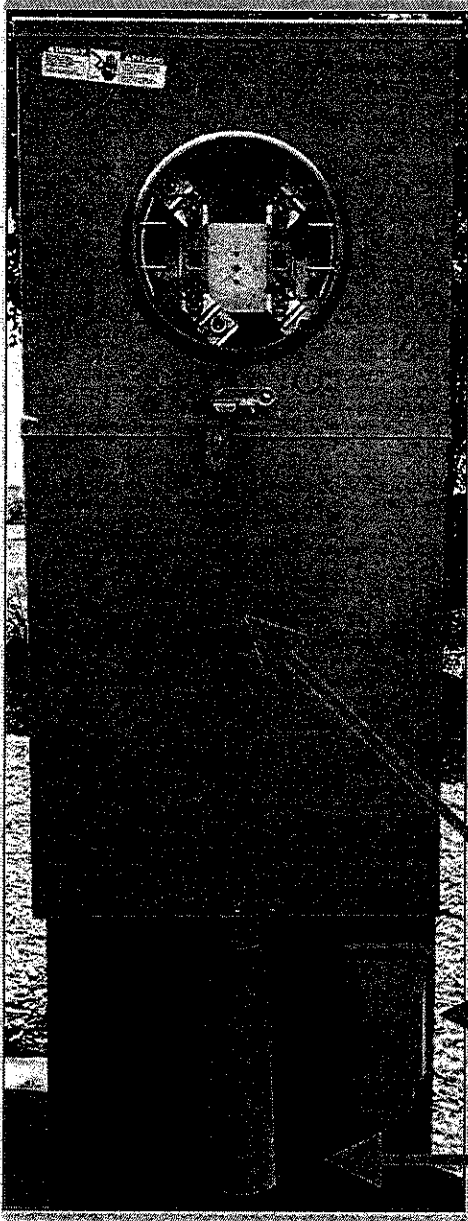

Fees		200 Amp Meter Base	Each Add'l Meter Base - Same Location/Subd
Standard Fees	Membership Fee	\$ 25.00	\$ -
	Service Deposit (if Letter of Credit is not available)	\$ 230.00	\$ 230.00
Hook Up Fees	New Service Application Fee	\$ 80.00	\$ 55.00
	New Service Meter Installation/Connect Fee	\$ 50.00	\$ 50.00
	New Service Meter Base Hook Up/Wiring Fee	\$ 100.00	\$ 100.00
Meter Base	200-Amp Meter Base Package	\$ 190.53	\$ 190.53
TOTAL, Including Full Service Deposit		\$ 675.53	
TOTAL, Including 1/2 Service Deposit (billing other 1/2)		\$ 560.53	
TOTAL with Letter of Credit		\$ 445.53	

**Note - Additional construction costs may apply if meter is set for a non-qualified load (e.g. shop building, boat dock, gate, other structures not deemed a permanent residential dwelling)*

200 Amp Main Breaker Included
As well as a 20 Amp Sub Breaker

GFCI for **Construction Power**
**Also, permanent yard outlet

Slip Joint provided for your
Permanent Power connection

For this meter base CECC provides
STANDARD TURNKEY INSTALLATION*

** Installed in accordance with CECC Line Extension Policy on file with the Arkansas Public Service Commission which states the normal location of meter is the lot line*

Project Information Form

To be completed by CECC personnel. For informational purposes only.

- Deposits and Fees
 - See Application for Residential New Construction Checklist for all applicable fees
- Structure Information:
 - If known, what is the anticipated electric load? _____
 - What is the total square footage? _____
 - Electric only Propane/Natural Gas Renewable (Solar/Wind)
- Will construction consist of underground or overhead (if known)?
 - Underground Overhead
 - Member is aware of additional construction costs for UG and/or over-distance line extension, if applicable.
- Are there any existing facilities to be relocated?
 - Yes No
 - Member is aware of additional costs for relocating existing facilities
- What is the type of service:
 - Qualified Non-Qualified
 - If Qualified, have requirements been met?
 - Foundation Pressurized Water Approved Sewage disposal Installed
- Contribution-In-Aid Cost of \$_____ has been paid?
 - Yes No N/A
- Temporary if Non-Qualified, has Temporary cost of \$_____ been paid?
 - Yes No N/A
- Temporary agreement signed?
 - Yes No N/A
- Easement, this includes a continuation/exit from proposed property as well as all other properties involved. The total number of easements required is _____.
 - Yes No N/A
 - Rural (60 feet) Urban (30 feet) Underground (15 feet)

- Future construction plans for additional buildings (Example: Barn or Shop):
 - Yes No N/A
- Location of meter:
 - Pedestal Building/House *(Results in relocation cost)*
- Permits and inspections: obtained/performed
 - Yes No N/A
- Ditches properly excavated and backfilled and inspection done by a CECC Representative?
 - Yes No N/A
- Conduit termination points fit within the Cable Template *(underground transformers)*?
 - Yes No N/A
- Riser properly oriented on pole with appropriately sized slip joints and standoffs?
 - Yes No N/A
- Installation instructions.
 - The final location for the point of delivery will be at the discretion of the Cooperative.
 - **Prior to construction** contact your Field Service Representative for all applicable CECC specifications and drawings.

See the enclosed Local Contact Information page for permits and/or waivers (where applicable). Other permits or certifications may be required. Please consult with your Field Service Representative for all requirements.

- Barry County Health Department Permit or Waiver
- Benton County 911 Address "Certification of Address"
- Berryville Building Permit
- Carroll County 911 Address "Certification of Address"
- Stone County Building Permit or Waiver

Local Contact Information

Inspection/Permits:

It is the member/consumer's responsibility to acquire any and all applicable state and local permits and/or their associated inspections. CECC will not supply power to the point of delivery without such notification from the local governing authorities. A list of authorities, their contact information, and jurisdiction has been provided for your convenience.

Arkansas One-Call	811
Missouri One-Call	811
Barry County Health Dept. or waiver	417-847-2114
Benton County 911 Address	479-271-1085
Benton County	479-271-1003
Carroll County 911 Address	870-423-6400 OR
	870-423-2388
Stone County	417-357-8402
City of Bella Vista	479-855-8080
City of Bentonville	479-271-3125
City of Berryville	870-423-2335
City of Bethel Heights	479-255-1659
City of Cave Springs	479-248-1040
City of Centerton	479-795-2750
City of Highfill	479-736-5711
City of Little Flock	479-636-2081
City of Lost Bridge Village	479-359-3204
City of Lowell	479-770-2185
City of Pea Ridge	479-451-1424
City of Rogers	479-621-1100
City of Siloam Springs	479-524-3777
City of Springdale	479-750-8154

Standard Meter Installation (1)

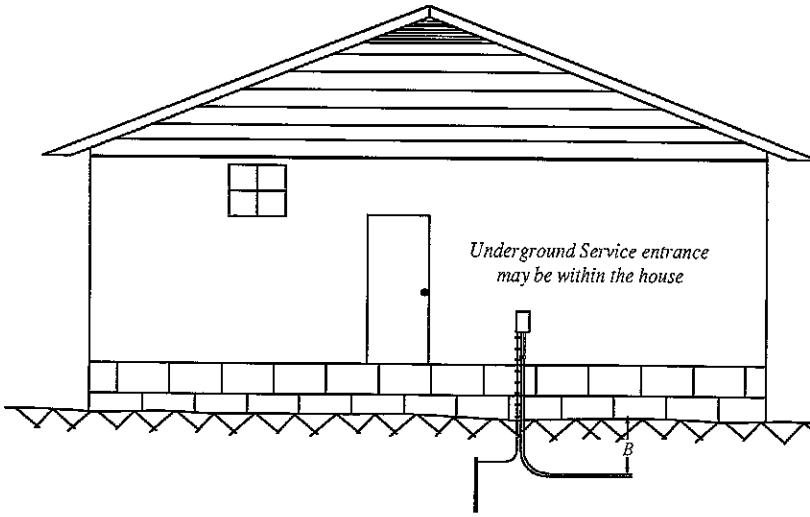

Standard Meter Installation (2)

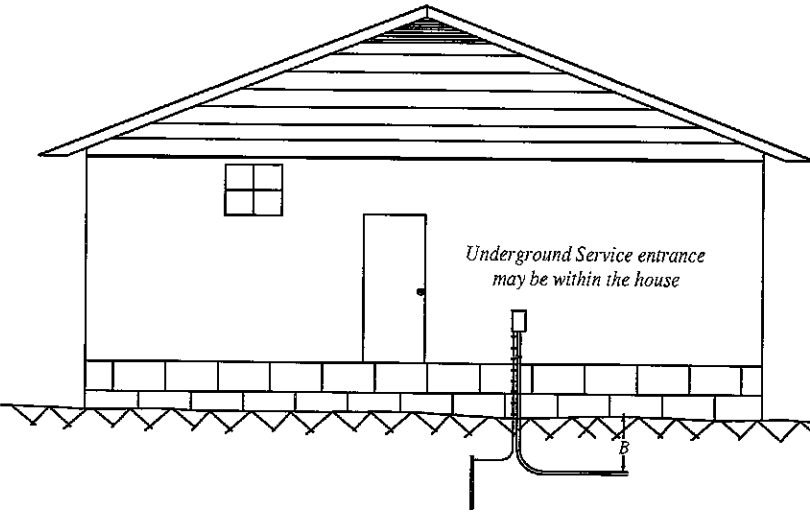

Meter Installation on Pole will NOT be allowed.

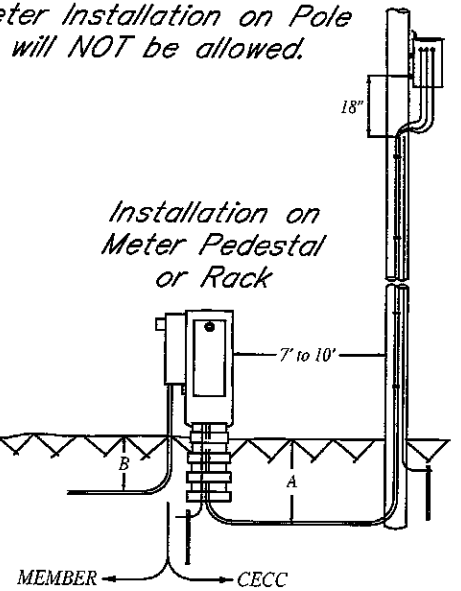

Installation on Meter Pedestal/Transformer Vaults

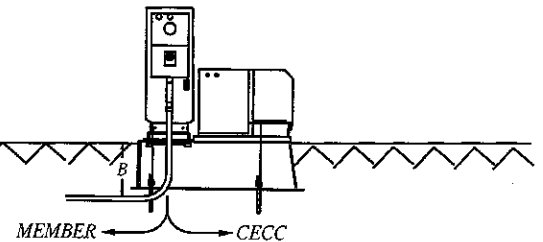

CECC Requirements

All installations per listed and NEC requirements
(local authorities may have additional requirements)

Notes - General

1. CECC will provide, install and transfer ownership of the following at minimal cost:
 - 200 meter base with breaker or 400 amp meter base with (2) 200 Amp breakers
 - 20 Amp sub breaker
 - GFCI outlet with in use all weather cover
 - (1) 2" slip joint for 200A or (2) 2" slip joint for 400A
 - Mounting hardware
2. All underground conduit on utility side not installed by CECC must be Schedule 40 gray electrical PVC conduit with pull string installed minimum 1/4" pull rope or 1200# tape (or equivalent) and shall be inspected by CECC before closing trench (24 hr. notice required).
3. All member conduit shall comply with current NEC.

Dimension Requirements

A	36"	Minimum depth below finished grade for (bottom of ditch) CECC owned facilities.
B	18"	Minimum depth below finished grade for Member owned facilities.

Notes - CECC installation for a qualified load:

4. CECC will install and provide the service wire to the point of delivery at the load side meter lugs for UG service.

Notes - CECC installation for a non-qualified load:

5. All materials shall be furnished and installed at member expense including equipment, labor and associated inspections needed to accommodate the meter.

Notes - Installation on Pole:

6. Meter bases shall not be installed on CECC poles.

IMPORTANT

Before installing any facilities contact:
CECC Field Service Representative
1-800-432-9720



Carroll Electric
Cooperative Corporation
YOUR LOCAL ENERGY PARTNER

Issue: 2019
Revision: A

METER BASE
INSTALLATION GUIDE

Page 1 of 2
STANDARD

Q2.1G, UQ2.1G