

**INFINITY™**

**SF SERIES™ SUBMERSIBLE  
SOLIDS-HANDLING PUMPS**



**GR®**  
**GORMAN-RUPP**  
**PUMPS**

# A HISTORY OF INNOVATION

Gorman-Rupp has been revolutionizing the pumping industry since 1933. Many of the innovations introduced by Gorman-Rupp over the years have become industry standards. More than ever, we continue to update our factories, processes, research and development, and engineering to ensure that our pumps and systems are among the most reliable and efficient in the world.

While much of Gorman-Rupp's reputation has been built on the success of our self-priming pumps, we have been producing high-quality, long-lasting submersible pumps since 1960.

The Infinity™ line of submersible solids-handling pumps has been developed with NEMA Premium Efficiency motors and passes a minimum of 3" spherical solids with optimized pumping efficiency.

With over 75 years of manufacturing experience, you'll find a wealth of knowledge and expertise behind every Gorman-Rupp pump. With hundreds of thousands of pump installations worldwide and one of the leading distribution networks in the world, Gorman-Rupp serves a broad range of pump applications with the **"Right Pump for the Job."**



The barn where J.C. Gorman and H.E. Rupp made their first pumps on the outskirts of Mansfield, Ohio.



The new state-of-the-art manufacturing facility, completed in 2010, features the Mansfield Division, Corporate Headquarters and Gorman-Rupp International.



Since the 1960s, Gorman-Rupp has provided innovative submersible pump solutions throughout the world.



A packaged submersible pumping system is used to transfer sewage to a treatment facility.



Gorman-Rupp SF Series™ submersible solids-handling pumps are designed to provide you with the ultimate in pumping performance. All SF Series pumps use NEMA Premium Efficiency motors and pass a minimum 3" spherical solid. Vortex pumps use the patent-pending Staggerwing® impeller technology.

SF Series submersible solids-handling pumps are available in slide rail and construction / trash versions for use in most liquid removal applications.

The SF Series comes with 3", 4", 6", and 8" flanged discharge and power ranging from 2 – 75 HP (1.5 to 56 kW). These combinations will provide flows up to 3,100 gpm (195.6 lps) and heads to 190 feet (57.9 meters).

Built to the same exacting standards you've come to expect from our industry-leading self-priming pumps, SF Series pumps are designed for easy maintenance and constructed for long life.

- Press-fit motor with our patent-pending finned motor housing provides superior motor cooling resulting in increased motor life
- Moisture detection in both the seal and motor chambers is standard
- All pumps pass a minimum 3" spherical solid
- NEMA Premium Efficiency motors with Class H insulation standard on all models
- Externally adjustable face clearances, on channel impeller pumps, to improve pumping efficiency without time-consuming wear ring replacement

Terminal housing and cable connections designed for easy in-the-field cable replacements



# GORMAN-RUPP INFINITY™ SUBMERSIBLE PUMPS

## SF SERIES™ VORTEX PUMPS

- 1 Field replaceable terminal housing and motor cable
- 2 NEMA Premium Efficiency (IEC IE3) motor
- 3 Heavy duty ball bearings
- 4 Staggerwing® vortex impeller
- 5 Heat-extracting motor housing
- 6 Mechanical seals
- 7 Dual chamber moisture detection
- 8 ANSI 125# flange
- 9 Stainless steel lifting bail

## SF SERIES™ CHANNEL PUMPS

- 10 3" spherical solids-handling enclosed impeller
- 11 Externally adjustable wearplate

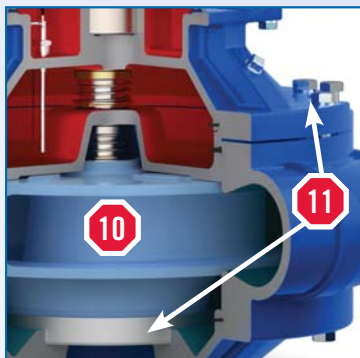

All other noted Vortex Pump features are also included in the Channel Pump

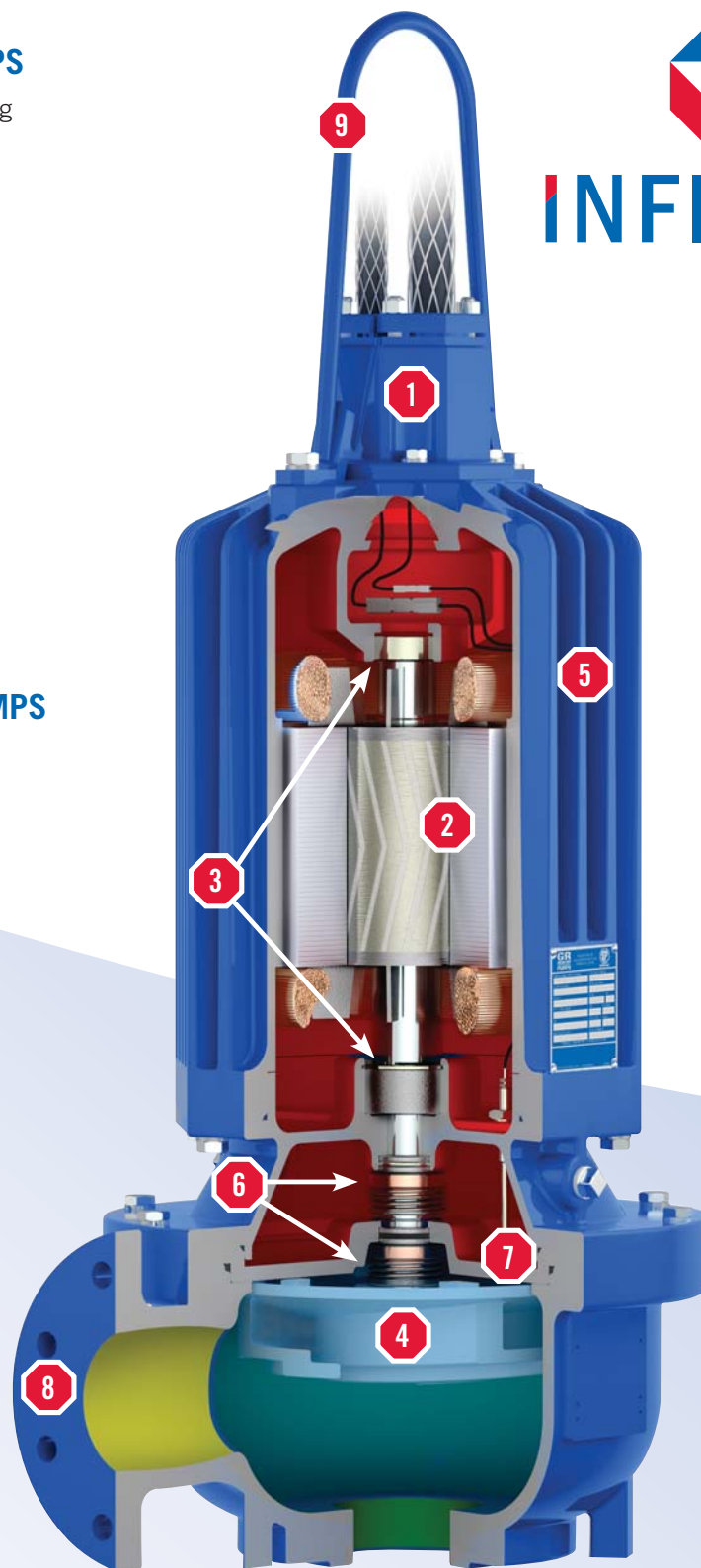

# S ■ FEATURES AND INSTALLATION OPTIONS



## WET PIT

### SF and SFV versions

- Standard 2" rail or optional guide cable on all slide rail versions
- Guide shoes include rubber seal for more efficient fluid passage through discharge pipe



## CONSTRUCTION /TRASH

### SF and SFV versions

- Rugged stand with clearance for solids passage
- Flanged discharge elbow available

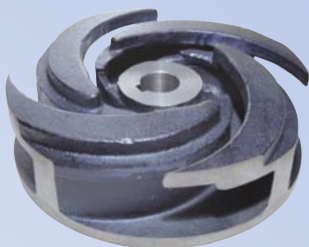

## STAGGERWING® TECHNOLOGY

SFV vortex pump models feature the patent-pending Staggerwing impeller. The impeller enables higher pump efficiency and the ability to pass 3" spherical solids. Pump models are available up to 30 HP.

*Staggerwing*  
I M P E L L E R

# SF SERIES™ SUBMERSIBLE PUMPS

## SIZES

3", 4", 6", 8"  
(76.2 mm, 101.6 mm,  
152.4 mm, 254.0 mm)

## MATERIALS OF CONSTRUCTION

Cast Iron  
Ductile Iron

## MAX. CAPACITY

3100 gpm  
(195.6 lps)

## MAX. HEAD

190'  
(57.9 m)

## MAX. SOLIDS

3"  
(76.2 mm)



**SFV3A/SFV3B**  
SFV3A Shown



**SFV4A/SFV4B**  
SFV4B Shown



**SFV4C/SFV4D/  
SFV4E**  
SFV4E Shown



**SF4A/SF4B/  
SF4C/SF4D**  
SF4B Shown



**SF6B**



**SF8B**

## SF SERIES VORTEX

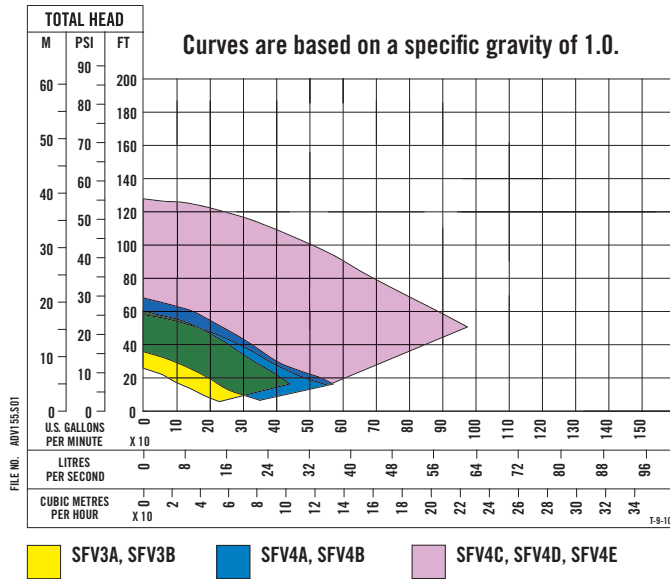

## SF SERIES CHANNEL

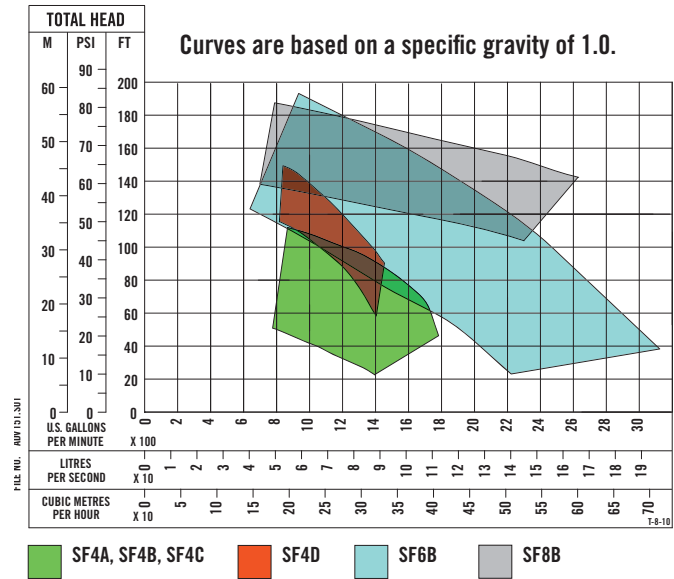

Product information is subject to change; consult factory for details.



**The Gorman-Rupp Company**  
Mansfield Division  
P.O. Box 1217  
Mansfield, Ohio 44901-1217, USA  
Tel: 419-755-1011  
Fax: 419-755-1251  
E-mail: grsales@gormanrupp.com

**Gorman-Rupp International**  
P.O. Box 1217  
Mansfield, Ohio 44901-1217, USA  
Tel: 419-755-1011  
Fax: 419-755-1266  
E-mail: intsales@gormanrupp.com

**Gorman-Rupp of Canada, Ltd.**  
70 Burwell Road  
St. Thomas, Ontario N5P 3R7, Canada  
Tel: 519-631-2870  
Fax: 519-631-4624  
E-mail: grcanada@grcanada.com



[GRpumps.com](http://GRpumps.com)