

↑ Gloucester House 3 bedroom without a Basement Current Carrying Charges \$465

Everett House 3 bedroom with a Basement Current Carrying Charges \$478 ↑

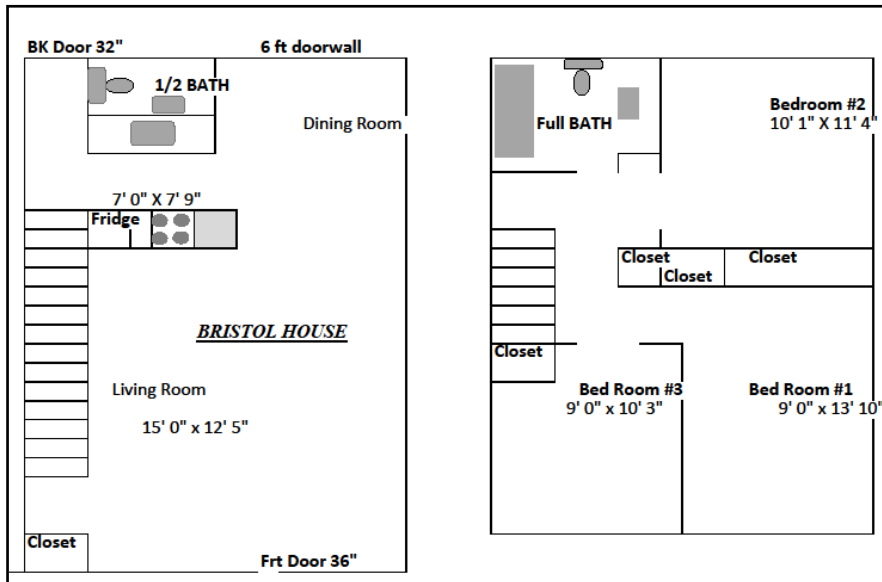

↑ Bristol House 3 bedroom with a Basement Current Carrying Charges \$478

**These are Sample Layouts  
of all 7 styles offered here at  
Williamsburg Townhouses Coop**



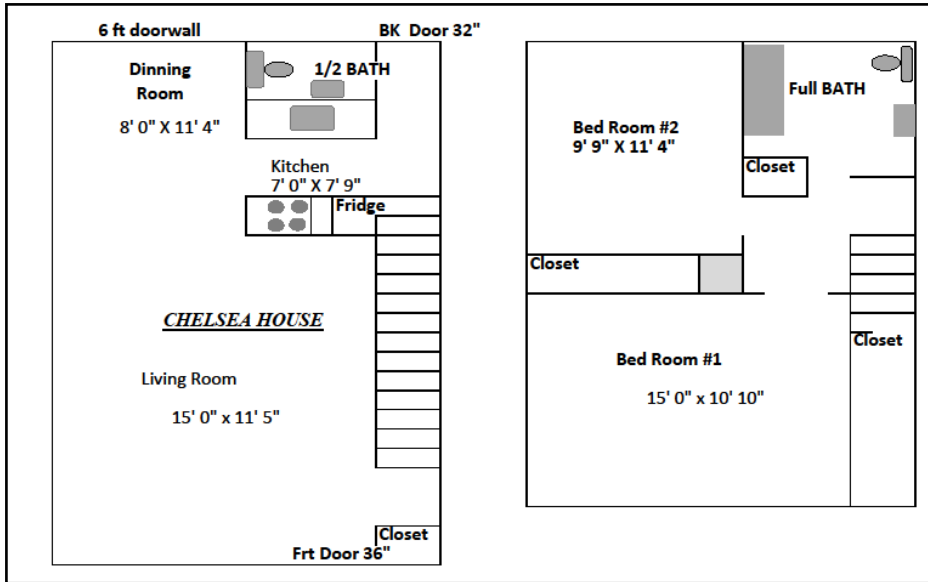

**Chelsea House** 2 Bedroom with Basement Current Carrying Charges \$471 ↑

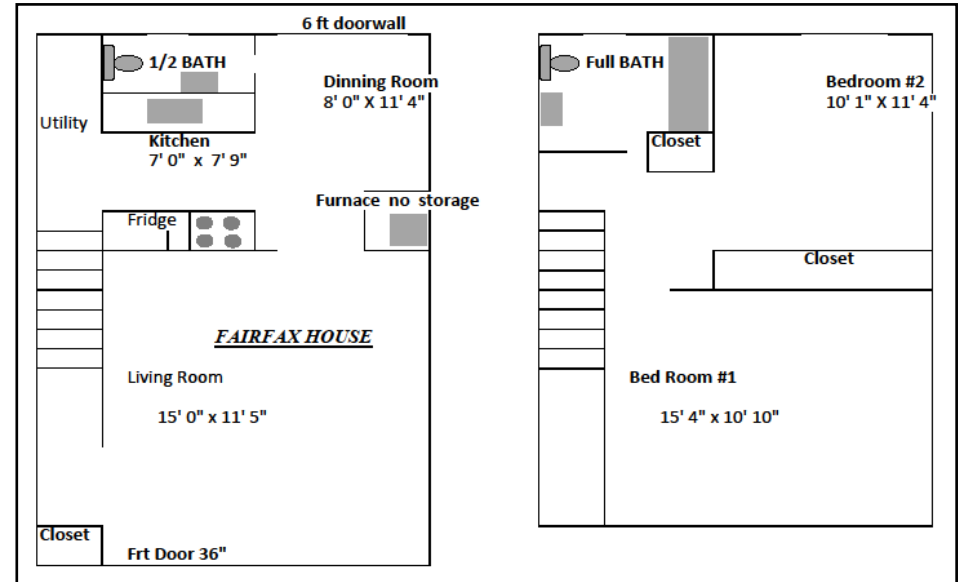

**Fairfax House** 2 Bedroom without a Basement Current Carrying Charges \$457 ↑

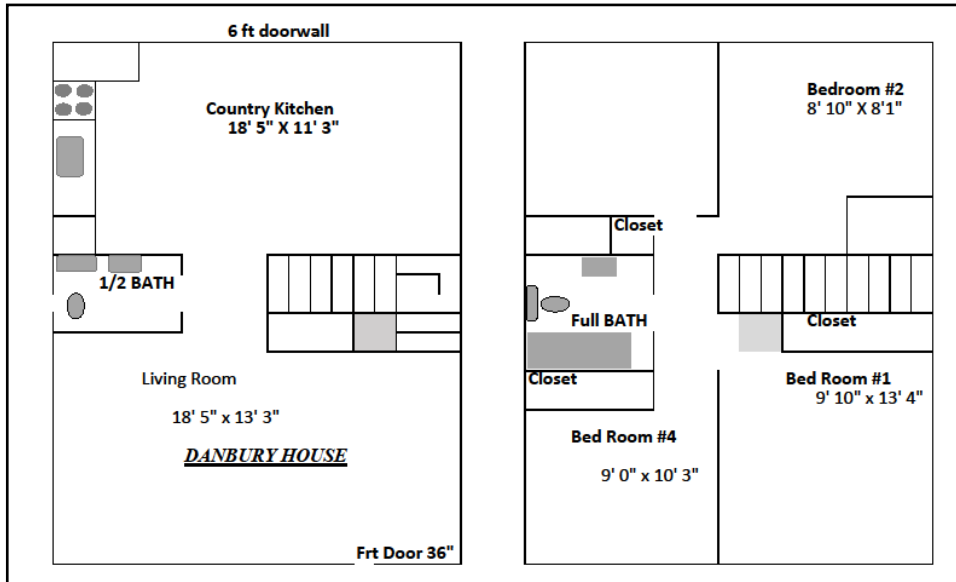

**Danbury House** 4 bedroom with Basement Current Carrying Charges \$494 ↑

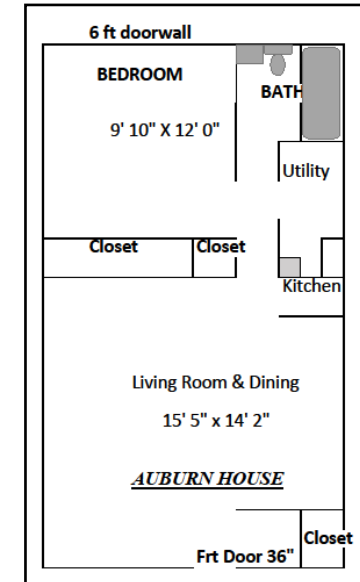

**Auburn House** one bedroom without a basement Current Carrying Charges \$444 ↑