

NOTES:

- 1) EXPANSION JOINTS: NO MORE THAN 100' ON CENTER AND AT DRIVEWAYS.
- 2) DUMMY JOINTS: 1" DEEP BY 1/8" - 1/4" WIDTH AT INTERVALS EQUAL TO SIDEWALK WIDTH.
- 3) USE 1/4" RADIUS ON ALL EDGES.
- 4) USE 6" DEPTH OF CONCRETE ON ALL DRIVEWAYS.
- 5) CURE FOR 72 HOURS USING CURING COMPOUND, PLASTIC COVERING OR MOISTURE.
- 6) USE 3750 PSI CONCRETE WITH FIBERMESH ADDITIVE AT 1-1/2 LBS./G.Y. MAXIMUM SLUMP 4".

CONCRETE SIDEWALK

SCALE: 1" = 1'-0"

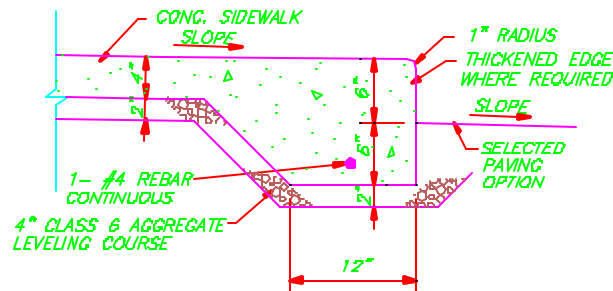

TYP. DETACHED SIDEWALK W/ THICKENED EDGE

SCALE: 1" = 1'-0"

TYPICAL SIDEWALK AND SIDEWALK W/THICKENED EDGE

TOWN OF NEW CASTLE

NOT TO SCALE

DWG: DR-40