



Philadelphia Hardware Group Inc.

6590 Top Gun Street
 San Diego, CA 92121
www.philihardware.com
 Tel

858.642.0450
 858.545.2309
 Fax
 858.642.0454

Commercial Hinge

Ball Bearing

SPECIFICATIONS

- 5 Knuckles, 2 ball bearing, non-rising removable pin with button tip and plug.
- ANSI A156.1 Grade 1 or Grade 2.
- Square Corner.
- Full Mortise, template (ANSI A156.7).
- Standard Weight – 2 Ball Bearing (2BB)
- Heavy Weight – 4 Ball Bearing (4BB)
- Finish – 652 (Satin Chrome on Steel)
 630 (304 Satin Stainless Steel)



4-1/2" x 4-1/2"
4 Ball Bearing 652

MATERIAL: Steel with Steel Pin

FULL MORTISE ITEMS

CODE	SIZE	RADIUS	BEARING	MATERIAL	ANSI GAUGE
CH4416	4-1/2" x 4"	square	2 BB	steel	A8112 0.134" (3.4mm)
CH4516	4-1/2" x 4-1/2"	square	2 BB	steel	A8112 0.134" (3.4mm)
CHB4516	4-1/2" x 4-1/2"	square	2 BB	brass	A2112 0.134" (3.4mm)
CH5416	5" x 4"	square	2 BB	steel	A8112 0.146" (3.7mm)
CH5216	5" x 4-1/2"	square	2 BB	steel	A8112 0.146" (3.7mm)
CH5016	5" x 5"	square	2 BB	steel	A8112 0.146" (3.7mm)
CH4616	4-1/2" x 4-1/2"	square	4 BB	steel	A8112 0.180" (4.6mm)
CH5516	5" x 4"	square	4 BB	steel	A8112 0.190" (4.8mm)
CHB5516	5" x 4"	square	4 BB	brass	A2112 0.190" (4.8mm)
CH5616	5" x 4-1/2"	square	4 BB	steel	A8112 0.190" (4.8mm)
CH5816	5" x 5"	square	4 BB	steel	A8112 0.190" (4.8mm)
CH4616-G1	4-1/2" x 4-1/2"	square	4 BB	steel	A8111 0.180" (4.6mm)
CH5516-G1	5" x 4"	square	4 BB	steel	A8111 0.190" (4.8mm)
CH5616-G1	5" x 4-1/2"	square	4 BB	steel	A8111 0.190" (4.8mm)
CH5816-G1	5" x 5"	square	4 BB	steel	A8111 0.190" (4.8mm)

FULL MORTISE N.R.P. ITEMS

CODE	SIZE	RADIUS	BEARING	MATERIAL	ANSI GAUGE
CN4416	4-1/2" x 4"	square	2 BB	steel	A8112 0.134" (3.4mm)
CN4516	4-1/2" x 4-1/2"	square	2 BB	steel	A8112 0.134" (3.4mm)
CNB4516	4-1/2" x 4-1/2"	square	2 BB	brass	A2112 0.134" (3.4mm)
CN5416	5" x 4"	square	2 BB	steel	A8112 0.146" (3.7mm)
CN5216	5" x 4-1/2"	square	2 BB	steel	A8112 0.146" (3.7mm)
CN5016	5" x 5"	square	2 BB	steel	A8112 0.146" (3.7mm)
CN4616	4-1/2" x 4-1/2"	square	4 BB	steel	A8112 0.180" (4.6mm)
CN5516	5" x 4"	square	4 BB	steel	A8112 0.190" (4.8mm)
CNB5516	5" x 4"	square	4 BB	brass	A2112 0.190" (4.8mm)
CN5616	5" x 4-1/2"	square	4 BB	steel	A8112 0.190" (4.8mm)
CN5816	5" x 5"	square	4 BB	steel	A8112 0.190" (4.8mm)
CN4616-G1	4-1/2" x 4-1/2"	square	4 BB	steel	A8111 0.180" (4.6mm)
CN5516-G1	5" x 4"	square	4 BB	steel	A8111 0.190" (4.8mm)
CN5616-G1	5" x 4-1/2"	square	4 BB	steel	A8111 0.190" (4.8mm)
CN5816-G1	5" x 5"	square	4 BB	steel	A8111 0.190" (4.8mm)

Specify suffix "HT" for Hospital Tip.

SAN DIEGO

CHICAGO

ATLANTA

DALLAS



6590 Top Gun Street
San Diego, CA 92121
www.philihardware.com

Philadelphia Hardware Group Inc.

Tel
858.642.0450
858.545.2309
Fax
858.642.0454

MATERIAL: Stainless Steel with Stainless Steel Pin

FULL MORTISE ITEMS

CODE	SIZE	RADIUS	BEARING	MATERIAL	ANSI	GAUGE
CH4432	4-1/2" x 4"	square	2 BB	stainless steel	A5112	0.134" (3.4mm)
CH4532	4-1/2" x 4-1/2"	square	2 BB	stainless steel	A5112	0.134" (3.4mm)
CH5432	5" x 4"	square	2 BB	stainless steel	A5112	0.146" (3.7mm)
CH5232	5" x 4-1/2"	square	2 BB	stainless steel	A5112	0.146" (3.7mm)
CH5032	5" x 5"	square	2 BB	stainless steel	A5112	0.146" (3.7mm)
CH4632	4-1/2" x 4-1/2"	square	4 BB	stainless steel	A5112	0.180" (4.6mm)
CH5532	5" x 4"	square	4 BB	stainless steel	A5112	0.190" (4.8mm)
CH5632	5" x 4-1/2"	square	4 BB	stainless steel	A5112	0.190" (4.8mm)
CH5832	5" x 5"	square	4 BB	stainless steel	A5112	0.190" (4.8mm)
CH4632-G1	4-1/2" x 4-1/2"	square	4 BB	stainless steel	A5111	0.180" (4.6mm)
CH5532-G1	5" x 4"	square	4 BB	stainless steel	A5111	0.190" (4.8mm)
CH5632-G1	5" x 4-1/2"	square	4 BB	stainless steel	A5111	0.190" (4.8mm)
CH5832-G1	5" x 5"	square	4 BB	stainless steel	A5111	0.190" (4.8mm)

FULL MORTISE N.R.P. ITEMS

CODE	SIZE	RADIUS	BEARING	MATERIAL	ANSI	GAUGE
CN4432	4-1/2" x 4"	square	2 BB	stainless steel	A5112	0.134" (3.4mm)
CN4532	4-1/2" x 4-1/2"	square	2 BB	stainless steel	A5112	0.134" (3.4mm)
CN5432	5" x 4"	square	2 BB	stainless steel	A5112	0.146" (3.7mm)
CN5232	5" x 4-1/2"	square	2 BB	stainless steel	A5112	0.146" (3.7mm)
CN5032	5" x 5"	square	2 BB	stainless steel	A5112	0.146" (3.7mm)
CN5532	5" x 4"	square	4 BB	stainless steel	A5112	0.190" (4.8mm)
CN4632	4-1/2" x 4-1/2"	square	4 BB	stainless steel	A5112	0.180" (4.6mm)
CN5632	5" x 4-1/2"	square	4 BB	stainless steel	A5112	0.190" (4.8mm)
CN5832	5" x 5"	square	4 BB	stainless steel	A5112	0.190" (4.8mm)
CN4632-G1	4-1/2" x 4-1/2"	square	4 BB	stainless steel	A5111	0.180" (4.6mm)
CN5532-G1	5" x 4"	square	4 BB	stainless steel	A5111	0.190" (4.8mm)
CN5632 -G1	5" x 4-1/2"	square	4 BB	stainless steel	A5111	0.190" (4.8mm)
CN5832-G1	5" x 5"	square	4 BB	stainless steel	A5111	0.190" (4.8mm)

Specify suffix "HT" for Hospital Tip.

PACKING

Box for All Ball Bearing Hinges, 3pcs Hinges in one Box. Each Hinge comes with poly bag

SCREWS

4-1/2" Commercial Hinges

8 pcs of #12 x 1-1/4" Wood screws
8 pcs (8pcs) of #12 x 1/2" 12-24NC Machine screws.

5" Commercial Hinges

8 pcs of #12 x 1-1/4" Wood screws
8 pcs (8pcs) of #12 x 1/2" 12-24NC Machine screws.

SAN DIEGO

CHICAGO

ATLANTA

DALLAS



Philadelphia Hardware Group Inc.

6590 Top Gun Street
 San Diego, CA 92121
www.philihardware.com

Tel
 858.642.0450
 858.545.2309
 Fax
 858.642.0454

DIMENSIONS (Standard weight 2 Ball Bearing)

4.5" x 4.0" x SQ (114.30mm x 101.6mm)

5.0" x 5.0" x SQ (127mm x 127mm)

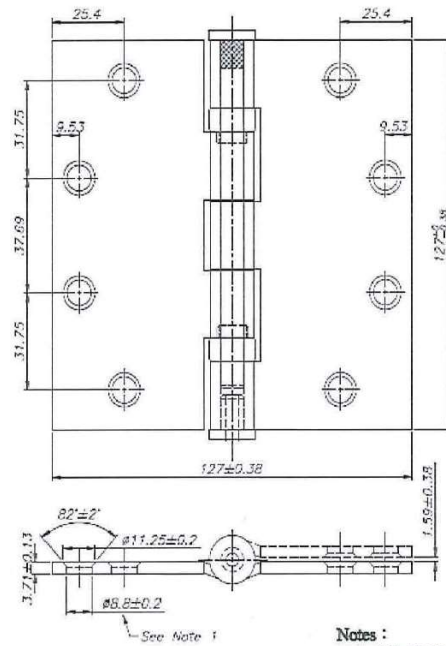
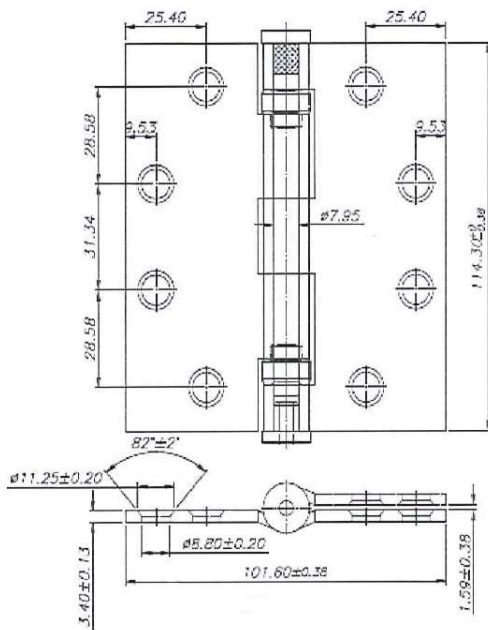

Notes:
 1. For Steel: Holes $\phi 8.8$; For Stainless Steel: Holes $\phi 7.23$

COMMERCIAL HINGE

4 1/2" X 4 1/2"

Not To Scale

5" x 4-1/2" x SQ Standard Weight Ball Bearing

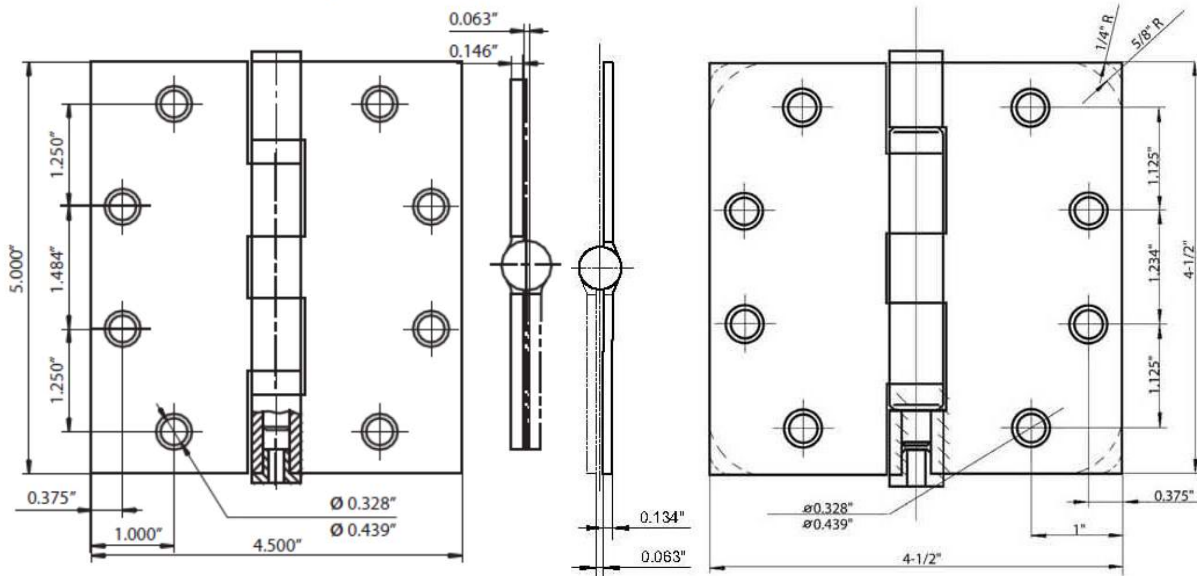

SAN DIEGO

CHICAGO

ATLANTA

DALLAS



6590 Top Gun Street
 San Diego, CA 92121
www.philihardware.com

Philadelphia Hardware Group Inc.

Tel
 858.642.0450
 858.545.2309
 Fax
 858.642.0454

DIMENSIONS (Heavy Weight 4 Ball Bearing)

4.5" x 4.5" x SQ

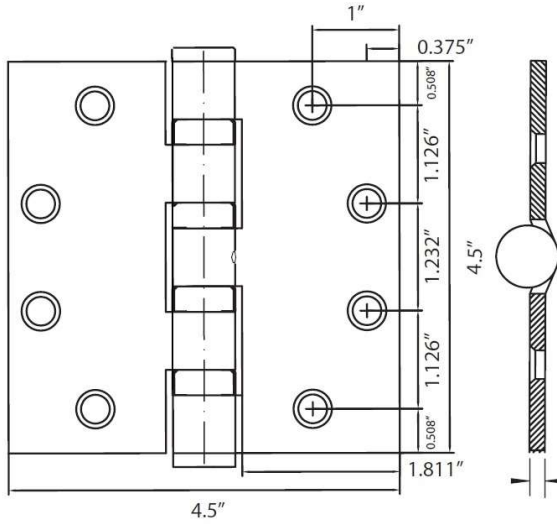

5.0" x 4.5" x SQ

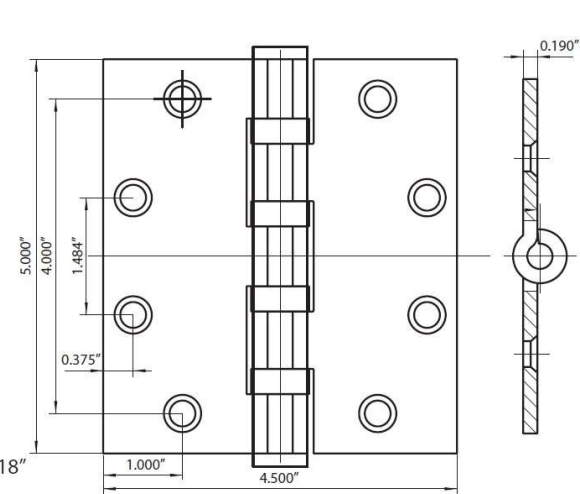

5.0" x 4.0" x SQ (127.0mm x 101.6mm)

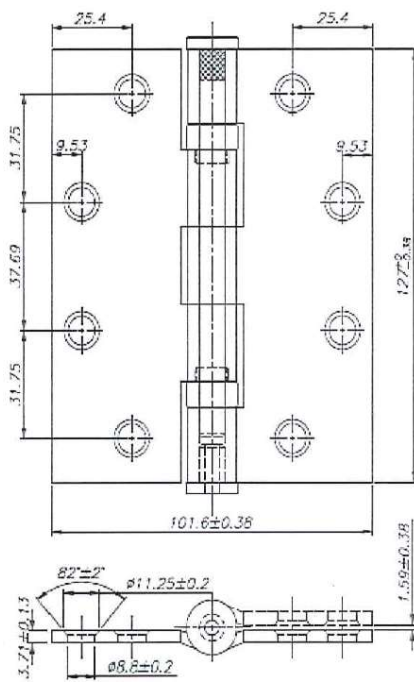

5.0" x 5.0" x SQ (127mm x 127mm)

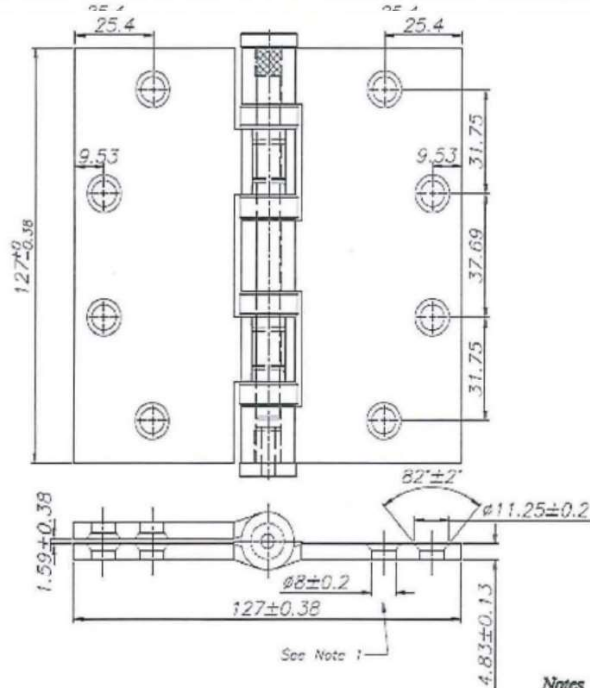

Notes :
 1. For Steel: Holes ϕ 8.0 ;
 For Stainless Steel: Holes ϕ 7.25

SAN DIEGO

CHICAGO

ATLANTA

DALLAS