



Instructions

Timer Cover w/Horizontal Holes

NOTE

BQUAZY recommends installation be done by qualified individuals.

Models

This Kit is designed to fit 1994 to 1999 FL, FX, ST (except Twin Cam) and 2004 to current XL Sportster model motorcycles.

Kit Contents

- 1 - Timer Cover
- 2 - 8-32 Socket Head Cap Screws

Figure 1.

- 1 - Gearcase Cover
- 2 - Timer Cover
- 3 - Screws

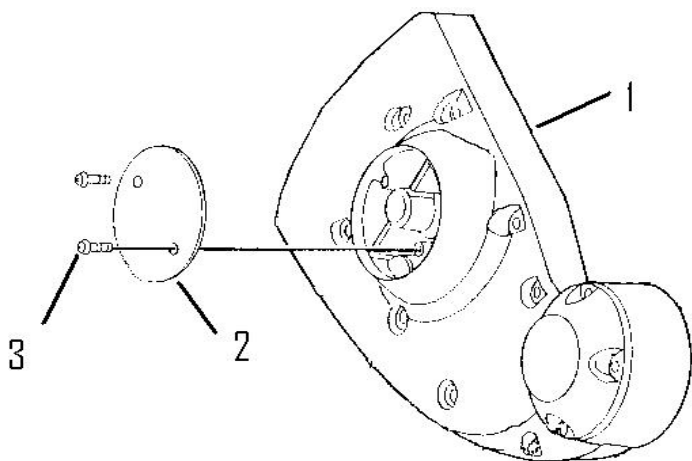

1. Remove stock timer cover. See Figure 1
2. Install new cover & screws. We recommend using Blue Loctite® on the screws to help keep them secure.