



Instructions

Sportster Timer Cover

NOTE

Re-use the stock screws from your OEM timer cover.

BQUAZY Sportster recommends installation be done by qualified individuals.

Models

These Kits are designed to fit 2004 and later XL Sportster model motorcycles.

Kit Contents

- 1 - Timer Cover
- 2 - 8-32 Socket Head Cap Screws

Figure 1.

- 1 - Gearcase Cover
- 2 - Timer Cover
- 3 - Screws

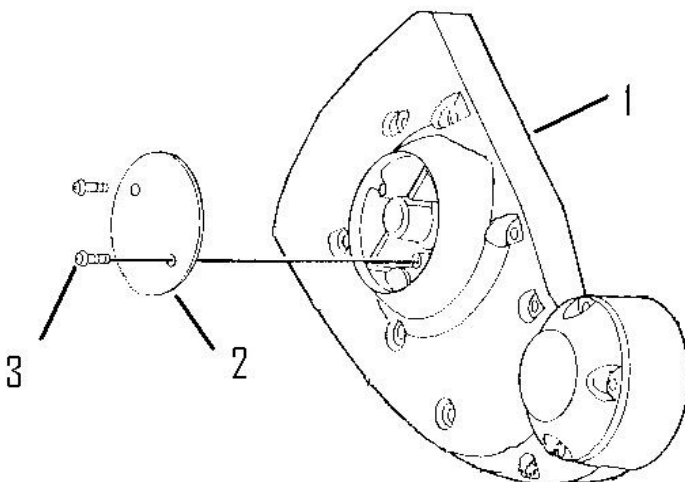

1. Remove stock timer cover. See Figure 1
2. Install new cover & screws. We recommend using Blue Loctite® on the screws to help keep them secure.