

Dachlet  
7821 Morrison Road  
Greenleaf WI 54126 54126

**Saturday  
PREMIER  
Standard & JWW  
&  
FAST**

**Sunday  
PREMIER  
Standard & JWW  
&  
T2B**

## PREMIUM LIST

**Manitowoc County Kennel Club**  
(A member club of the American Kennel Club)



**SATURDAY, JUNE 8, 2019** (#2019045005)  
**SUNDAY, JUNE 9, 2019** (#2019045006)

**Manitowoc County Kennel Club Grounds**  
**40 Albert Drive \* Manitowoc WI 54220**  
**Outdoors - Grass**

TRIAL HOURS: 7:00 AM - 6:00 PM (CDT)

These events are accepting entries for Mixed Breed dogs  
enrolled in the AKC Canine Partners Program

**Saturday – All Levels – Standard, JWW & FAST  
Premier Standard & JWW  
Sunday – All Levels – Standard, JWW  
T2B & Premier Standard & JWW  
Entries limited to 330 runs per day**

*Electronic Timing will be utilized at this trial*

### Method of Entry – First Received

**Entries Open: Monday, April 1, 2019, at 8:00 a.m. CDT**

Any entries received prior to that date & time will be returned,  
as well as any envelopes containing more than 10 entries

**No hand deliveries accepted during the first 24 hours after the trial opens.**

**Entries Close: Friday, May 24, 2019, at 6:00 p.m. CDT**

After which time entries cannot be accepted, cancelled, altered or substituted except as  
provided for in Chapter 11, Section 6 of the dog show rules



**AMERICAN  
KENNEL CLUB**

### AMERICAN KENNEL CLUB CERTIFICATION

Permission has been granted by the American Kennel Club for the holding  
of this event under American Kennel Club Rules & Regulations.

Gina M. DiNardo, Secretary

**Manitowoc County Kennel Club Officers**

President. . . . . Myron Genrich  
 Vice President. . . . . Liz Pappe  
 Secretary. . . . . Paul Cheteuti  
 2613 Oak Ridge Circle \* De Pere WI 54115 \* 920-336-9261 \* pachetcuti@att.net  
 Treasurer. . . . . Burl Cavanaugh  
 AKC Delegate. . . . . Romana Arnold  
 Board of Directors. . . . . Jim Powers, Jeanine Montag,  
 Mike Brookins, Jim Van Egen, June Ashford, Kay Detampel, Sharon Mann, Jerry Claybrook,  
 Donna Kerr, Bob Maloney

**TRIAL COMMITTEE**

Trial Chair: Burl Cavanaugh \* 1416 North Fifth Street \* Manitowoc WI 54220  
 920-682-1456 bpcava@ameritech.net

Members: Lynn Busse, Pat Cavanaugh, Kay Detampel, Annette McDonald, Jeanine Montag,  
 Ginny Orheim & Mary Pohe

**JUDGE – Both Days**  
**Ronda Bermke (#94073)**  
 3007 Ridge Court \* Greenleaf WI 54126  
**Saturday ~ All Standard & JWW Classes & FAST and**  
**Premier Standard & JWW**  
**Sunday ~ All Standard & JWW Classes & T2B and**  
**Premier Standard & JWW**

**Running Order**

	<b><u>Saturday</u></b>	<b><u>Sunday</u></b>
Jump Heights	Descending	Descending
Briefing/Walk Thru	8:15 a.m.	8:15 a.m.
Judging Starts	8:30 a.m.	8:30 a.m.
	Premier STD	Premier STD
	Premier JWW	Premier JWW
	FAST – All	T2B
	Master/Exc STD	Master/Exc STD
	Master/Exc JWW	Master/Exc JWW
	Open STD	Open STD
	Open JWW	Open JWW
	Novice STD	Novice STD
	Novice JWW	Novice JWW

**Note – FAST classes will be run by HEIGHT (then level within each height) (e.g. 24 inch Master, Excellent, Open, Novice, followed by 20 inch Master, Excellent, Open, Novice, etc.). There will be two walk thrus by LEVEL - - (Master - Excellent & Open – Novice)**

**Then all entrants will run by height**

**ENTRY FEES (Per Day)**

There will be a \$25.00 service charge for any returned checks.  
 No phone, fax or credit card entries will be accepted.

First entry of a dog \$18.00  
 (includes \$3.50 AKC event service fee on the first entry of a dog and the \$3.00 AKC event service fee on additional entries of that dog)  
 Additional entry of a dog \$18.00

**A maximum of 10 entries per envelope is allowed. Envelopes with more than 10 entries and/or entries received prior to the opening date will be returned.**  
**Paper entries received within 24 hrs. of the opening date & time must include postage or be metered and be delivered by a multi-state or multi-national postal or carrier service. No hand deliveries accepted during the first 24 hours after the trial opens.**

**ENTRIES CLOSE:** 6:00 pm CDT, Friday, May 24, 2019, after which time entries cannot be accepted, cancelled, altered, and/or substituted, except as provided for in Chapter 11, Section 6 of the Dog Show Rules. All entries MUST be complete.  
 No phone, fax or credit card entries accepted. **All express mail entries must contain signature permitting them to be left without recipient signature.**

**Make checks payable to: MCKC (Manitowoc County Kennel Club)**  
 Mail entries to TRIAL SECRETARY: Kathy Dachlet  
 7821 Morrison Road, Greenleaf WI 54126  
**(920) 864-2752** **k9secretary@centurytel.net**

\*\*\*\*\*

**Additional Exhibitor Information**

- All dogs must be on leash at all times except when in the ring or in the designated warm-up area.
- Pinch collars, electric or dummy collars are prohibited. Training collars are allowed.
- The safety of the dogs and handlers is our primary concern. By entering this trial, exhibitors acknowledge that they are familiar with the rules and regulations of the sport and that their dogs are familiar with and able to perform all obstacles safely.
- A warm-up area, consisting of a regulation agility jump, will be provided.
- If your bitch goes into season after the closing date, a full refund of entry fees (less \$5.00 administrative fee per day) will be given. Please notify the trial secretary that your bitch has come into season.
- Entry fee for a dog that is injured after the closing date will be refunded (less \$5.00 administrative fee, AKC service fee and judge's fee per day) if a veterinarian's certificate is presented to the Trial Secretary prior to the start of judging.
- No entry fee will be refunded if the trial cannot open or be completed by reason of fire, civil disturbances, an Act of God, public emergency or any other cause beyond the control of the Club.
- The owner or handler is solely responsible for having the dog ready at ringside when it is to be judged.
- It is expressly understood that exhibitors are responsible for the behavior of themselves, their dogs and their children. Any exhibitor whose dogs or children create an unnecessary disturbance, may, at the discretion of the trial committee, be asked to leave the site. In such a case, no refund of any fee paid will be made. Manitowoc County Kennel Club, and the trial secretary and their members, agents, etc. will assume no responsibility for any loss, damage or injury sustained by exhibitors or handlers, or to any of their dogs or property, and further assumes no responsibility for injury to children.
- Entry fees will not be refunded in the event that a dog is absent, disqualified, excused or barred from the competition by action of the trial committee.

### Regular & Preferred Agility Classes

The dog must be entered only in Regular classes or in Preferred classes, with no crossover between them being allowed at the same set of trials.

**Regular** Novice Standard, JWW & FAST and **Preferred** Novice Standard, JWW & FAST (divided classes A & B)  
**Regular** Open Standard, JWW & FAST and **Preferred** Open Standard, JWW & FAST  
**Regular** Excellent Standard, JWW & FAST and **Preferred** Excellent Standard, JWW & FAST  
**Regular** Master Standard, JWW & FAST and **Preferred** Master Standard, JWW & FAST  
**Regular** Premier Standard & JWW and **Preferred** Premier Standard & JWW  
**Regular** T2B and **Preferred** T2B

### Dogs Eligible to Enter

This trial is open to all dogs over the age of 15 months that are registered with the AKC or that have AKC Limited Registration, are Purbred Alternative Listing/Indefinite Listing Privileges PAL/ILP registered or approved Foundation Stock Service (FSS) breeds, except bitches in season, aggressive dogs or dogs suffering from any deformity, injury or illness which may affect the dog's physical or mental performance. These events are accepting entries for Mixed Breed dogs enrolled in the AKC Canine Partners Program. Refer to Chapter 2 of the Registration and Discipline Rules for the listing of registerable breeds that may participate.

### Height Divisions

Owners are responsible for entering the proper height division. REGULAR CLASSES - Handlers may opt to run in a higher height division, but not in a division lower than their proper jump height. PREFERRED CLASSES - handlers must run their dog in their proper eligible height.

<u>Jump Height Regular Classes</u>	<u>Jump Height Preferred Classes</u>	<u>Height at Withers</u>
8 inches	4 inches	11' and under
12 inches	8 inches	14' and under
16 inches	12 inches	18' and under
20 inches	16 inches	22' and under
24 inches	20 inches	Over 22' –

*Dogs may NOT be entered in this height if they are 22 inches and under*

### **24 inch Choice**

*Dogs may be entered at this height at their owner's discretion if their measurement is 22 inches and under at the withers. Dogs who measure into the 24" regular jump height division may not enter 24 Choice*

### Measuring & Height Card Information

When filling out the entry form, there is a section of the form for exhibitors to designate whether your dog has a valid jump height card or if your dog needs to be measured. Please check the appropriate box so that the Trial Secretary knows whether to include your dog on the *Dogs To Be Measured List*. It is no longer required that a copy of your dog's jump height card be submitted with an entry form or show it at check-in; although exhibitors are required to have the official form/card with them at the trial to present upon request. Additionally, if a measurement is necessary, it is the exhibitor's responsibility to have their dog measured prior to running. **Regulations for Agility Trials, Chapter 2, Section 4.**

### Obstacles & Course Familiarization

Obstacles shall meet the specifications for obstacles in the current edition of Regulations for Agility Trials. Contacts & table are rubberized and weaves are 24 inches on center. Obstacle familiarization for Novice dogs will **not** be offered at this trial. Handlers in all classes are permitted to walk the course, without a dog, prior to the start of the class. A walk through will be held prior to each class in conjunction with the judge's briefing.

### Site Information

Site is **OUTDOORS on grass**. There are two rings, which alternate; size of each ring is 80' x 120'. The rings will be enclosed with snow fencing, and the rings are in a chain-link fenced area. There is limited shade; please bring your own shade and tenting. The building (heated/air conditioned) will be available for indoor crating. **DOGS MAY NOT BE LEFT OVERNIGHT.** Crates may be left overnight, however, Manitowoc County Kennel Club, nor the trial secretary will not be responsible for any lost or damaged items left at the trial site.

**Food and beverages will be available for purchase on Saturday & Sunday.**

### Prizes & Awards

Rosettes will be awarded to First through Fourth place in all classes. A qualifying ribbon will be awarded to all dogs with a qualifying score. New Title rosettes, Master Double Qualifier rosettes, MACH rosettes, PACH rosettes and PAX rosettes will also be awarded to teams achieving one of these titles. MACH, PACH & PAX bars will also be awarded to teams achieving one of those titles. All prizes and awards must be claimed the day of the trial – none will be mailed.

### Veterinarian On Call

**Memorial Drive Veterinary Clinic:** 1415 Memorial Drive \* Manitowoc WI 54220 \* 920-682-6558  
 Hours: 8:00 am – 5:00 pm Saturday 8:00 am – 12:00 Noon Closed Sunday – on call when closed  
 For Emergencies after 10:00 p.m., there are two 24-hour Emergency Clinics (both approx. 45 minutes from Manitowoc):

- Green Bay Animal Emergency Center 920-494-9400 2141 Lime Kiln Road, Green Bay WI
- Fox Valley Animal Referral Center 920-993-9193 4706 New Horizons Blvd, Appleton WI

Exhibitors should follow their veterinarians' recommendation to assure their dogs are free of internal and external parasites, any communicable diseases, and have appropriate vaccinations. Wisconsin laws require dogs over 4 months of age to have current Rabies vaccination.

### Volunteer Worker Sign-Up Form

Will be available online at WeJoinIn.

A notice (email) will be sent out when the WeJoinIn page is available.

- If you **DO NOT** have access to the internet, please complete the form below and submit with your entry.

Your generosity to volunteer is greatly appreciated ☺

Name: \_\_\_\_\_

Phone: \_\_\_\_\_

Place an "X" in the box(es) in which you are willing TO WORK for that class:

<u>Saturday</u>		<u>Sunday</u>	
Premier STD		Premier STD	
Premier JWW		Premier JWW	
FAST – All		T2B	
Mas/Exc STD	24-20"	Mas/Exc STD	24-20"
Mas/Exc STD	16-4"	Mas/Exc STD	16-4"
Mas/Exc JWW	24-20"	Mas/Exc JWW	24-20"
Mas/Exc JWW	16-4"	Mas/Exc JWW	16-4"
Open STD		Open STD	
Open JWW		Open JWW	
Open JWW		Open JWW	
Novice JWW		Novice JWW	

Indicate job & day(s) willing to work by placing an "X" in appropriate box

<u>Job</u>	<u>Sat.</u>	<u>Sun.</u>
Course Builder		
Timer		
Scribe		
Gate Steward		
Ring Crew		
Score Sheet & Leash Runner		

## Move-Up Regulations & Form

### Directions to Manitowoc County Kennel Club

**From South:** Take I-43 to exit #152 (Waldo Blvd). Turn East and go 3.5 miles to North 8<sup>th</sup> Street. Turn North (left) and go 1.2 miles to Albert Drive. Turn East (right) and go 0.7 miles to the club grounds on the left.

**From West:** Take US Hwy 10 to I-43. Road now becomes Hwy 310; continue 3.5 miles to County Hwy B (3<sup>rd</sup> roundabout). Turn South (right) and go 2 miles to Albert Drive. Turn East (left) and go 0.7 miles to the club grounds on the left.

**From North:** Take I-43 to Exit #154. Turn East (left) on Hwy 310. Follow "From West" directions above.

**There is a detour on Rapids Road going North from the Holiday Inn. The best alternative route to the agility trial is I-43 North to Exit 152 and follow directions "From South" listed above.**

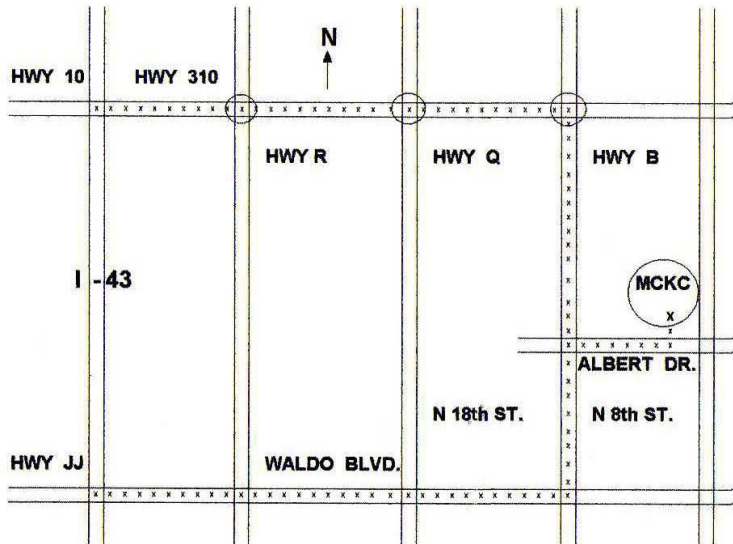

### Motels

The following motels will accept well-behaved dogs with the owner assuming all responsibility. Reservations are subject to house rules of individual motels and may limit to size and require a deposit. Please do not allow your dog(s) to become a nuisance or leave them unattended in a room. Crates, clean up and courtesy are a must to maintain a responsible relationship with our motels.

Mention our club name and event and ask if a rate discount is available, or check online at [www.hotels.com](http://www.hotels.com) for discount rates.

Quality Inn of Manitowoc	2200 S. 44 <sup>th</sup> Street, Manitowoc WI 54220	920-683-0220
Holiday Inn	4601 Calumet Avenue, Manitowoc WI 54220	920-682-6000
Baymont Inn & Suites	101 N. Maritime Drive, Manitowoc WI 54220	920-682-7000
Lighthouse Inn	1515 Memorial Drive, Two Rivers WI 54241	920-793-4524
Harbor Town Inn	4004 Calumet Avenue, Manitowoc WI 54220	920-684-7841
Village Inn	3310 Memorial Drive, Two Rivers WI 54241	920-794-8818

Dogs may be moved up to a higher class at the request of the owner, as a result of qualifying for an agility title. However, written notice (regular mail or e-mail) must be given to the Trial Secretary **no later than 6:00 p.m. CDT on Monday, June 3, 2019. Day-to-day move ups will be allowed if received before the close of the Saturday trial** (award of ribbons for the last class of the day will be considered the close of the trial). Move-ups will be added to the end of the running order of the class they move up to and every effort will be made to accommodate handlers running multiple dogs in the same class.

**No verbal changes will be accepted. Written requests must include the information listed below.**

Please note that if you do request a move up from a *Novice A* class to *Open*, **prior to the closing date of this trial**, AKC regulations state any other class you may be entered in needs to be moved to the *Novice B* class. A dog which has been entered in *Novice A*, but is ineligible due to restrictions on the dog or handler, may be moved to *Novice B* **under the following conditions**: The request must be made in writing and presented to the trial secretary at least 30 minutes prior to the start of the trial **AND** the request must state the reason and justification for the move.

**After the close of entries, a dog may be moved down in their class level (i.e., Master to Excellent). The request for the move to the class for which the dog is eligible must be in writing and submitted to the trial secretary at least 30 minutes prior to the start of the trial.**

Fill out one form **per dog** and send to the Trial Secretary [mailed to standard (7821 Morrison Rd, Greenleaf WI 54126) or e-mail address (k9secretary@centurytel.net)]. Forms must be received by 6:00 p.m. CDT Monday, June 3, 2019. This change form is only for dogs whose entries have been accepted for the Manitowoc County Kennel Club agility trials on June 8-9, 2019.

AKC Registered Name: \_\_\_\_\_  
 AKC Registration #: \_\_\_\_\_  
 Breed/Variety: \_\_\_\_\_ Call Name: \_\_\_\_\_  
 Owner(s): \_\_\_\_\_  
 Height Division: 4" 8" 12" 16" 20" 24" 24 Choice"

Please Circle Appropriate Selections on **EACH** Line

<b>Division:</b>	Regular or Preferred			
<b>Class:</b>	Standard		JWW	
<b>Day:</b>	Saturday		Sunday	
<b>Current Entry:</b>	Nov A	Nov A or B	Open	Exc
<b>Move To:</b>	Nov B	Open	Exc	Master



**American  
Kennel Club<sup>®</sup>**

**OFFICIAL AMERICAN KENNEL CLUB AGILITY ENTRY FORM**

**Manitowoc County Kennel Club**

Standard JWW Premier Std Premier JWW FAST T2B

Saturday, June 8, 2019

					N/A
				N/A	

Sunday, June 9, 2019

**Entry Fees:** \$18.00 for 1st entry of a dog; \$18.00 each additional entry of same dog same day (includes AKC event service fees). Entries are on a first received basis. Any entries received prior to the opening date and time will be returned.

**Entries Open:** Monday, April 1, 2019 - 8:00 A.M. CDT at the office of the trial secretary.

**Entries Close:** Friday, May 24, 2019 - 6:00 P.M. CDT at the office of the trial secretary. No phone, fax, or credit card entries will be accepted.

All express mail entries must have signature permitting receipt without recipient signature.

Make Checks and or Money Orders payable to: MCKC.

Mail entries with fees to: Kathy Dachlet; 7821 Morrison Road; Greenleaf, WI 54126. 920-864-2752

**IMPORTANT: Carefully read instructions before filling out!**

**ENTRY FEE ENCLOSED**

PLEASE PRINT CLEARLY

\$

**Choose Either Regular or Preferred Classes**

Check one jump height, and check class selections – Only one selection per class (both Master and Premier allowed)

REGULAR Classes		PREFERRED Classes	
JUMP HEIGHT		JUMP HEIGHT	
STD		STD	
JWW		JWW	
FAST		FAST	
T2B		T2B	

This dog needs to be measured:	Yes	No	SEX	HEIGHT AT WITHERS
BREED			VARIETY	CALL NAME

AKC® NAME (include AKC titles only)

<input type="checkbox"/> AKC NO.	(Enter Complete Registration # below)	DATE OF BIRTH
<input type="checkbox"/> ILP NO. <input type="checkbox"/> PAL NO.		PLACE OF BIRTH (List Country)
<input type="checkbox"/> FOREIGN REG. NO. & COUNTRY		

BREEDER

SIRE

DAM

ACTUAL OWNERS

OWNERS ADDRESS NEW ADDRESS

CITY STATE ZIP + 4

HANDLER ENTER JR. HANDLER # if applicable

AKC Rules, Regulations, Policies and Guidelines are available on the American Kennel Club Web site, [www.akc.org](http://www.akc.org)

**AGREEMENT**

I certify that I am the actual owner of the dog, or that I am the duly authorized agent of the actual owner whose name I have entered. In consideration of the acceptance of this entry, I (we) agree to abide by the rules and regulations of The American Kennel Club in effect at the time of this event, and any additional rules and regulations appearing in the premium list of this event and entry form and any decision made in accord with them. I (we) agree that the club holding this event has the right to refuse this entry for cause which the club shall deem sufficient. I (we) certify and represent that the dog entered is not a hazard to persons or other dogs. In consideration of the acceptance of this entry and of the holding of this event and of the opportunity to have the dog judged and to win prizes, ribbons, or trophies, I (we) agree to hold the AKC, the event-giving club, their members, directors, governors, officers, agents, superintendents or event secretary and the owner and/or lessor of the premises and any provider of services that are necessary to hold this event and any employees or volunteers of the aforementioned parties, and any AKC approved judge, judging at this event, harmless from any claim for loss or injury which may be alleged to have been caused directly or indirectly to any person or thing by the act of this dog while in or about the event premises or grounds or near any entrance thereto, and I (we) personally assume all responsibility and liability for any such claim; and I (we) further agree to hold the aforementioned parties harmless from any claim for loss, injury or damage to this dog.

Additionally, I (we) hereby assume the sole responsibility for and agree to indemnify, defend and save the aforementioned parties harmless from any and all loss and expense (including legal fees) by reason of the liability imposed by law upon any of the aforementioned parties for damage because of bodily injuries, including death at any time resulting therefrom, sustained by any person or persons, including myself (ourselves), or on account of damage to property, arising out of or in consequence of my (our) participation in this event, however such, injuries, death or property damage may be caused, and whether or not the same may have been caused or may be alleged to have been caused by the negligence of the aforementioned parties or any of their employees, agents, or any other person. **I (WE) AGREE THAT ANY CAUSE OF ACTION, CONTROVERSY OR CLAIM ARISING OUT OF OR RELATED TO THE ENTRY, EXHIBITION OR ATTENDANCE AT THE EVENT BETWEEN THE AKC AND THE EVENT-GIVING CLUB (UNLESS OTHERWISE STATED IN THIS PREMIUM LIST) AND MYSELF (OURSELVES) OR AS TO THE CONSTRUCTION, INTERPRETATION AND EFFECT OF THIS AGREEMENT SHALL BE SETTLED BY ARBITRATION PURSUANT TO THE APPLICABLE RULES OF THE AMERICAN ARBITRATION ASSOCIATION. HOWEVER, PRIOR TO ARBITRATION ALL APPLICABLE AKC BYLAWS, RULES, REGULATIONS AND PROCEDURES MUST FIRST BE FOLLOWED AS SET FORTH IN THE AKC CHARTER AND BYLAWS, RULES, REGULATIONS, PUBLISHED POLICIES AND GUIDELINES.**

**INSTRUCTIONS**

Handlers whose dogs measure into the 8" through 20" regular jump height divisions may opt to enter in a higher or 24-choice height division for all Regular titling classes, but not in a division lower than their proper height division. Dogs who measure into the 24" regular jump height division may not enter 24-choice. Dogs entered in the Preferred classes must compete at the required jump height and may not compete in a jump height division higher or lower than their proper height division.

All dogs that have not been officially measured for an Agility Jump Height Card may still compete; however, they must be measured by a Judge of record, an Agility Field Representative, or a Volunteer Measuring Official, prior to running. If measured by the judge of record, that measurement will be valid for this trial or *back-to-back trials* only. If a measurement is necessary, it is the exhibitor's responsibility to have their dog(s) measured prior to running.

Dogs listed in the **AKC Canine Partners Program<sup>SM</sup>** may be eligible to enter all-breed AKC agility trials at the club's option. These dogs should be listed as All American Dog and must include their AKC number on the entry form and check the AKC No. box.

**Junior Handlers** should enter their Junior Handler Number on the front of this form. Should you not have your Junior Handler number, it may be obtained from the American Kennel Club (919) 233-9767. If the Junior Handler is not the owner of the dog identified on the face of this form, what is the relationship of the Junior Handler to the Owner?

**SIGNATURE** of owner or his agent duly authorized to make this entry.

**SIGN HERE X**

Telephone Number: \_\_\_\_\_ New Email

Email: \_\_\_\_\_

In Case of Emergency - Name: \_\_\_\_\_ Phone #: \_\_\_\_\_

**Exhibitor or owner MUST sign on the signature line beneath the instructions.**