

Dachlet
7821 Morrison Road
Greenleaf WI 54126 54126

PREMIUM LIST

Manitowoc County Kennel Club
(A member club of the American Kennel Club)



SATURDAY, SEPTEMBER 15, 2018 (#2018045012)
SUNDAY, SEPTEMBER 16, 2018 (#2018045013)

Manitowoc County Kennel Club Grounds
40 Albert Drive * Manitowoc WI 54220
Outdoors - Grass

TRIAL HOURS: 7:00 AM - 6:00 PM (CDT)

These events are accepting entries for Mixed Breed dogs
enrolled in the AKC Canine Partners Program

Saturday – All Levels – Standard, JWW
Premier Standard & JWW
Sunday – All Levels – Standard, JWW
Premier Standard & JWW
Entries limited to 330 runs per day

Electronic Timing will be utilized at this trial

Method of Entry – First Received

Entries Open: Monday, July 2, 2018, at 8:00 a.m. CDT

Any entries received prior to that date & time will be returned,
as well as any envelopes containing more than 10 entries

No hand deliveries accepted during the first 24 hours after the trial opens.

Entries Close: Friday, August 31, 2018, at 6:00 p.m. CDT

After which time entries cannot be accepted, cancelled, altered or substituted except as
provided for in Chapter 11, Section 6 of the dog show rules



AMERICAN
KENNEL CLUB

AMERICAN KENNEL CLUB CERTIFICATION

Permission has been granted by the American Kennel Club for the holding
of this event under American Kennel Club Rules & Regulations.

Gina M. DiNardo, Secretary

Saturday
PREMIER
Standard & JWW

Sunday
PREMIER
Standard & JWW

Manitowoc County Kennel Club Officers

President. Donna Kerr
 Vice President. Myron Genrich
 Secretary. Paul Cheteuti
 2613 Oak Ridge Circle * De Pere WI 54115 * 920-336-9261 * pachetcuti@att.net
 Treasurer. Burl Cavanaugh
 AKC Delegate. Romana Arnold
 Board of Directors. Jim Powers, Jeanine Montag, Mike
 Brookins, Jim Van Egen, June Ashford, Kay Detampel, Sharon Mann, Jerry Claybrook,
 Heather Geraldson

TRIAL COMMITTEE

Trial Chair: Burl Cavanaugh * 1416 North Fifth Street * Manitowoc WI 54220
 920-682-1456 bpcava@ameritech.net

Members: Linda Bunkfeldt-Popp, Lynn Busse, Pat Cavanaugh, Kay Detampel,
 Annette McDonald, Jeanine Montag, Ginny Orheim

JUDGE – Both Days
Karl Blakely (#62187)
 6307 Painted Turtle Road * Lino Lakes MN 55014
Saturday ~ All Classes & Levels and Premier Standard & JWW
Sunday ~ All Classes & Levels and Premier Standard & JWW

Running Order

	<u>Saturday</u>	<u>Sunday</u>
Jump Heights	Descending	Descending
Briefing/Walk Thru	8:45 a.m.	8:45 a.m.
Judging Starts	9:00 a.m.	9:00 a.m.
	Premier STD	Premier STD
	Premier JWW	Premier JWW
	Master/Exc STD	Master/Exc STD
	Master/Exc JWW	Master/Exc JWW
	Open STD	Open STD
	Open JWW	Open JWW
	Novice STD	Novice STD
	Novice JWW	Novice JWW

ENTRY FEES (Per Day)

There will be a \$25.00 service charge for any returned checks.
 No phone, fax or credit card entries will be accepted.

First entry of a dog \$18.00
 (includes \$3.50 AKC event service fee on the first entry of a dog and the \$3.00 AKC event service fee on additional entries of that dog)
 Additional entry of a dog \$17.00

A maximum of 10 entries per envelope is allowed. Envelopes with more than 10 entries and/or entries received prior to the opening date will be returned.
Paper entries received within 24 hrs. of the opening date & time must include postage or be metered and be delivered by a multi-state or multi-national postal or carrier service. No hand deliveries accepted during the first 24 hours after the trial opens.

ENTRIES CLOSE: 6:00 pm CDT, Friday, August 31, 2018, after which time entries cannot be accepted, cancelled, altered, and/or substituted, except as provided for in Chapter 11, Section 6 of the Dog Show Rules. All entries MUST be complete.
 No phone, fax or credit card entries accepted. **All express mail entries must contain signature permitting them to be left without recipient signature.**

Make checks payable to: MCKC (Manitowoc County Kennel Club)

Mail entries to TRIAL SECRETARY: Kathy Dachlet
 7821 Morrison Road, Greenleaf WI 54126
(920) 864-2752 **k9secretary@centurytel.net**

Additional Exhibitor Information

- All dogs must be on leash at all times except when in the ring or in the designated warm-up area.
- Pinch collars, electric or dummy collars are prohibited. Training collars are allowed.
- The safety of the dogs and handlers is our primary concern. By entering this trial, exhibitors acknowledge that they are familiar with the rules and regulations of the sport and that their dogs are familiar with and able to perform all obstacles safely.
- A warm-up area, consisting of a regulation agility jump, will be provided.
- If your bitch goes into season after the closing date, a full refund of entry fees (less \$5.00 administrative fee per day) will be given. Please notify the trial secretary that your bitch has come into season.
- Entry fee for a dog that is injured after the closing date will be refunded (less \$5.00 administrative fee, AKC service fee and judge's fee per day) if a veterinarian's certificate is presented to the Trial Secretary prior to the start of judging.
- No entry fee will be refunded if the trial cannot open or be completed by reason of fire, civil disturbances, an Act of God, public emergency or any other cause beyond the control of the Club.
- The owner or handler is solely responsible for having the dog ready at ringside when it is to be judged.
- It is expressly understood that exhibitors are responsible for the behavior of themselves, their dogs and their children. Any exhibitor whose dogs or children create an unnecessary disturbance, may, at the discretion of the trial committee, be asked to leave the site. In such a case, no refund of any fee paid will be made. Manitowoc County Kennel Club, and the trial secretary and their members, agents, etc. will assume no responsibility for any loss, damage or injury sustained by exhibitors or handlers, or to any of their dogs or property, and further assumes no responsibility for injury to children.
- Entry fees will not be refunded in the event that a dog is absent, disqualified, excused or barred from the competition by action of the trial committee.

Regular & Preferred Agility Classes

The dog must be entered only in Regular classes or in Preferred classes, with no crossover between them being allowed at the same set of trials.

Regular Novice Standard, JWW and **Preferred** Novice Standard, JWW (divided classes A & B)

Regular Open Standard, JWW and **Preferred** Open Standard, JWW

Regular Excellent Standard, JWW and **Preferred** Excellent Standard, JWW

Regular Master Standard, JWW and **Preferred** Master Standard, JWW

Regular Premier Standard & JWW and **Preferred** Premier Standard & JWW

Dogs Eligible to Enter

This trial is open to all dogs over the age of 15 months that are registered with the AKC or that have AKC Limited Registration, are Purbred Alternative Listing/Indefinite Listing Privileges PAL/ILP registered or approved Foundation Stock Service (FSS) breeds, except bitches in season, aggressive dogs or dogs suffering from any deformity, injury or illness which may affect the dog's physical or mental performance. These events are accepting entries for Mixed Breed dogs enrolled in the AKC Canine Partners Program. Refer to Chapter 2 of the Registration and Discipline Rules for the listing of registerable breeds that may participate.

Height Divisions

Owners are responsible for entering the proper height division. REGULAR CLASSES - Handlers may opt to run in a higher height division, but not in a division lower than their proper jump height. PREFERRED CLASSES - handlers must run their dog in their proper eligible height.

<u>Jump Height Regular Classes</u>	<u>Jump Height Preferred Classes</u>	<u>Height at Withers</u>
8 inches	4 inches	11' and under
12 inches	8 inches	14' and under
16 inches	12 inches	18' and under
20 inches	16 inches	22' and under
24 inches	20 inches	Over 22' -

Dogs may NOT be entered in this height if they are 22 inches and under

24 inch **Choice**

Dogs may be entered at this height at their owner's discretion if their measurement is 22 inches and under at the withers. Dogs who measure into the 24" regular jump height division may not enter 24 Choice

Measuring & Height Card Information

When filling out the entry form, there is a section of the form for exhibitors to designate whether your dog has a valid jump height card or if your dog needs to be measured. Please check the appropriate box so that the Trial Secretary knows whether to include your dog on the *Dogs To Be Measured List*. It is no longer required that a copy of your dog's jump height card be submitted with an entry form or show it at check-in; although exhibitors are required to have the official form/card with them at the trial to present upon request. Additionally, if a measurement is necessary, it is the exhibitor's responsibility to have their dog measured prior to running. **Regulations for Agility Trials, Chapter 2, Section 4.**

Obstacles & Course Familiarization

Obstacles shall meet the specifications for obstacles in the current edition of Regulations for Agility Trials. Contacts & table are rubberized and weaves are 24 inches on center. Obstacle familiarization for Novice dogs will **not** be offered at this trial. Handlers in all classes are permitted to walk the course, without a dog, prior to the start of the class. A walk through will be held prior to each class in conjunction with the judge's briefing.

Site Information

Site is **OUTDOORS on grass**. There are two rings, which alternate; size of each ring is 80' x 120'. The rings will be enclosed with snow fencing, and the rings are in a chain-link fenced area. There is limited shade; please bring your own shade and tenting. The building (heated/air conditioned) will be available for indoor crating. **DOGS MAY NOT BE LEFT OVERNIGHT.** Crates may be left overnight, however, Manitowoc County Kennel Club, nor the trial secretary will not be responsible for any lost or damaged items left at the trial site.

Food and beverages will be available for purchase on Saturday & Sunday.

Prizes & Awards

Rosettes will be awarded to First through Fourth place in all classes. A qualifying ribbon will be awarded to all dogs with a qualifying score. New Title rosettes, Master Double Qualifier rosettes, MACH rosettes, PACH rosettes and PAX rosettes will also be awarded to teams achieving one of these titles. MACH, PACH & PAX bars will also be awarded to teams achieving one of those titles. All prizes and awards must be claimed the day of the trial - none will be mailed.

Veterinarian On Call

Memorial Drive Veterinary Clinic: 1415 Memorial Drive * Manitowoc WI 54220 * 920-682-6558

Hours: 8:00 am - 5:00 pm Saturday 8:00 am - 12:00 Noon Closed Sunday - on call when closed
For Emergencies after 10:00 p.m., there are two 24-hour Emergency Clinics (both approx. 45 minutes from Manitowoc):

- Green Bay Animal Emergency Center 920-494-9400 2141 Lime Kiln Road, Green Bay WI
- Fox Valley Animal Referral Center 920-993-9193 4706 New Horizons Blvd, Appleton WI

Exhibitors should follow their veterinarians' recommendation to assure their dogs are free of internal and external parasites, any communicable diseases, and have appropriate vaccinations. Wisconsin laws require dogs over 4 months of age to have current Rabies vaccination.

Volunteer Worker Sign-Up Form

A notice (email) will be sent out when the MySignUp page is available.

- **If you DO NOT have access to the internet, please complete the form below and submit with your entry.**

Your generosity to volunteer is greatly appreciated ☺

Name: _____

Phone: _____

Place an "X" in the box(es) in which you are willing TO WORK for that class:

Saturday		Sunday	
Premier STD		Premier STD	
Premier JWW		Premier JWW	
Mas/Exc STD	24-20"	Mas/Exc STD	24-20"
Mas/Exc STD	16-4"	Mas/Exc STD	16-4"
Mas/Exc JWW	24-20"	Mas/Exc JWW	24-20"
Mas/Exc JWW	16-4"	Mas/Exc JWW	16-4"
Open STD		Open STD	
Open JWW		Open JWW	
Novice STD		Novice STD	
Novice JWW		Novice JWW	

Indicate job & day(s) willing to work by placing an "X" in appropriate box

Job	Fri.	Sat.	Sun.
Course Builder			
Timer			
Scribe			
Gate Steward			
Ring Crew			
Score Sheet & Leash Runner			

Move-Up Regulations & Form

Directions to Manitowoc County Kennel Club

NOTE: Highway 10 will be under construction – for up-to-date information:

The Wisconsin State Patrol will be posting traffic alerts, closures and news on their website and on social media via Facebook and Twitter.

WEBSITE - <http://projects.511wi.gov>. **TWITTER**: <https://twitter.com/WIS441141News>

FACEBOOK: <https://www.facebook.com/WIS441141News>

From South: Take I-43 to exit #152 (Waldo Blvd). Turn East and go 3.5 miles to North 8th Street. Turn North (left) and go 1.2 miles to Albert Drive. Turn East (right) and go 0.7 miles to the club grounds on the left.

From West: Take US Hwy 10 to I-43. Road now becomes Hwy 310; continue 3.5 miles to County Hwy B (3rd roundabout). Turn South (right) and go 2 miles to Albert Drive. Turn East (left) and go 0.7 miles to the club grounds on the left.

From North: Take I-43 to Exit #154. Turn East (left) on Hwy 310. Follow "From West" directions above.

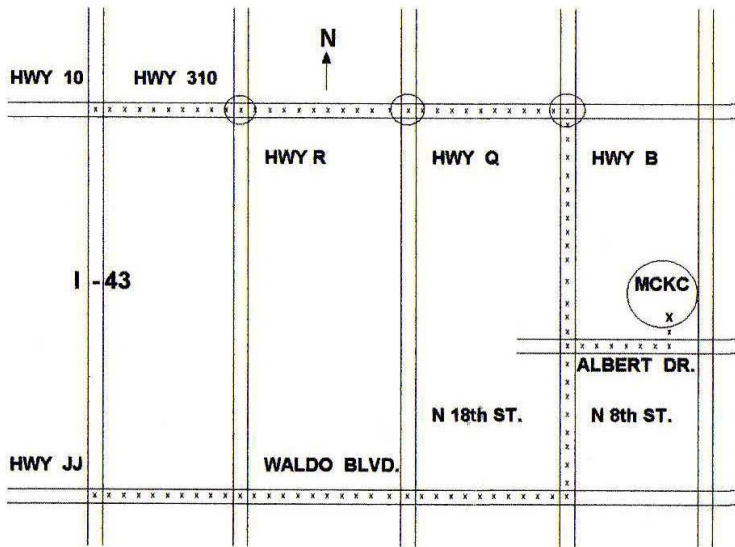

Motels

The following motels will accept well-behaved dogs with the owner assuming all responsibility. Reservations are subject to house rules of individual motels and may limit to size and require a deposit. Please do not allow your dog(s) to become a nuisance or leave them unattended in a room. Crates, clean up and courtesy are a must to maintain a responsible relationship with our motels.

Mention our club name and event and ask if a rate discount is available, or check online at www.hotels.com for discount rates.

Quality Inn of Manitowoc	2200 S. 44 th Street, Manitowoc WI 54220	920-683-0220
Holiday Inn	4601 Calumet Avenue, Manitowoc WI 54220	920-682-6000
Baymont Inn & Suites	101 N. Maritime Drive, Manitowoc WI 54220	920-682-7000
Lighthouse Inn	1515 Memorial Drive, Two Rivers WI 54241	920-793-4524
Harbor Town Inn	4004 Calumet Avenue, Manitowoc WI 54220	920-684-7841
Village Inn	3310 Memorial Drive, Two Rivers WI 54241	920-794-8818

Dogs may be moved up to a higher class at the request of the owner, as a result of qualifying for an agility title. However, written notice (regular mail or e-mail) must be given to the Trial Secretary **no later than 6:00 p.m. CDT on Monday, September 10, 2018**. **Day-to-day move ups will be allowed if received before the close of the Saturday trial** (award of ribbons for the last class of the day will be considered the close of the trial). Move-ups will be added to the end of the running order of the class they move up to and every effort will be made to accommodate handlers running multiple dogs in the same class.

No verbal changes will be accepted. Written requests must include the information listed below.

Please note that if you do request a move up from a **Novice A class to Open**, prior to the closing date of this trial, AKC regulations state any other class you may be entered in needs to be moved to the **Novice B class**. A dog which has been entered in Novice A, but is ineligible due to restrictions on the dog or handler, may be moved to Novice B **under the following conditions**: The request must be made in writing and presented to the trial secretary at least 30 minutes prior to the start of the trial **AND** the request must state the reason and justification for the move.

After the close of entries, a dog may be moved down in their class level (i.e., Master to Excellent). The request for the move to the class for which the dog is eligible must be in writing and submitted to the trial secretary at least 30 minutes prior to the start of the trial.

Fill out one form **per dog** and send to the Trial Secretary [mailed to standard (7821 Morrison Rd, Greenleaf WI 54126) or e-mail address (k9secretary@centurytel.net)]. Forms must be received by 6:00 p.m. CDT Monday, September 10, 2018. This change form is only for dogs whose entries have been accepted for the Manitowoc County Kennel Club agility trials on September 15-16, 2018.

AKC Registered Name: _____
 AKC Registration #: _____
 Breed/Variety: _____ Call Name: _____
 Owner(s): _____
 Height Division: 4" 8" 12" 16" 20" 24" 24 Choice"

Please Circle Appropriate Selections on **EACH** Line

Division:	Regular	or	Preferred	
Class:	Standard		JWW	
Day:	Saturday		Sunday	
Current Entry:	Nov A	Nov A or B	Open	Exc
Move To:	Nov B	Open	Exc	Master



American Kennel Club

OFFICIAL AMERICAN KENNEL CLUB AGILITY ENTRY FORM

Manitowoc County Kennel Club

Standard JWW Premier Std Premier JWW

Saturday, September 15, 2018

Sunday, September 16, 2018

Table with 4 columns for class types and 2 rows for dates.

Entry Fees: \$18.00 for 1st entry of a dog; \$17.00 each additional entry of same dog same day (includes AKC event service fees).

Entries are on a first received basis. Any entries received prior to the opening date and time will be returned.

Entries Open: Monday, July 2, 2018 - 8:00 A.M. CDT at the office of the trial secretary.

Entries Close: Friday, August 31, 2018 - 6:00 P.M. CDT at the office of the trial secretary. No phone, fax, or credit card entries will be accepted.

All express mail entries must have signature permitting receipt without recipient signature.

Make Checks and or Money Orders payable to: MCKC.

Mail entries with fees to: Kathy Dachlet; 7821 Morrison Road; Greenleaf, WI 54126. 920-864-2752

IMPORTANT: Carefully read instructions before filling out!

ENTRY FEE ENCLOSED

PLEASE PRINT CLEARLY

Choose Either Regular or Preferred Classes

\$

Check one jump height, and check class selections - Only one selection per class (both Master and Premier allowed)

Table with columns for Regular and Preferred classes and rows for Jump Height (STD, JWW, FAST, T2B).

Table for dog information: This dog needs to be measured (Yes/No), SEX, HEIGHT AT WITHERS, BREED, VARIETY, CALL NAME.

AKC® NAME (include AKC titles only)

Registration information: AKC NO., ILP NO., PAL NO., FOREIGN REG. NO. & COUNTRY, DATE OF BIRTH, PLACE OF BIRTH.

BREEDER

SIRE

DAM

ACTUAL OWNERS

OWNERS ADDRESS NEW ADDRESS

CITY STATE ZIP + 4

HANDLER ENTER JR. HANDLER # if applicable

Exhibitor or owner MUST sign on the signature line beneath the instructions.

AKC Rules, Regulations, Policies and Guidelines are available on the American Kennel Club Web site, www.akc.org

AGREEMENT

I certify that I am the actual owner of the dog, or that I am the duly authorized agent of the actual owner whose name I have entered. In consideration of the acceptance of this entry, I (we) agree to abide by the rules and regulations of The American Kennel Club in effect at the time of this event...

Additionally, I (we) hereby assume the sole responsibility for and agree to indemnify, defend and save the aforementioned parties harmless from any and all loss and expense (including legal fees) by reason of the liability imposed by law upon any of the aforementioned parties for damage because of bodily injuries, including death at any time resulting therefrom...

INSTRUCTIONS

Handlers whose dogs measure into the 8" through 20" regular jump height divisions may opt to enter in a higher or 24-choice height division for all Regular titling classes, but not in a division lower than their proper height division.

All dogs that have not been officially measured for an Agility Jump Height Card may still compete; however, they must be measured by a Judge of record, an Agility Field Representative, or a Volunteer Measuring Official, prior to running.

Dogs listed in the AKC Canine Partners ProgramSM may be eligible to enter all-breed AKC agility trials at the club's option. These dogs should be listed as All American Dog and must include their AKC number on the entry form and check the AKC No. box.

Junior Handlers should enter their Junior Handler Number on the front of this form. Should you not have your Junior Handler number, it may be obtained from the American Kennel Club (919) 233-9767.

SIGNATURE of owner or his agent duly authorized to make this entry.

SIGN HERE X

Telephone Number: _____

New Email

Email: _____

In Case of Emergency - Name: _____ Phone #: _____