



In association with
Craig W. Roland FAIA

Mary Winter
Developer

Rustic Shops and Apartments PRELIMINARY SITE PLAN

August 19, 2019

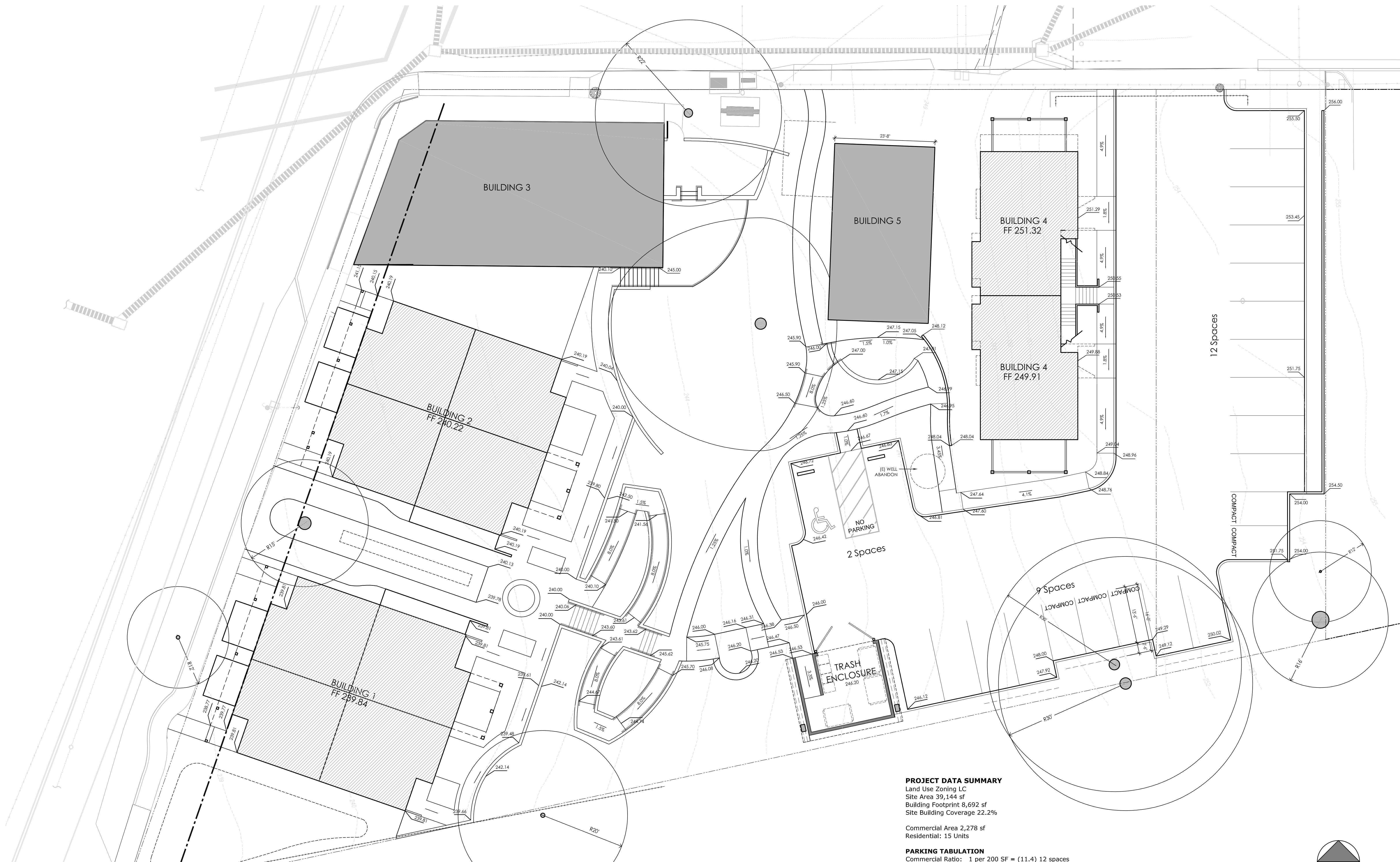

PROJECT DATA SUMMARY

Land Use Zoning LC
Site Area 39,144 sf
Building Footprint 8,692 sf
Site Building Coverage 22.2%

Commercial Area 2,278 sf
Residential: 15 Units

PARKING TABULATION

Commercial Ratio: 1 per 200 SF = (11.4) 12 spaces

Housing Ratio (Low Income Housing @ 20%)
1 space per Studio & 1-BR unit (13) = 13 spaces
2 spaces per 2-BR unit (2) = 4 spaces
TOTAL SPACES REQUIRED = 17 spaces

Residential Use most restrictive = 17 Spaces Required
23 Spaces Provided

Disabled Parking - 1 space provided
Compact Parking - 5 spaces provided (21.7%)
Bike Parking - 4 spaces required

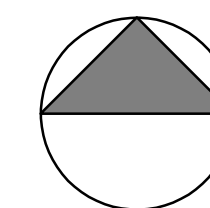

NORTH
0 5' 10'
SCALE: 1"=10'