



COMPRESSION SEAL EXPANSION JOINT SYSTEM

(IRC:SP:69:2005 & MORTH Interior specification)



KANTAFLEX (INDIAN) PRIVATE LIMITED

DESIGN OFFICE

#9,VASU STREET, II FLOOR,
KILPAUK, CHENNAI-600010

EMAIL: ram@kantaflex.in

Web www.kantaflex.in

FACTORY

B 52 (N) SIPCOT INDUSTRIAL COMPLEX
GUMMIDIPOONDI 601 2091 TAMIL NADU

MOBILE: 0 93810 42132 / 93810 41999

MAIL: kantaflex@yahoo.co.in

ELASTOMER UNIT

143/144 I.D.A PHASE V,
JEEDIMETLA, R.R. DISTRICT

HYDERABAD 500055 ANDHRA PRADESH

MAIL: kantachen@kantaflex.in

COMPRESSION SEAL JOINT SYSTEM

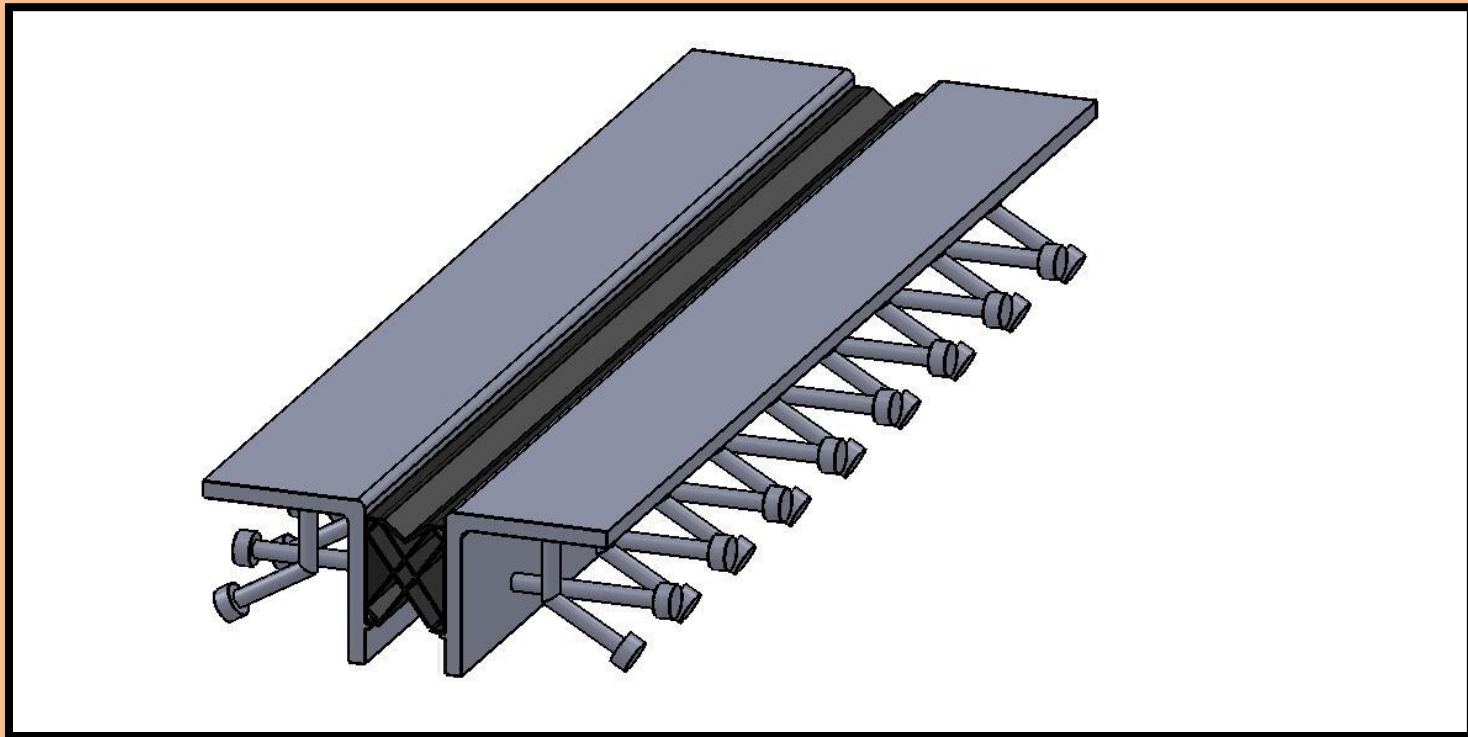

COMPRESSION SEAL EXPANSION JOINT SYSTEM

Material;

Edge beam 'L' angel – ASA 100X100X100 to IS : 2062

Anchorage system – 16Ø Anchor rods to IS 2062 @
250mm c/c.

Cross section area of bar @ one side : > 1600mm²

Ultimate Resistance : > 600kv

Note: All steel section shall be protected against
corrosion.

Chloroprene seal:

A long length seal suit for engine carriage way to
accommodate a horizontal movement up to 40mm and
Vertical movement of 3mm

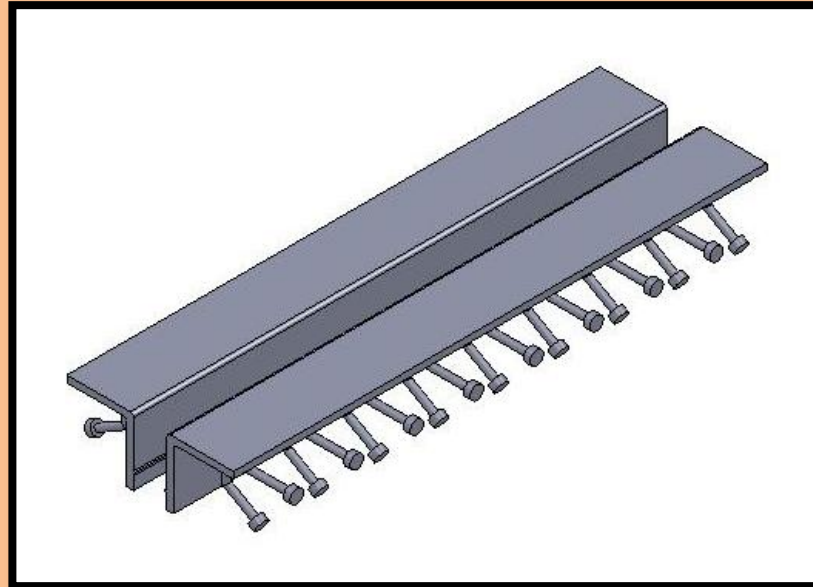

COMPRESSION SEAL INSTALLATION

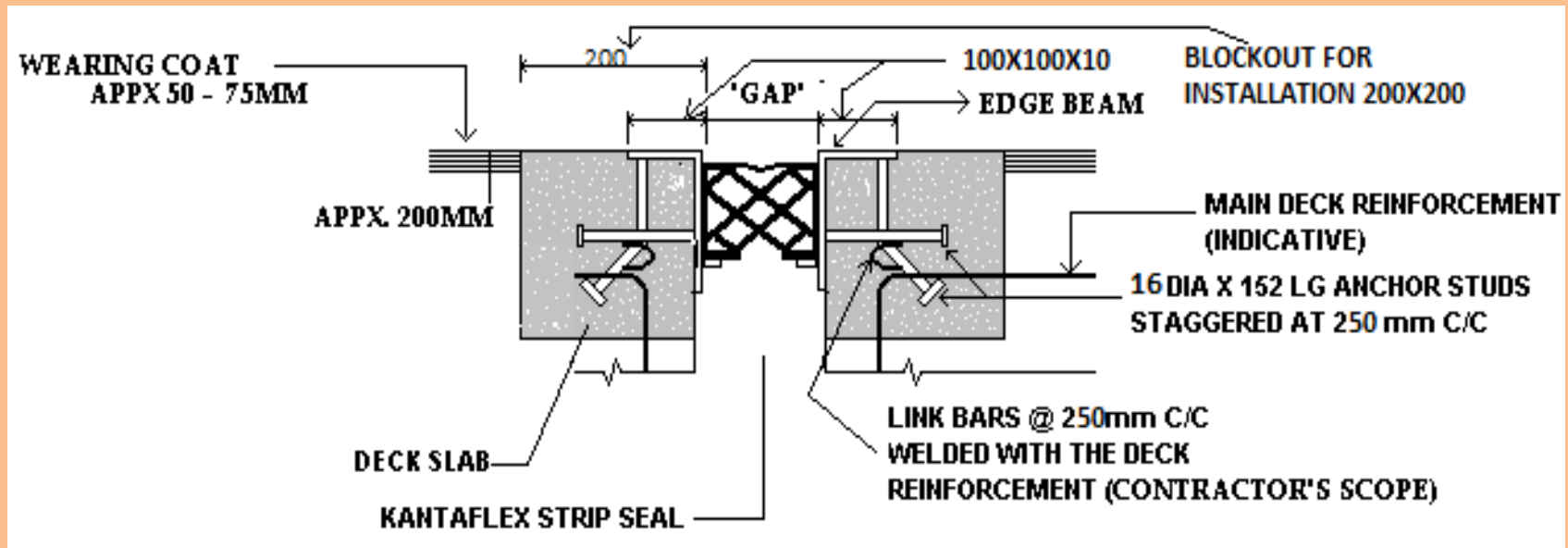

COMPRESSION SEAL



CHLOROPRENE STRIP SEAL

Conforms to clause 915.1 of IRC: 83 (Part II) and the properties of chloroprene shall conform to Table 2600-1 of MORTH Standard of Section 2600 (Fourth Revision).

INSTALLATION PROCEDURE



- The width of the gap to cater for movement due to thermal effect, free stress, shrinkage, and creep, super structure deformation and sub-structure deformation should be intimated to the manufacturer while releasing the order. Depending upon the temperature at which the joint is to be installed, the gap dimension shall be preset.
- The dimension of the recess in the decking shall be established in accordance with drawing or design data provided herein. The surface of the recess shall be thoroughly cleaned and all dirt and debris removed. The exposed reinforcement shall be suitable adjusted to permit

Un-obstructed lowering of the joint in to the recess.

- The recess shall be shuttered in such a way that the dimension in the joint drawing is maintained the formwork shall be tight. Prior to placing the joint the presetting shall be inspected. If the actual temperature of the structure is different from the temperature provided for presetting, correction of the presetting shall be done. After adjustment the bracket shall be tighten again.
- The joint shall be lowered in a predetermine position. Following placement of the joint in the prepared recess, the joint shall be level and finally aligned and the anchor loop of one side of the joint welded to the exposed reinforcement bars of the structure. Upon completion the same procedure shall be followed for other side of the joint. With the expansion joint finally held at both side, the auxiliary brackets shall be released, allowing the joint to take up the movement of the structure.

- The recess to be filled with high quality of concrete as same as the strength of the super structure, but not less than M35 grade after the concrete become cured the movable installation bracket in place shall Be removed.
- The Neoprene Seal shall be cut in to required length and inserted into the expansion gap by using the suitable device. To ensure proper fit of the seal the adhesive solution shall be applied. During the seal insertion care should be taken that there shall be no damage to the seal.
- As soon as the concrete in the recess become initial set, the sturdy ramp shall be placed over the joint to protect exposed steel beams and the neoprene seal from site traffic. Expansion joint shall not be exposed to the traffic loading before the carriage way surfacing is placed.
- The carriage way surfacing shall be completed with the top of the steel sections. The actual junction of the surfacing / wearing coat with the steel edge section shall be found by the wedge shaped joint with a sealing compound. The horizontal leg of the edge beam shall be cleaned before handed. It is important to ensure through and careful compaction of the surfacing in order to prevent any premature depression forming in it.