

- 1) Esquisser le rectangle capable de la vue de gauche.
- 2) Esquisser les différents détails sur les trois vues.
- 3) Faire la mise au net.
- 4) Repasser en couleur les arêtes repérées sur la perspective.

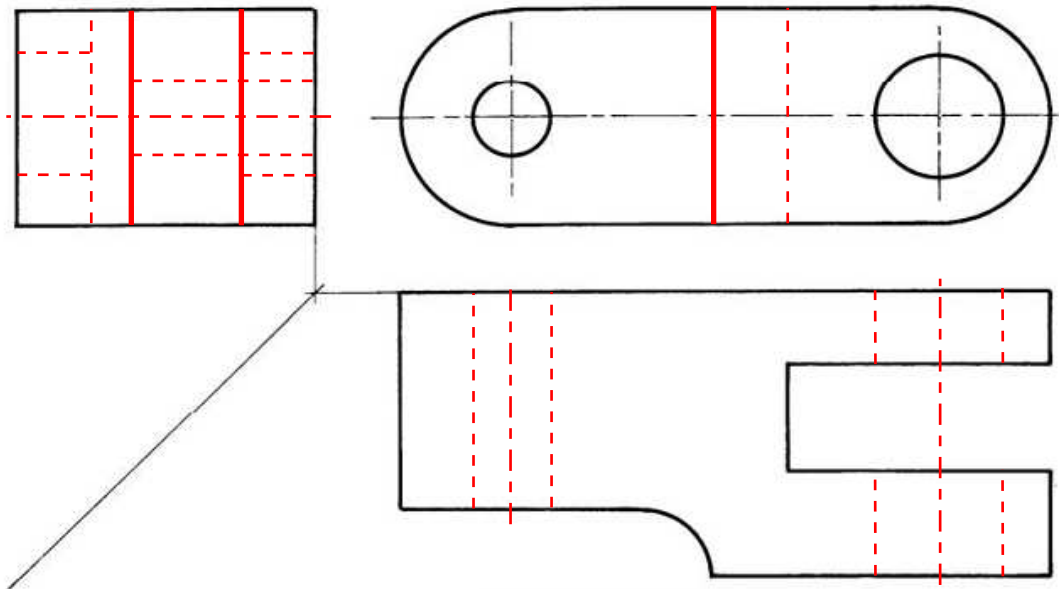

- 1) Esquisser les détails sur les trois vues.
- 2) Faire la mise au net.

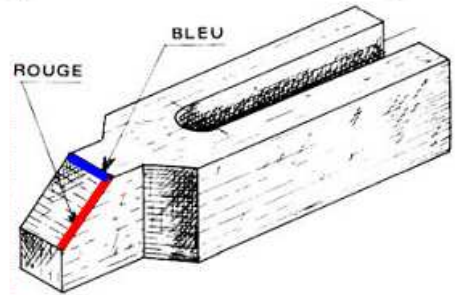

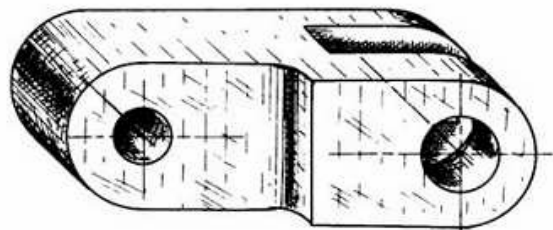
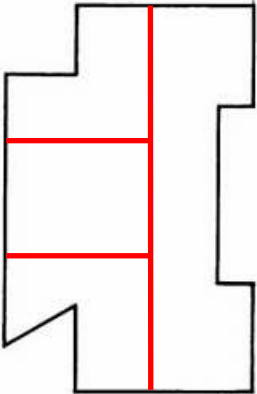
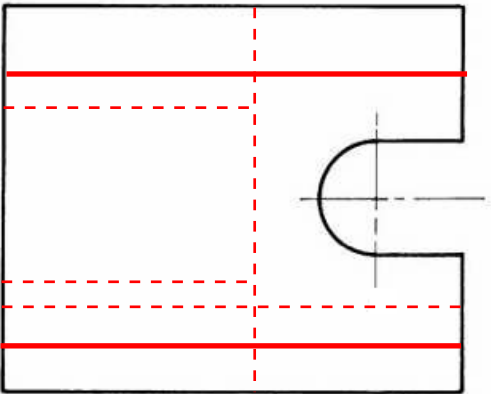
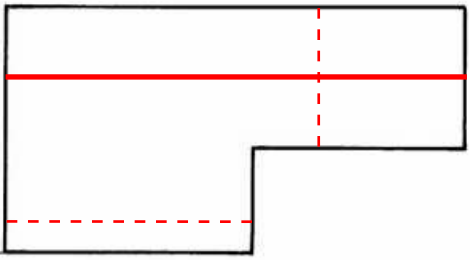
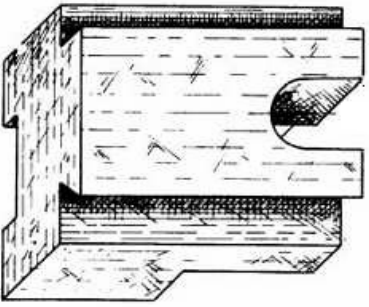

- 1) Esquisser les détails sur toutes les vues.
- 2) Faire la mise au net.

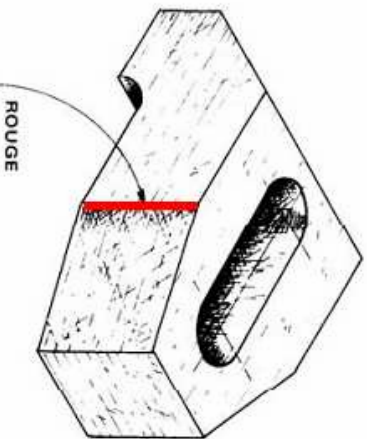
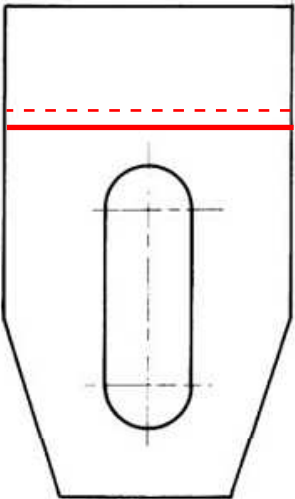
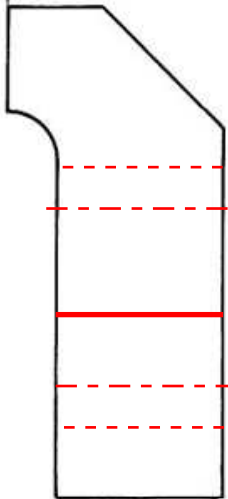
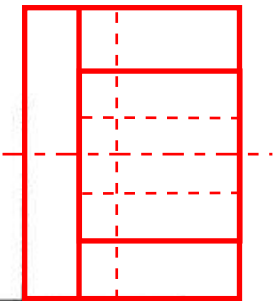

- 1) Esquisser le rectangle capable de la vue de droite.
- 2) Esquisser les détails sur toutes les vues.
- 3) Faire la mise au net.
- 4) Repasser en couleur l'arête repérée sur la perspective.

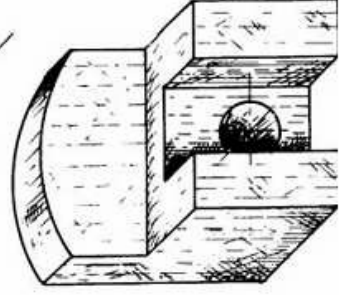
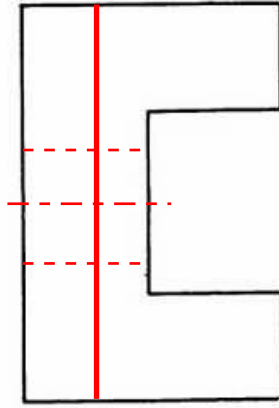
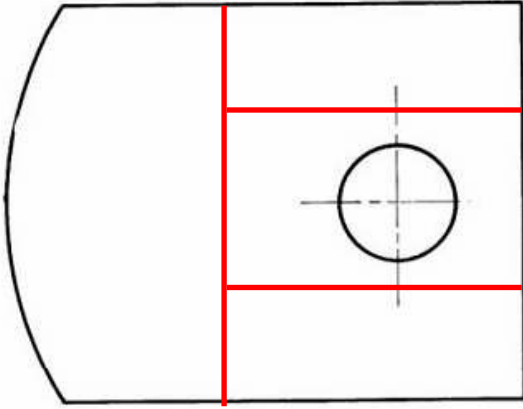
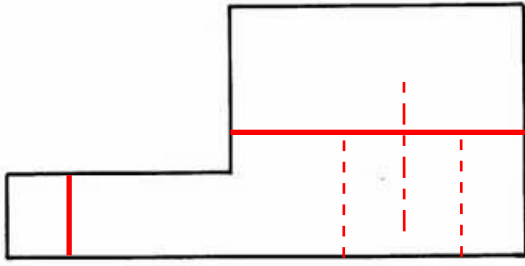

- 1) Esquisser les détails sur toutes les vues.
- 2) Faire la mise au net.

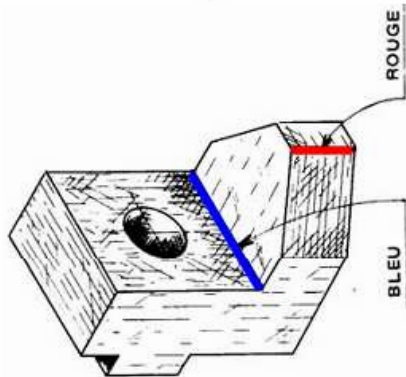
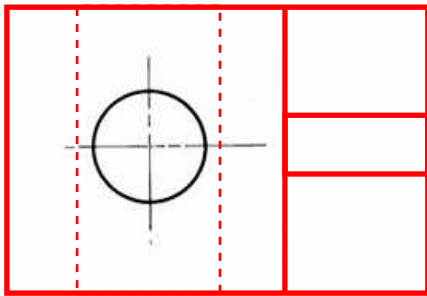
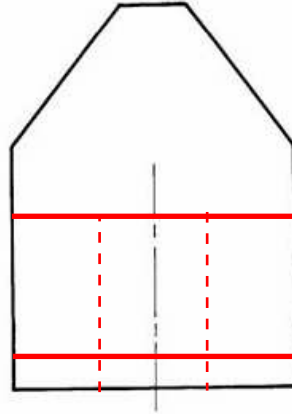
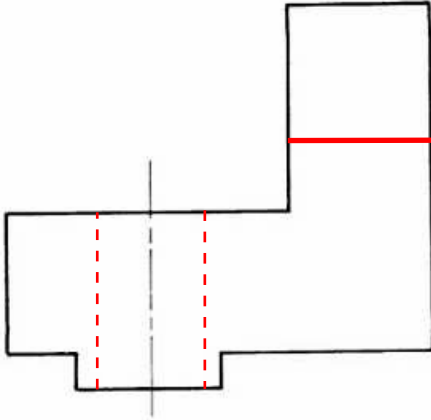

- 1) Esquisser le rectangle capable de la vue de droite.
- 2) Esquisser les différents détails sur les trois vues.
- 3) Faire la mise au net.
- 4) Repasser en couleur les arêtes repérées sur la perspective.