

REPUBLIC PRODUCTS

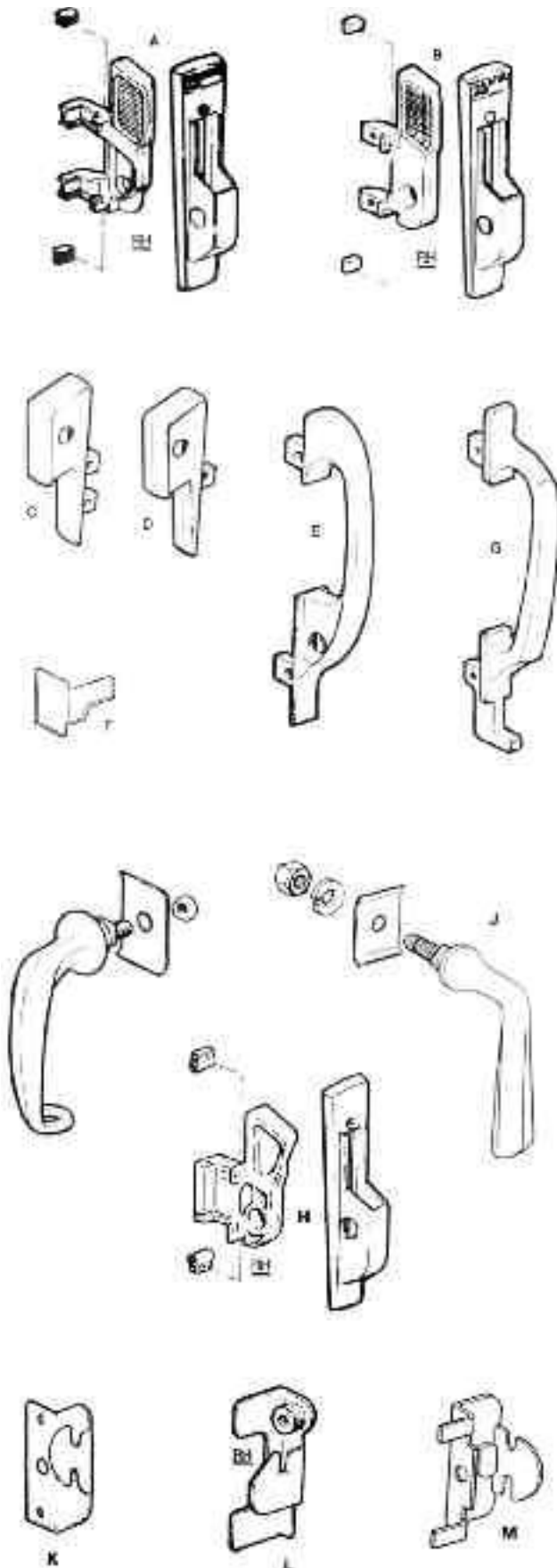

Republic Products

- A. #70101 (R. H.) / Locker Handle
#70102 (L. H.)
- #70103 (R. H.) / Handle Lift ONLY
#70104 (L. H.)
- #70105 Handle Case ONLY
- B. #70107 (R. H.) / Locker Handle
#70108 (L. H.)
- #70109 (R. H.) / Locker Handle
#70110 (L. H.)
- C. #70111 Locker Handle
- D. #70113 Locker Handle
- E. #70115 Locker Handle
- F. #70701 Padlock Stop
- G. #70117 Locker Handle
- H. #70119 (R. H.) / Low Decibel Locker Handle
#70120 (L. H.)
- #70121 (R. H.) / Handle Lift ONLY
#70122 (L. H.)
- #70105 Handle Case ONLY
- I. #70123 Expanded Metal Locker Handle
- J. #70131 Handle for Shelving Doors
- K. #70301 Frame Hook
- L. #70303 (R. H.) / Frame Hook
#70304 (L. H.)
- M. #70305 Frame Hook

REPUBLIC PRODUCTS

Republic Products

- A. #71501 Spring Latch for Lock Bar
- B. #70501 Lock Bar Latch Finger
- C. #71503 Lock Bar Latch Finger Spring
- D. #72007 Tube Rivet for Lock Bar
- E. #71101 Hinge
- F. #70703 Box Locker Escutcheon Plate
- G. #70705 Box Locker Friction Catch
- H. #70307 Box Locker Frame Hook
- I. #70503 1-Point Latch Handle
- J. #71505 1-Point Latch Spring
- K. #71701 1-Point Latch Washer
- L. #72009 1-Point Latch Stud
- M. #71301 1-Point Latch Bumper
- N. #70504 1-Point Latch Attachment Bracket
- O. #70505 Top Cam For Double Door Locker
- P. #70506 Bottom Cam For Double Door Locker
- Q. #71507 Top Spring For Double Door Locker
- R. #71508 Bottom Spring For Double Door Locker
- S. #72011 Stud for D. D. Locker
- T. #71303 Frame Bumper for D. D. Locker
- U. #78001 Number Plate
- V. #78003 Number Plate
- W. #71001 (R. H.) / #71002 (L. H.) Single Prong Wall Hook
- X. #71003 Double Prong Wall Hook
- Y. #71005 Coat Rod Bracket for Wall Hook
- Z. #77700 Handle Assembly for Storage Cabinet - includes lock rods

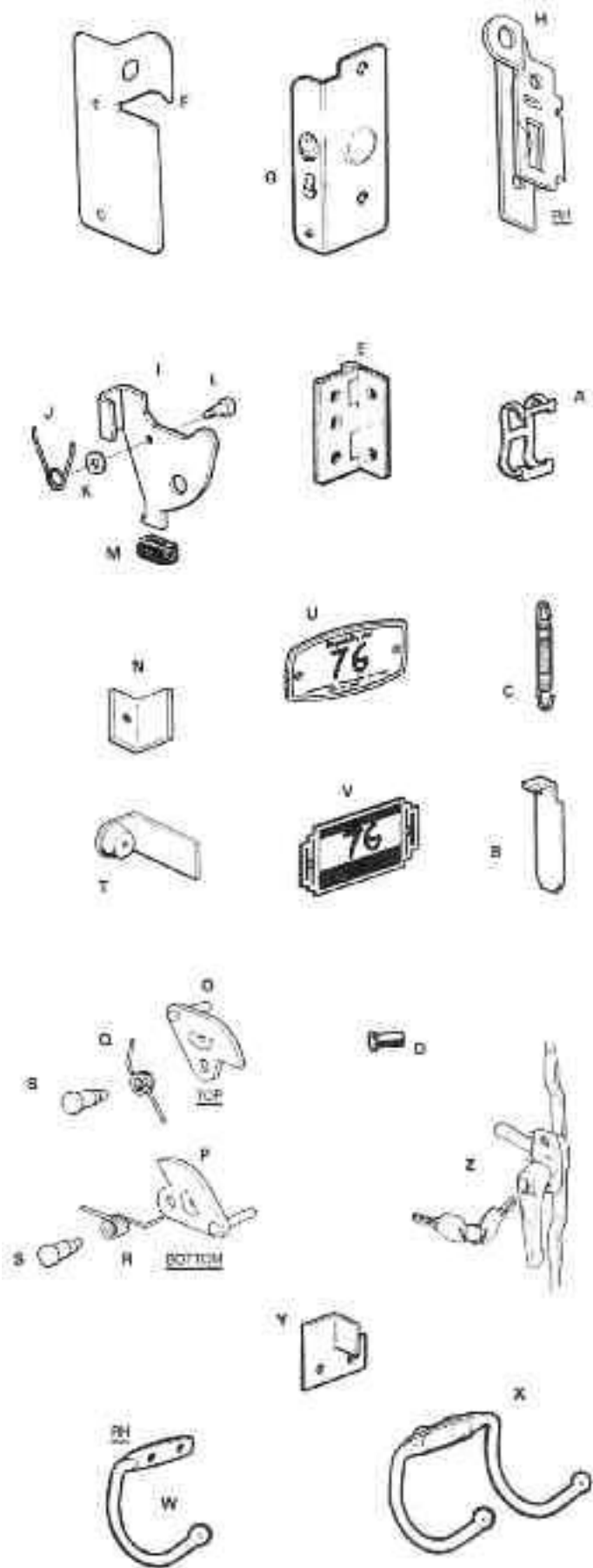

REPUBLIC Door & Frame and Body Parts are available — please see us for these. Replacement Lock Bars are also available.