

AVAILABLE: ADJACENT TO SMART AND FINAL EXTRA:

9,330-18,660sf

8200 CAMINO REAL | ATASCADERO, CA



PROPERTY DESCRIPTION

Center includes smaller retailers and services such as: Lee's nails, Pizza Express, Advance America Cash Advance, Fantastic Sam's, and John's Video Palace.

Nearby tenants include: Food 4 Less, CVS, Walgreens, and Chase Bank.

Lease Rate: Front Space \$9.50/ft, Rear Space \$7.80/sf, NNN - \$0.39

Building Size: **Approx. 9,330-18,660sf. Can be expanded to 22,000sf.**

Lot Size: Approx. 6.1 Acres

Ingress & 3 access points: 1 on Curbaril with right turn in and right turn out, 1 signalized, and 1 with right and left in and out access on El Camino Real.

APN: 056-031-062

Parking: Shared

Signage: Front fascia and Possible Rear and Side Building Signage

Loading: Side Loading from Behind

Available: Now



All information furnished regarding property for sale, rental or financing is from sources deemed reliable, but no warranty or representation is made to the accuracy thereof and same is submitted to errors, omissions, change of price, rental or other conditions prior to sale, lease or financing or withdrawal without notice. GPS Commercial Real Estate Services Inc.

BROKER: Pamela Scott | LICENSE #00705034 | pscott@gpscre.com | 805.560.0040 | CELL - 805.729.1706 | 132 Garden Street Box 10 Ste. 5F Santa Barbara, CA 93101 | Mailing Address: PO Box 4412, Santa Barbara CA 93140

SUBLEASE AVAILABALE: ADJACENT TO SMART & FINAL

8200 EL CAMINO REAL | ATASCADERO, CA

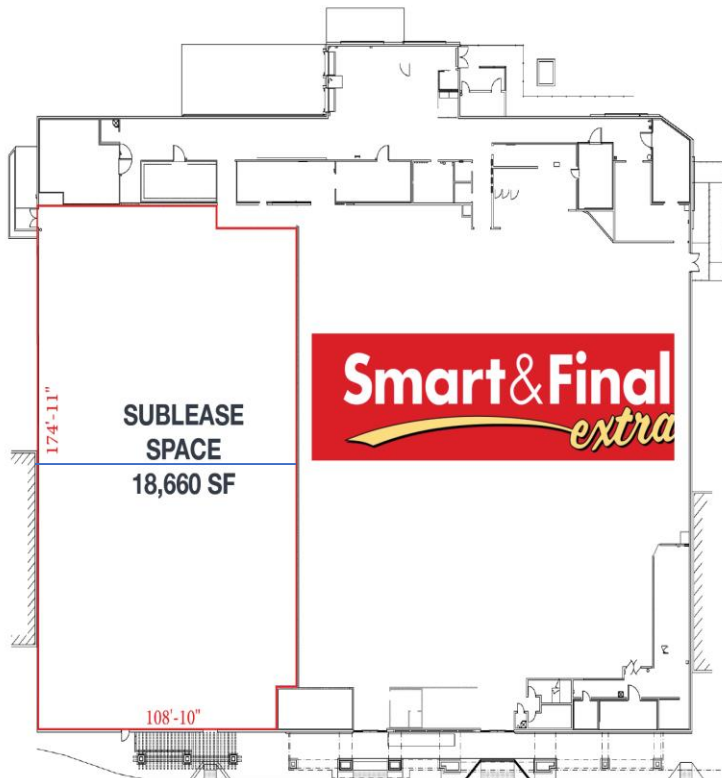

2015 DEMOGRAPHICS

	1 Mile	3 Mile	5 Mile
Population	8,672	26,356	33,212
Households	2,998	10,055	12,570
Income	\$59,516	\$62,826	\$66,928

All information furnished regarding property for sale, rental or financing is from sources deemed reliable, but no warranty or representation is made to the accuracy thereof and same is submitted to errors, omissions, change of price, rental or other conditions prior to sale, lease or financing or withdrawal without notice. GPS Commercial Real Estate Services Inc.